

INSTALLATION

G U I D E

SEAWALL FAUCET
AND PERSONAL
SHOWER SYSTEM

THE BOLD LOOK
OF **KOHLER**®

TABLE OF CONTENTS

INTRODUCTION	2	INSTALL AND SOLDER TRANSFER VALVE	9
RECOMMENDED TOOLS AND MATERIALS	2	Pre-Solder Checklist	9
BEFORE YOU BEGIN	3	INSTALL AND SOLDER CONNECTIONS	10
COMPONENT LAYOUT	4	BATH/WHIRLPOOL INSTALLATION	11
UNPACKING HANDLES	4	SOLDER REMAINING CONNECTIONS	11
Neville Handles	4	THREE-WAY TO TWO-WAY CONVERSION	11
Alterna Handles	4	HANDSHOWER INSTALLATION	13
Pillows Handles	5	WATER CHECK/FLUSH	14
Cirrus Handles	5	TRANSFER VALVE TRIM INSTALLATION	14
PRE-SOLDERING INSTALLATION SEQUENCE	5	HANDLE INSTALLATION	15
For K-1398 Only	5	SPOUT INSTALLATION	16
For All Installations	6	TROUBLESHOOTING	17
For K-1398 Only	6	Transfer Valve	17
For K-868 and K-870 Only	6	Sheetflow	18
For All Installations Continued	6		
SPOUT SLEEVE INSTALLATION	6		
VALVE/ESCUTCHEON INSTALLATION	7		
SPRAY HOSE GUIDE INSTALLATION	8		
For Pillows	8		
For Neville, Alterna, and Cirrus	8		

INTRODUCTION

Please read these instructions carefully to familiarize yourself with the required tools, materials, and installation sequences. Follow the sections that pertain to your particular installation. This will help you avoid costly mistakes. In addition to proper installation, read all operating and safety instructions.

All information in these instructions is based on the latest product information available at the time of publication. Kohler Co. reserves the right to make changes in product characteristics, packaging, or availability at any time without notice.

Please leave these instructions for the consumer.

RECOMMENDED TOOLS AND MATERIALS



Plus:

Support blocks and/or straps

Additional plumbing hardware such as elbows and/or tubing

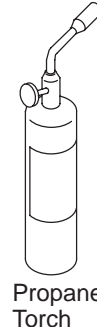
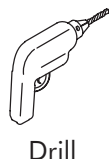
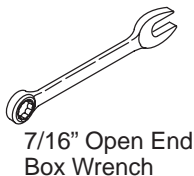

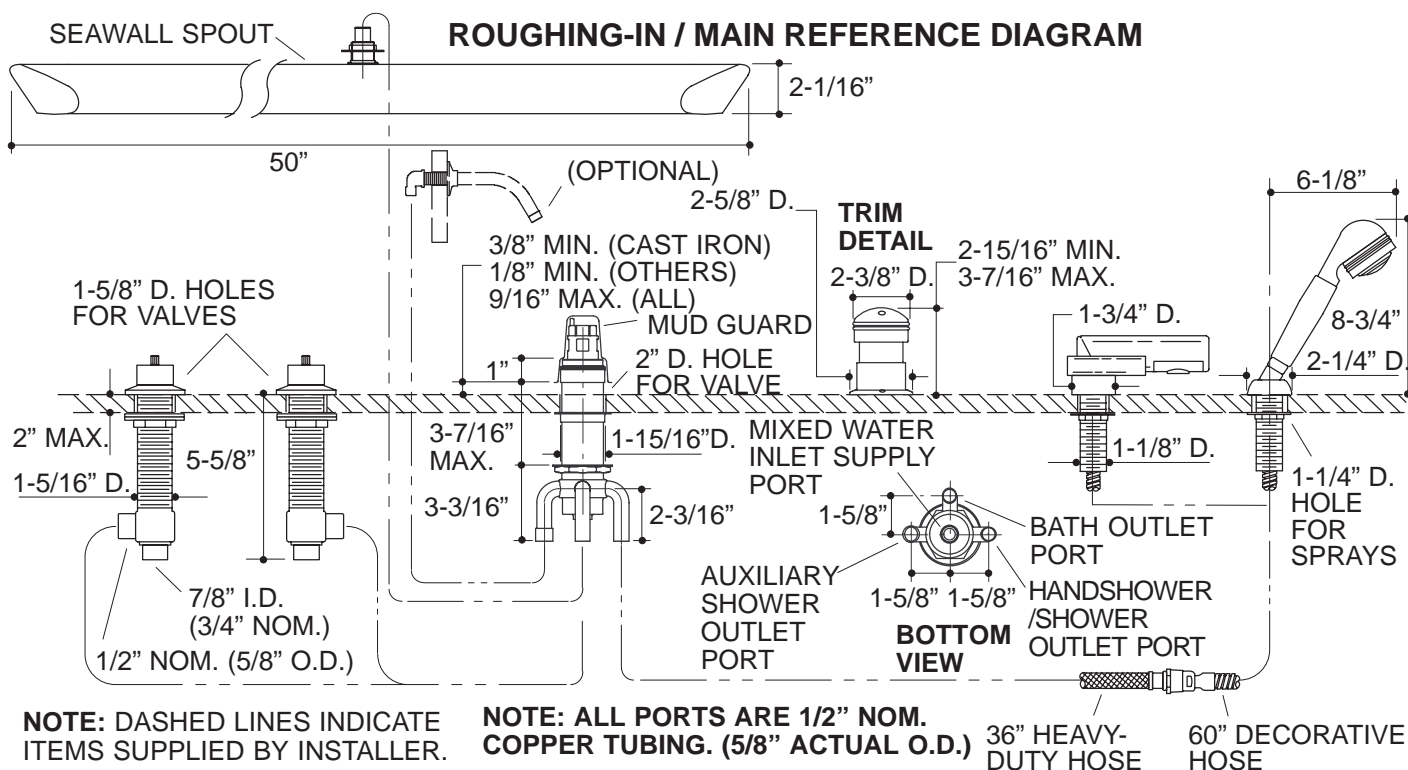

18

BEFORE YOU BEGIN

- Observe all local plumbing codes.
- Advance planning before installation is crucial. Carefully read entire instructions before beginning installation. The illustrations do not show all configurations. Check for elbows and tubing needed. Dry fit assemblies before soldering.
- Use only with K-868 bath, K-870 whirlpool or K-1398 whirlpool. Not for use with other baths or whirlpools.
- Faucet must be installed to bath/whirlpool prior to installing bath/whirlpool.
- Provide an access panel for the transfer valve. Access to the valves and handshower is recommended.
- Install water hammer arresters in the supply line.
- Deck width from bath rim must be 2" min. to allow clearance for fittings.
- Kohler Co. recommends using hard-drawn tubing (type M, K, or L) from the valves to the transfer valve to the spout.
- Kohler Co. recommends soldering all connections from the transfer valve to the spout, and from the transfer valve to the hot and cold valves. To avoid potential leakage below the rim, do not use flexible hose connections.
- These installation instructions lead up to, but do not include, wall shower arm installation.
- Backflow protection for the Seawall spout, hand shower, and wall shower is provided by the vacuum breaker integral in the 3-way transfer valve.
- Installer-supplied copper tubing to be: 1/2" nominal (5/8" O.D.) for outlets; and 3/4" nominal (7/8" O.D.) for inlets.

1. COMPONENT LAYOUT

Verify the location of the components and the orientation of all ports.

Decide in advance on the location and orientation of the transfer valve. The location of the bath spout, handshower, and optional auxiliary shower will affect the piping and connectors needed.

Allow clearance for valve outlets, handles, Seawall spout, and handshower hoses.

The distance between the transfer valve and the braided hose connection can be extended with 1/2" copper piping below the rim, but may not be safe or practical. A long run of piping will mean a long run of room-temperature standing water when the handshower is first activated for use.

Long runs of piping should be secured to the underside of the deck/rim. If the piping cannot be secured at a point near the transfer valve, secure the transfer valve from underneath with blocking lumber or other suitable support.

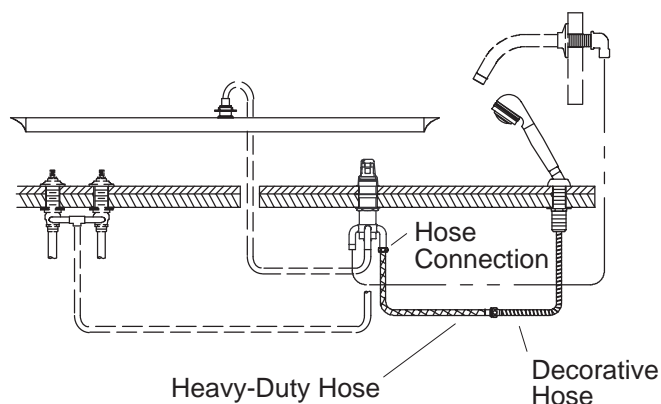

2. UNPACKING HANDLES

Some handles are shipped preassembled. If your handle type is preassembled, the handles must be disassembled for installation.

NEUVILLE HANDLES:

Neuville handles are shipped unassembled.

ALTERNA HANDLES:

To retain finish integrity, remove the outer shell from the handle skirt assembly and set it aside until installation is complete. The outer shell threads onto the handle skirt assembly. The inset may be packed separately.

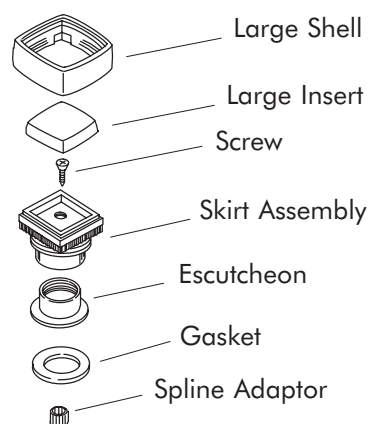

PILLOWS HANDLES:

The handle is threaded onto the sleeve. Grip the sleeve and turn the handle counterclockwise to remove. The attaching screw will be exposed. Remember that there is a lock washer on this screw.

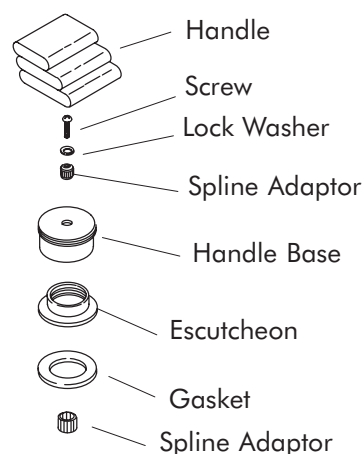

CIRRUS HANDLES:

The handle knob fits onto the valve spline. Pull it straight up to separate.

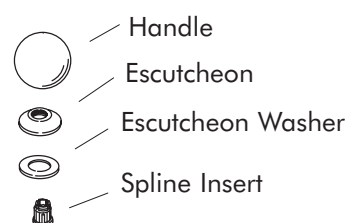

3. PRE-SOLDERING INSTALLATION SEQUENCE

FOR K-1398 ONLY:

NOTE: If installing with K-868 or K-870, proceed to next heading, "For All Installations".

CAUTION: Risk of personal injury or product damage. Wear safety goggles when marking, prick punching, and drilling holes. Use sharp bits and maintain the proper drill motor speeds relative to hole diameters.

NOTE: Tape templates into place to simplify procedure.

Using Template #1, mark and drill the following holes on the bath rim (drain side):

- Valve holes (2) 1-1/2" DIA.

Using Template #2, mark and drill the following holes on the bath rim (drain side):

- Transfer valve hole (1) 2" DIA.
- Hose guide hole (1) 1-1/4" DIA.

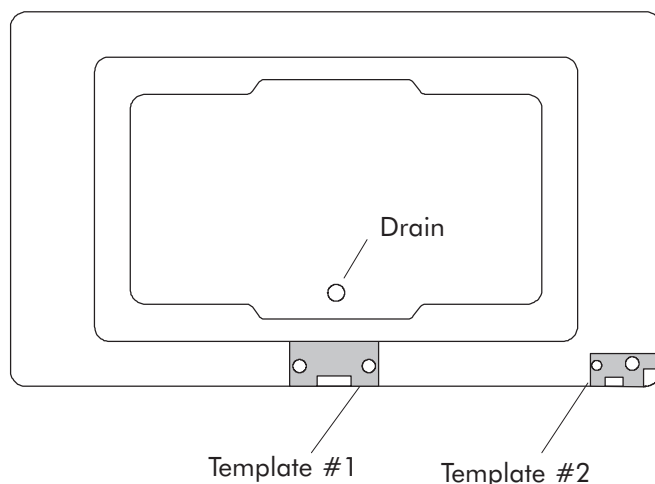

Use Template #3 to locate pilot holes for the spout sleeve and fasteners as described below.

NOTE: Do not locate template lower than 3" down from bench.

Mark the centerline of the bath on the bath wall opposite the drain side. Using metal template #3, mark spout sleeve hole location on the centerline of the bath wall at 3" down from bench.

Mark fastener hole locations. Drill 1/8" pilot holes at all five locations. Refer to hardware assembly kit to determine if your fastener type is rubber or steel. Then drill to the following hole sizes:

- Spout sleeve (1) 1-3/8" DIA.
- Rubber spout wall fastener holes (4) 1/2" DIA., **or** Steel spout wall fastener holes (4) 3/8" DIA.

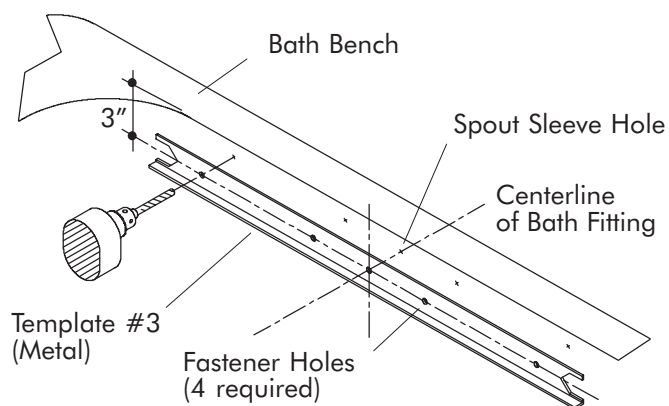

FOR ALL INSTALLATIONS:

Verify the fit of the spout tube and spout sleeve to the holes on the bath wall.

For K-1398 Only:

Thread rubber fasteners, supplied in hardware kit, to tube assembly; or, install steel fasteners into bath wall. Place gasket over spout sleeve. Temporarily place sleeve through hole in bath. Secure loosely with retaining nut. Align spout tube assembly with holes in bath.

For K-868 and K-870 Only:

Fasteners are preinstalled in the bath wall. Place gasket over spout sleeve. Temporarily place sleeve fitting through hole in bath. Secure loosely with retaining nut. Align spout tube assembly with fastener holes in bath.

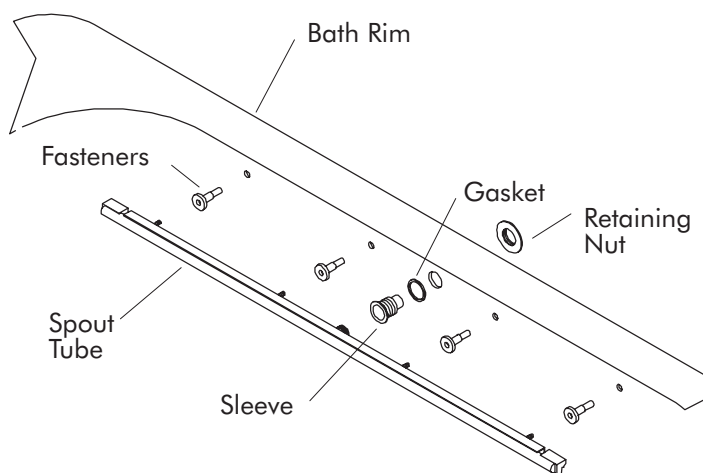

FOR ALL INSTALLATIONS CONTINUED:

Once proper fit is assured, put the spout tube back into its package for protection. Store the rubber fasteners. Disassemble the spout sleeve fitting from the bath prior to soldering.

4. SPOUT SLEEVE INSTALLATION

Determine what coupling will be required to solder to sleeve. Allow adequate clearance away from bath wall and any framing for soldering the final connection after bath is moved into place.

Solder coupling to sleeve. Allow assembly to cool prior to installing it to bath wall.

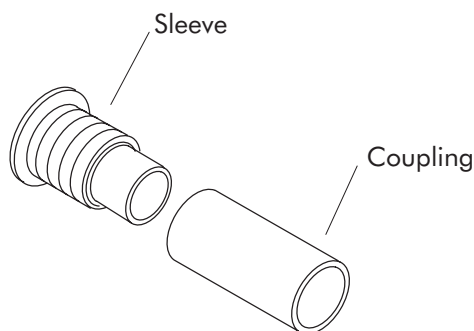

After sleeve assembly has cooled, place gasket over sleeve assembly.

Apply bead of sealant to back of sleeve and around back of hole in bath wall.

Slide sleeve assembly through bath wall.

Slide rubber and fiber washers over sleeve. Secure with retaining nut.

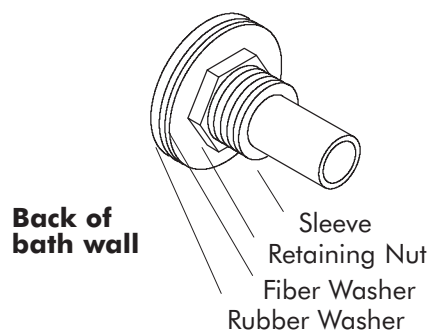

5. VALVE/ESCUTCHEON INSTALLATION

Thread a mounting nut onto each valve body with flange side facing upward. Slide on a fiber washer and a rubber washer.

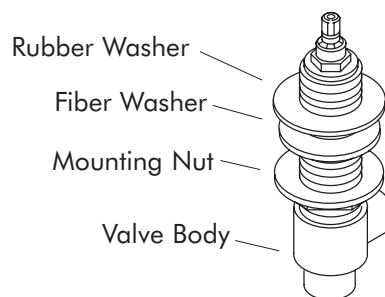

NOTE: Orient the valve body marked “COLD” so it is on the right when you are facing the front of the faucet.

Insert the valve bodies through the mounting holes from the bottom of the deck or rim.

*Thread a collar onto each valve body with the flange side facing upward.

Adjust it so the distance from the top of the deck or rim to the top of the valve stem is 1-13/16”.

***NOTE: (Cirrus Round Handles Only)** The collar illustrated and 1-13/16” dimension are not usable for Cirrus Round handles. Instead, thread escutcheon on each valve and adjust to allow 1/32” clearance between escutcheon and handle. Orient valve body so ports are properly aligned.

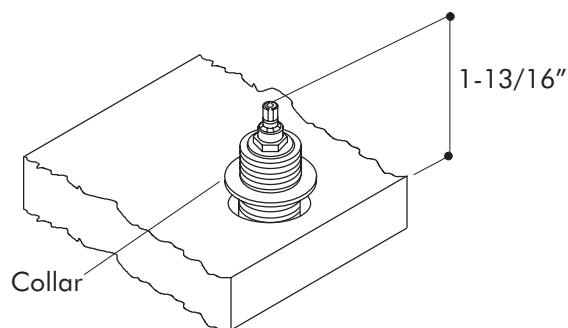

Cirrus Round Only

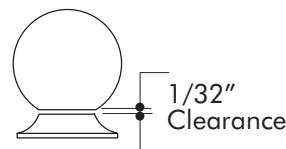

Tighten mounting nut on each valve body underneath deck or rim.

Remove handles, repackage, and put in a safe place.

Cover escutcheons and valving to protect during construction.

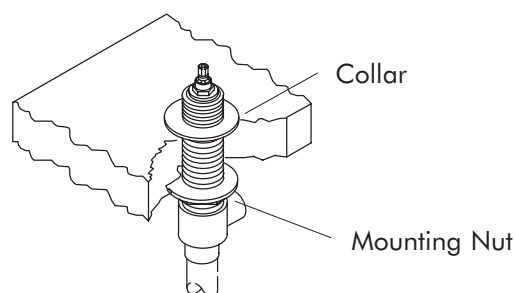

6. SPRAY HOSE GUIDE INSTALLATION

FOR PILLOWS:

Thread the shank into the hose guide.

Apply a bead of plumbers putty or other sealant around the bottom edge of the hose guide according to the putty manufacturer's instructions.

Place the hose guide down into its mounting hole on the rim. From the underside, thread the shank nut onto the shank.

Align the hose guide so that the handshower will be oriented to the inside of the bath.

Tighten the shank nut firmly.

Remove any excess putty.

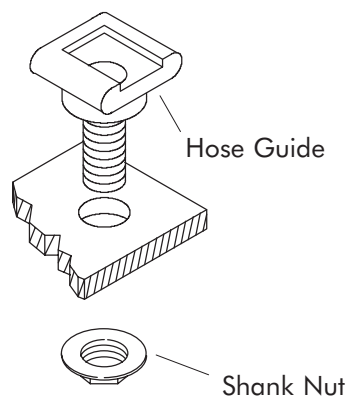

FOR NEUVILLE, ALTERNA, AND CIRRUS:

Set the washer over the top of the shank.

Thread the hose guide escutcheon onto the top of the shank. From the underside, thread the shank nut onto the shank, and tighten it securely.

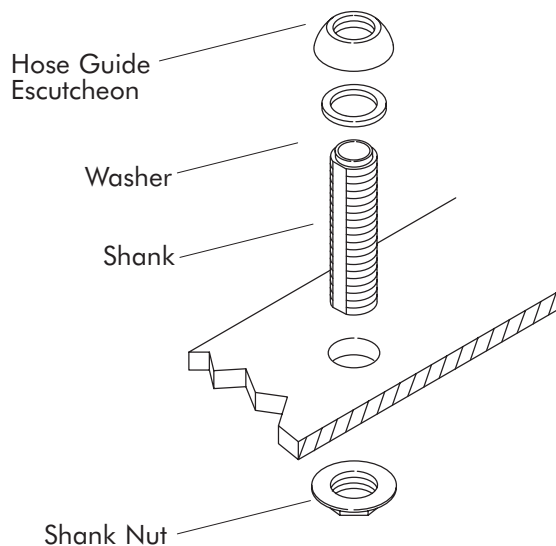

7. INSTALL AND SOLDER TRANSFER VALVE

PRE-SOLDER CHECKLIST:

CAUTION: Risk of product damage. Observe the following before doing any soldering:

- All handles should still be removed.
- Do not connect the flexible hand shower hose until soldering is complete and the tubing has cooled.

IMPORTANT: Do not apply excessive heat while soldering.

IMPORTANT: Direct the torch flame away from the brass body of the transfer valve.

IMPORTANT: Only apply direct heat to the transfer valve connectors and extensions.

IMPORTANT: If there is limited access to the transfer valve solder connections, or if any other risk of excessive heat being applied to the brass body exists, remove the cartridge prior to soldering. If you remove the cartridge, protect the seals and O-rings from becoming dirty, damaged, or misaligned.

If the transfer valve is to be used in a two-way configuration, solder a cap to the auxiliary outlet.

Solder the inlet and outlet connectors and extensions. Solder the 1/2" male adapter (supplied) to the handshower outlet port.

Remove the mud guard and plated nut from the valve. Do not remove the cartridge.

Remove the collar from the brass body.

Thread the mounting nut completely down the brass body.

Position the washer on the mounting nut.

For Cast Iron Baths: Fit the valve up through the rim, and thread the collar partially onto the brass body with the flange down. Handtighten the plated nut onto the brass body.

Reinstall the mud guard.

Position the collar to create a gap of between 3/8" and 9/16" between the finished deck and the bottom of the mud guard.

Securely tighten the mounting nut.

For All Other Baths: Fit the valve up through the rim, and thread the collar partially onto the brass body with the flange up. Handtighten the plated nut onto the brass body.

Reinstall the mud guard.

Position the collar to create a gap of between 1/8" and 9/16" between the finished deck and the bottom of the mud guard.

Securely tighten the mounting nut.

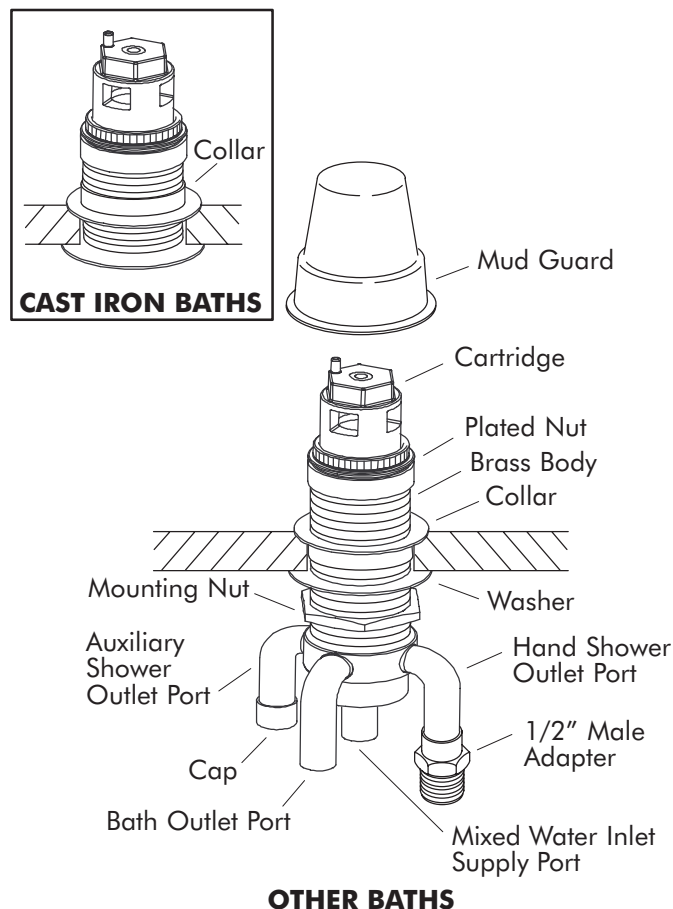

8. INSTALL AND SOLDER CONNECTIONS

Install the wall shower (if applicable) before installing the whirlpool bath.

Provide an access panel for all installations.

NOTE: Dry fit all plumbing and connections before soldering. Soldering is recommended because it is permanent and less apt to fail.

NOTE: When compression joints are used, Kohler Co. recommends an assembly torque of 45 – 60 foot pounds for compression nuts. To produce the required torque with hard drawn tubing, from handtight, approximately 1/2 of a turn is needed.

CAUTION: Risk of product damage. Protect the backside of the bath from excessive heat when soldering. Damage caused by excessive heat is not covered by the warranty.

If the installation includes a wall-mount shower, stub out the shower inlet in advance to facilitate connection to the transfer valve after the bath/whirlpool is installed.

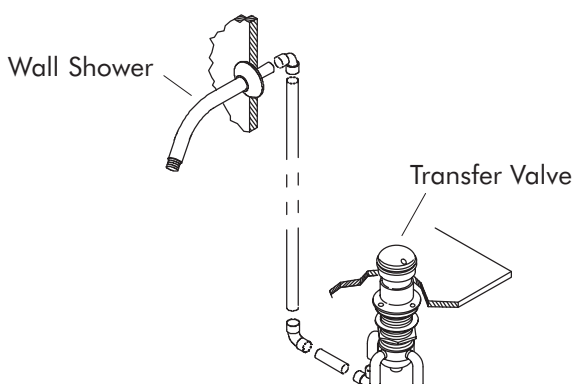

Solder the piping between the hot and cold valves and the transfer valve. Do not run mixed water supply line directly below handshower guide.

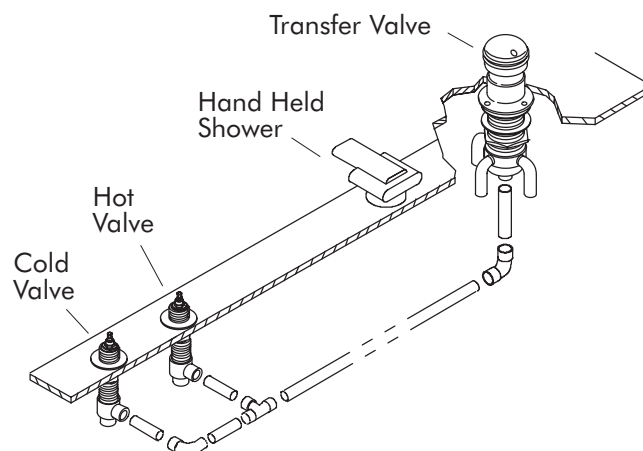

9. BATH/WHIRLPOOL INSTALLATION

Cover all escutcheons, the handshower guide, and the transfer valve.

Install the bath/whirlpool according to the installation instructions packed with it.

Do not install finish wall material until final connections are made and water tested.

10. SOLDER REMAINING CONNECTIONS

CAUTION: Risk of product damage. Protect the backside of the bath from excessive heat when soldering. Damage caused by excessive heat is not covered by the warranty.

Make solder connections between the transfer valve and spout inlet, valves and supply inlets, and wall shower and transfer valve (if applicable).

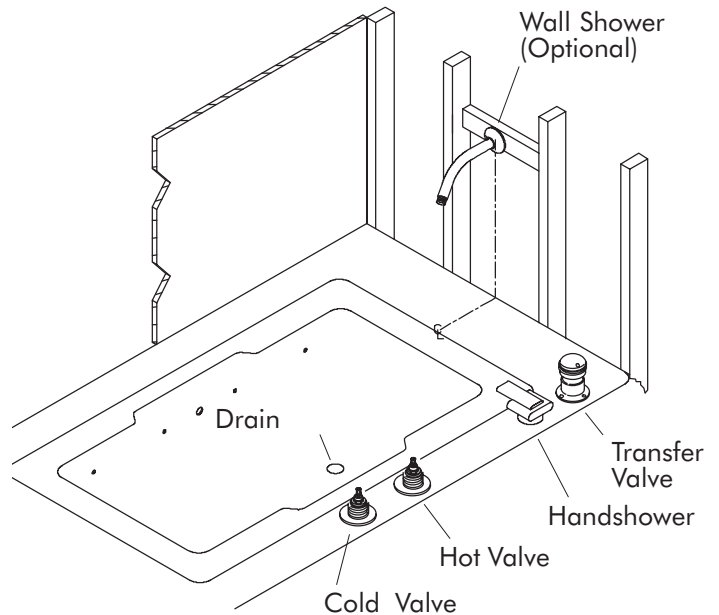

11. THREE-WAY TO TWO-WAY CONVERSION

If your installation includes a wall-mount shower and a handshower, continue to the next step, "Handshower Installation".

If your installation does not include a wall-mount shower, proceed as follows:

Remove the plated nut from the transfer valve.

Carefully pull the cartridge from the brass body. Use care to prevent the cartridge seals and O-rings from falling off, or becoming dirty or damaged.

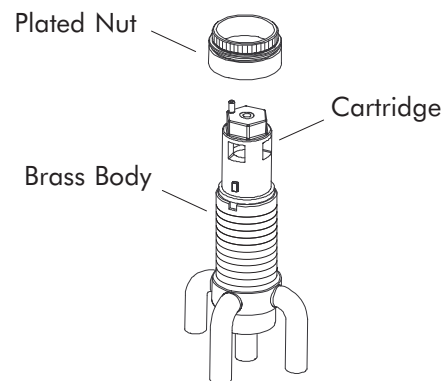

Line up the transfer tube stop with the slot in the grey collar.

Use a thin-bladed screwdriver to carefully pry the two locking tabs loose from the transfer tube. **Remove and discard the grey three-way stop collar.**

Verify that the transfer tube hole lines up with the large port in the cartridge, as shown.

Align the black collar on the transfer tube so the collar tab lines up with the large port. Snap the collar in place so both locking tabs are fully engaged.

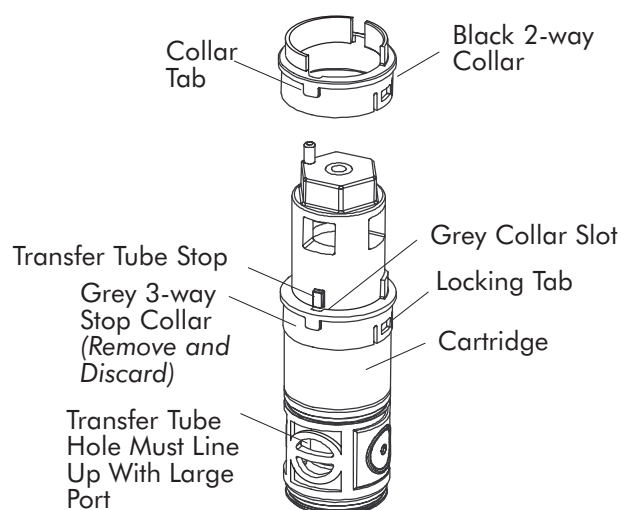

Inspect the seals and O-rings for damage and correct fit. Adjust them as needed.

Carefully work the cartridge into the brass body so the collar tab fits fully into the notch in the brass body.

Handtighten the plated nut to the brass body.

CAUTION: Risk of property damage. When installed in a two-way configuration, the auxiliary outlet must be capped off to prevent possible leakage out of the unused auxiliary outlet.

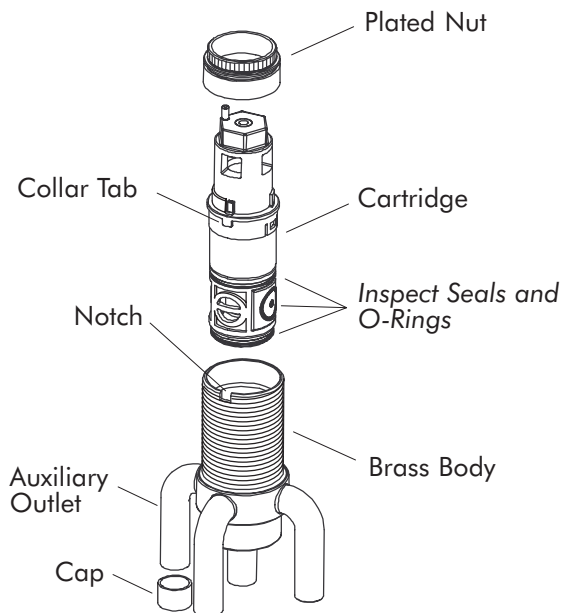

12. HANDSHOWER INSTALLATION

Two types of spray hose, one heavy gauge (high-pressure) and the other decorative, are included.

One end of the decorative hose is smaller than the other. Feed this end down through the hose guide, and attach with a washer to the heavy duty hose.

For Pillows Installation: Carefully pry the O-ring off of the end of the decorative hose and discard.

For Elbow Installation: Thread the supplied elbow assembly, with screen/washer, onto the handshower.

Thread the decorative hose, with washer, onto elbow assembly.

For Upright Installation: Thread decorative hose, with washer, onto handshower.

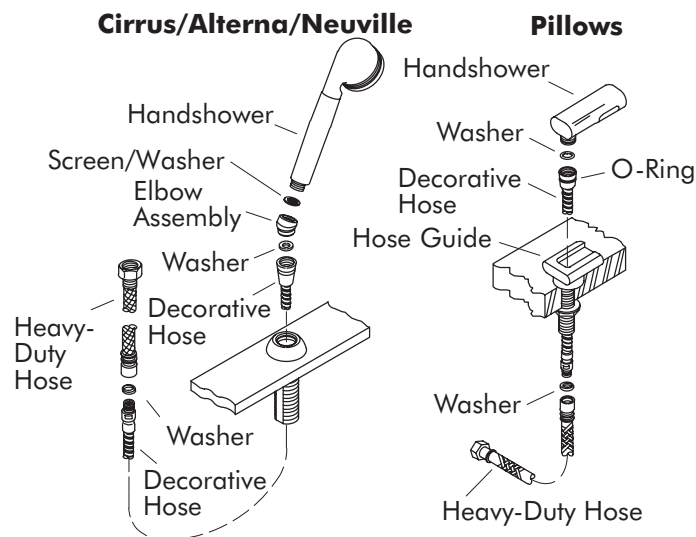

Connect the heavy-duty hose, with washers, where appropriate for your installation. This two-hose arrangement makes it possible to replace the decorative hose without removing the access panel, deck or framing to gain access.

NOTE: Be sure to unwind any twists in either hose. Also make sure hose does not snag any portion of bath/whirlpool framing.

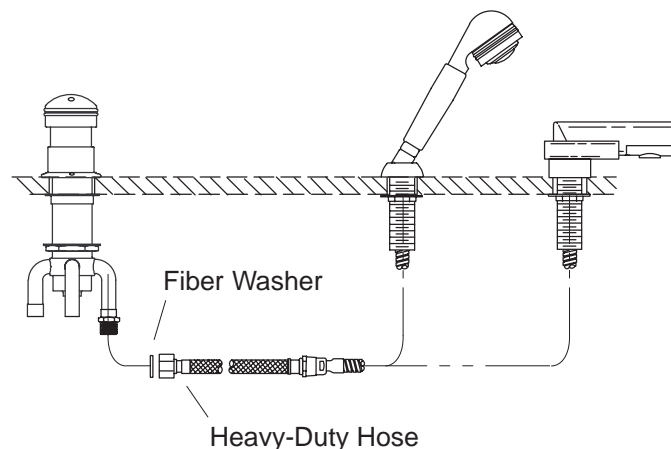

Check showerhead for smooth operation. Grasp the outer ring of the showerhead and gently rotate clockwise or counterclockwise. There are two small detents within the outer ring to divide the three operating positions.

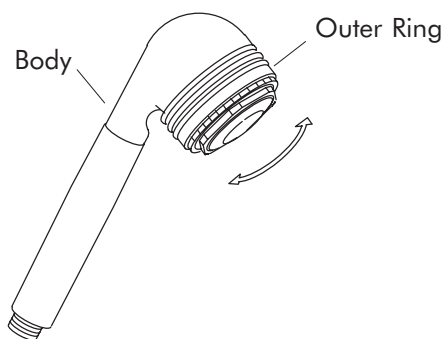

13. WATER CHECK/FLUSH

NOTE: Do not install your drywall or finish wall until water has been circulated through the system under full pressure, and until you have checked for leaks.

Remove the showerhead(s). Be sure that the spout is not connected. Run the water (hot and cold) for a few moments to flush out any debris.

If water flows from the transfer valve cartridge during operation, or if the transfer valve becomes plugged or inoperable, see page 17.

Check all connections. The transfer valve should rotate freely.

After the system has been flushed, reinstall the hand showerhead and wall showerhead.

When you are certain that the system is flushed, reinstall the hand showerhead and wall showerhead.

When you are certain that your installation is watertight, cover or remove all handles and escutcheons, the handshower, and the transfer valve.

Install the drywall and finish wall materials per the installation instructions packed with the bath/whirlpool.

14. TRANSFER VALVE TRIM INSTALLATION

Turn the valve to the tub fill position (fully clockwise for two-way valve; center position for the three-way configuration).

Apply a bead of plumbers putty or other sealant around the escutcheon flange according to the putty manufacturer's instructions. Position the escutcheon loosely on the valve so the three dots will be clearly visible after installation.

Temporarily position the knob on the valve to confirm proper dot alignment.

Remove the knob, and press the escutcheon firmly into place.

Remove any excess putty.

Install the trim rings onto the knob grooves, using care to avoid stretching the trim rings.

Secure the knob to the valve with the screw.

Install the O-ring onto the remaining knob groove.

Snap the cap onto the knob.

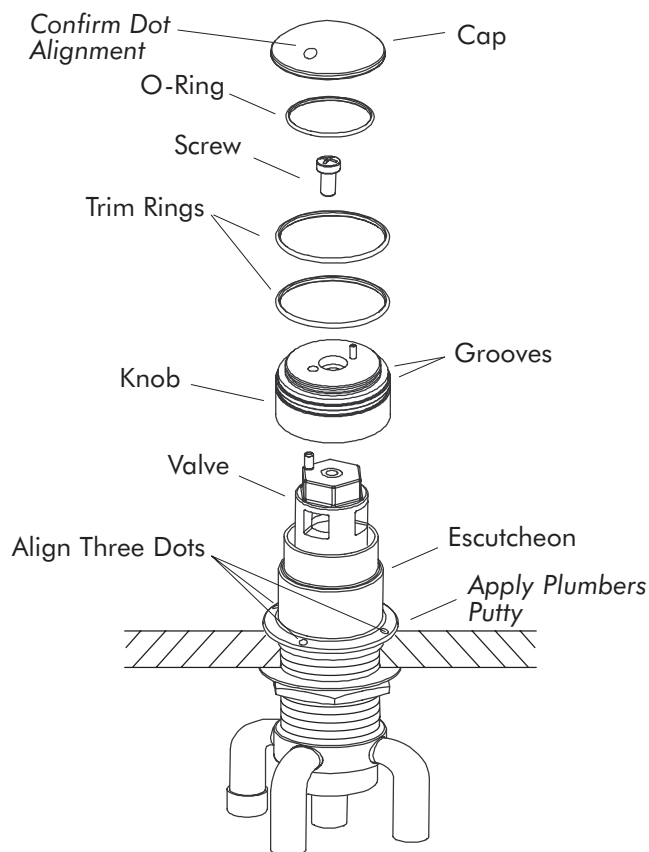

15. HANDLE INSTALLATION

Assemble and install the valve handles in the sequence shown for the handle style used.

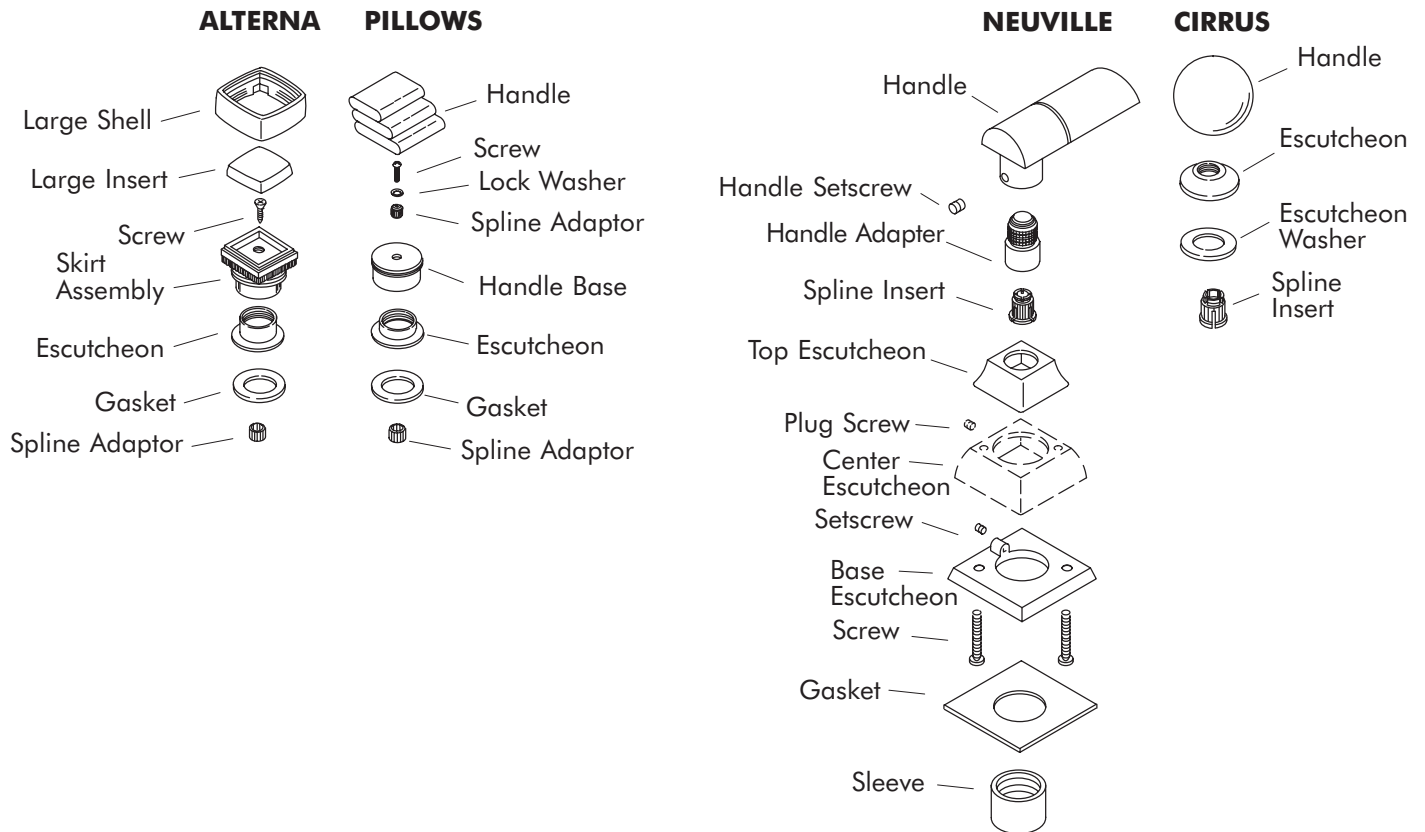

16. SPOUT INSTALLATION



CAUTION: Risk of product damage or poor product performance. Be sure to flush all water lines before installing the spout.

Apply silicone sealant around wall fasteners and bolts.
Slide O-ring onto spout tube inlet.

For K-868 & K-870: Line up the spout tube assembly inlet and bolts to the holes in the bath wall.

For K-1398: Line up the spout tube assembly, with fasteners attached, to the holes in the bath wall.

Thread the bolts into the fasteners until the gap between the wall and the spout tube assembly is approximately 1/8".

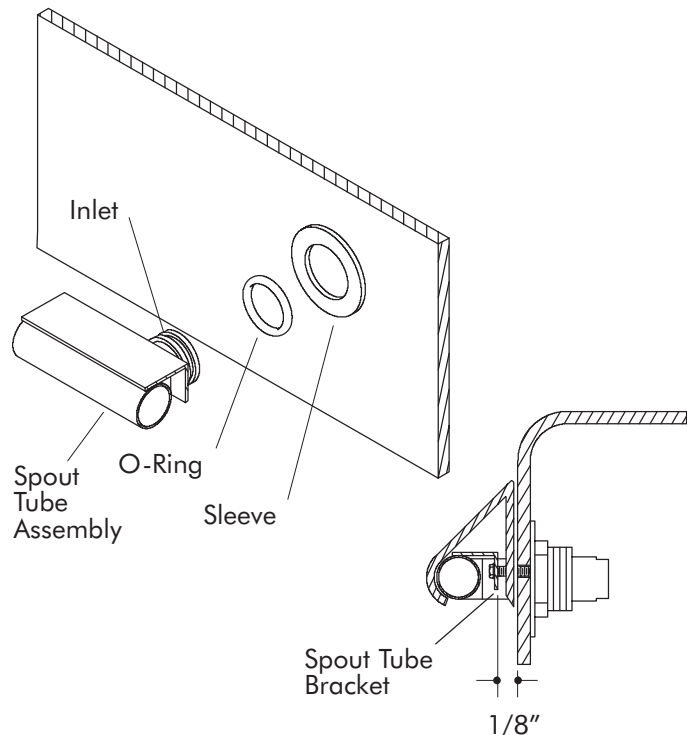

Slip the shroud onto the spout tube. Level shroud and tube. Tighten the bolts evenly to avoid stressing the spout tube. Apply silicone sealant under spout tube at the bolt locations.

Turn the faucet on. Water will be flowing out of the spout as a sheet. If sheetflow is not complete and breaks are occurring, see page 18.

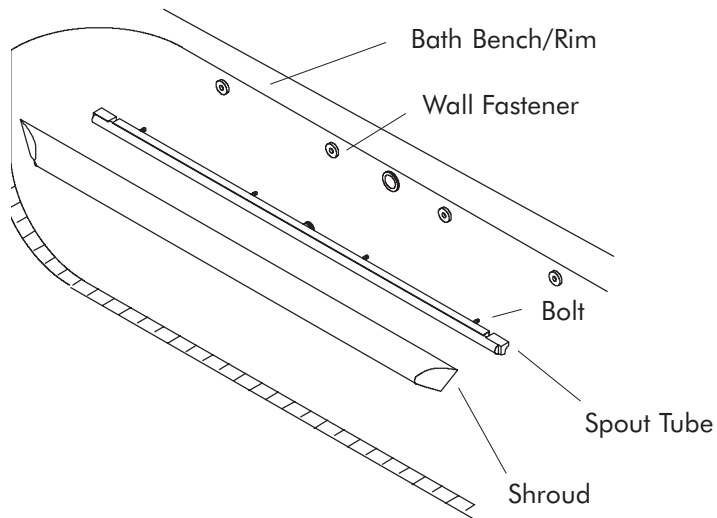

17. TROUBLESHOOTING

FOR TRANSFER VALVE:

If water flows from the transfer valve cartridge during operation, or if the transfer valve becomes plugged or inoperable, disassemble and clean the cartridge in the following manner:

Remove the plated nut from the transfer valve. Carefully pull the cartridge from the brass body. Use care to prevent the cartridge seals and O-rings from falling off, or becoming dirty or damaged.

Line up the transfer tube stop with the slot in the grey collar.

Use a thin-bladed screwdriver to carefully pry the two locking tabs loose from the transfer tube.

Carefully remove the rectangular seals from the cartridge, and set them on a clean, soft surface.

Slowly work the transfer tube out of the cartridge body. Do not lose or damage the transfer tube O-rings now exposed.

Lift the poppet out of the cartridge, and carefully clean both with hot water. Do not use any solvents to clean the components.

Reinstall the poppet to the cartridge, and carefully slip the transfer tube back into the cartridge. Use special care to work the O-ring past the large port in the cartridge without pinching or scoring the O-ring. Slightly twist the transfer tube back and forth to ease reassembly. Verify that the transfer tube hole lines up with the large port in the cartridge. Align the collar on the transfer tube so the collar tab lines up with the large port. Snap the collar in place so both locking tabs are fully engaged.

Inspect the rectangular seals for dirt or damage, and install the seals to the cartridge. Carefully press the cartridge into the brass body so the collar tab fits fully into the notch in the brass body.

Handtighten the plated nut to the brass body.

If the trim will be installed at a later date, reinstall the mud guard.

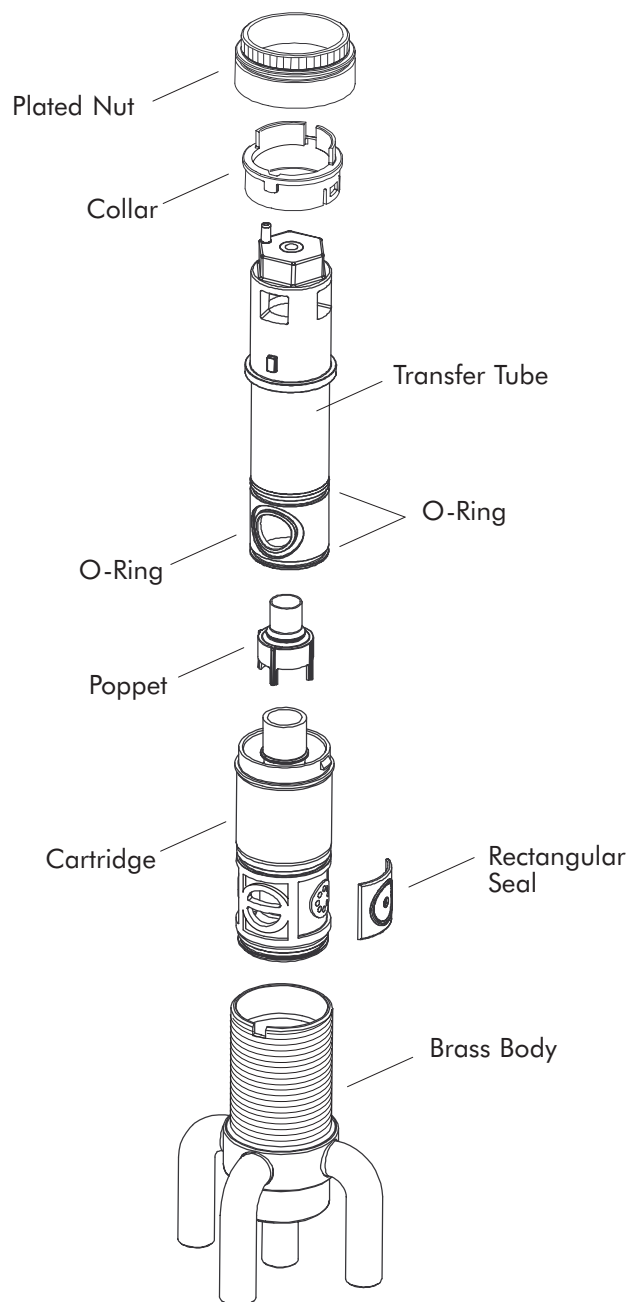

FOR SHEETFLOW:

If sheetflow is not complete and breaks are occurring, check the following:

Are tube and shroud level?

- Readjust tube and shroud so both are level.

Is shroud centered onto tube assembly?

- Readjust shroud to center on tube.

Is the bath wall clean?

- Use soft cloth and cleaner recommended for the bath/whirlpool. Excess sealant must be removed below spout.

NOTE: Do not use wax or polish. Wax causes water to bead on the bath surface and will cause breaks in the sheetflow.

Are holes or slots blocked?

- Remove obstruction.

NOTE: If sheet flow is not complete and breaks in the sheet flow are still occurring, loosen bolts and raise shroud about 1/4". The bottom of the shroud back and the bottom of the bracket on the spout tube assembly should be the same height. Retighten fasteners.

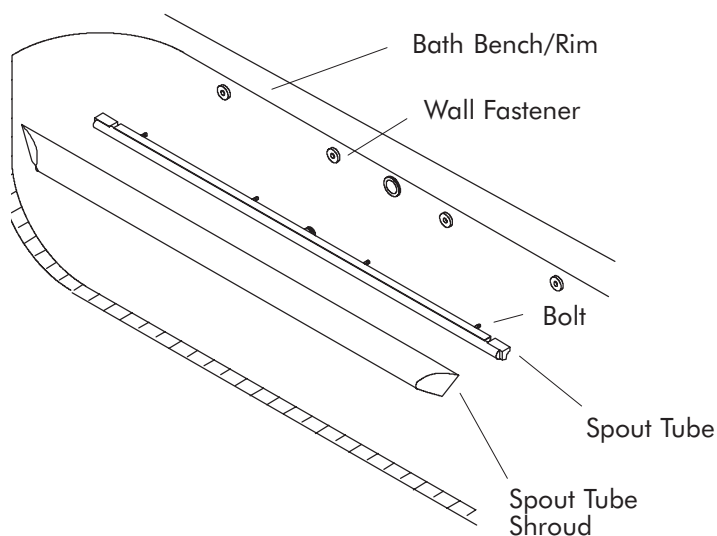

CALL US FOR HELP

Questions? Problems? First review the installation instructions to ensure correct installation. For additional assistance in the USA, call our Customer Service Department for direct help. You may also contact us at our web site listed below.

1-800-4-KOHLER

THE BOLD LOOK
OF **KOHLER**[®]
www.kohlerco.com