

WIDESPREAD LAVATORY FAUCET

BEFORE YOU BEGIN

NOTES

- Shut off the main water supply.
- Inspect the supply tubing for damage. Replace as necessary.
- Observe local plumbing codes.
- If possible, install this faucet before installing the lavatory.
- Kohler Co. reserves the right to make revisions in the design of faucets without notice, as specified in the Price Book.

TOOLS AND MATERIALS RECOMMENDED

- Adjustable wrench
- Thread sealant
- Plumbers putty
- Hacksaw or tubing cutter
- Pipe wrench
- Channel lock pliers

INSTALLATION

FAUCET

- Disassemble and save the spout hardware.
- Apply a ring of plumbers putty or other sealant to the underside of the spout according to the putty manufacturer's instructions. Fit the spout and lift rod through the center lavatory hole.
- Install the metal washer and nut, and securely wrench tighten the nut.
- Remove any excess putty or sealant.
- Thread the shank nut about halfway up the spout shank.

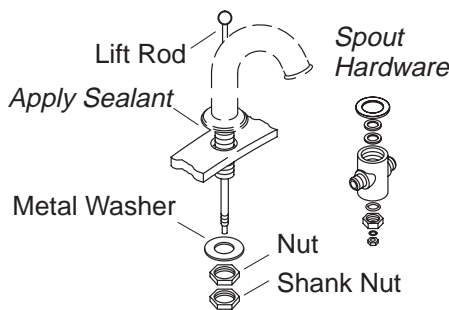

- Insert the plastic gasket and rubber washer into the supply tee. Slide the metal washer on the spout shank, and thread the supply tee to the spout shank until hand tight.
- Align the supply inlets to the sides, and carefully wrench tighten the hex end of the supply tee.
- Thread the shank nut down against the supply tee, and securely wrench tighten.
- Slip the guide tube O-ring over the guide tube, and wrench tighten the guide tube nut to the tee.
- Slide the lift rod O-ring all the way up the lift rod, and securely hand tighten the lift rod nut until you achieve the desired lift rod resistance.

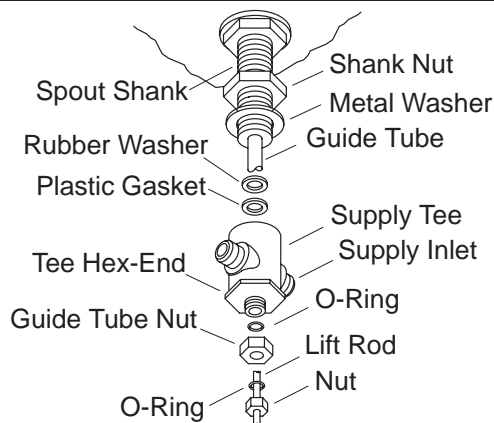

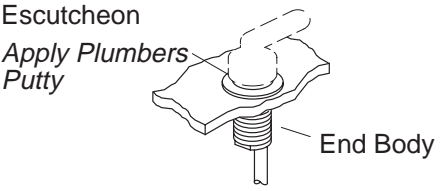
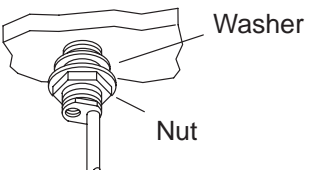
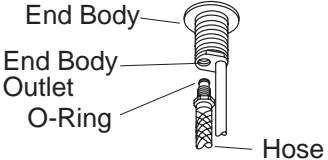
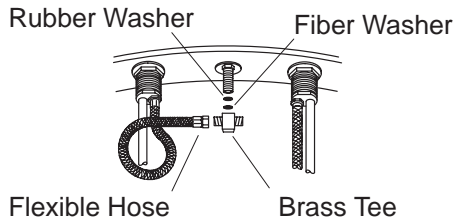
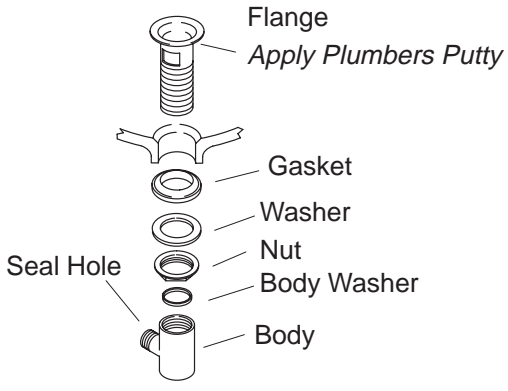
<ul style="list-style-type: none"> • Apply a ring of plumbers putty or other sealant to the underside of the escutcheons according to the putty manufacturer's instructions. • Insert the end bodies into the mounting holes from the top of the lavatory. Make sure the end body marked "Cold" is installed in the right-hand hole (as viewed from the front of the lavatory). 	
<ul style="list-style-type: none"> • Install a washer and nut to the bottom of the end bodies. • Align the end bodies so the copper tubing faces to the outside. • Wrench tighten the nuts. • Remove any excess putty or sealant. 	
<ul style="list-style-type: none"> • Thread the hoses to the end body outlets. Wrench tighten, but do not overtighten. 	
<ul style="list-style-type: none"> • Insert the plastic gasket and rubber washer into the tee. Thread the tee onto the spout shank. • Hold the spout in position, and tighten the tee securely. Do not overtighten. • Connect the flexible hoses to the tee inlets. Do not use thread sealant. To avoid kinking the hoses, loop them as shown. Do not overtighten. 	
<p>DETERMINE YOUR DRAIN STYLE AND FOLLOW THE APPROPRIATE INSTALLATION STEPS.</p>	
<p>DRAIN (CP AND PB FINISHES)</p> <ul style="list-style-type: none"> • Remove the protective seal from the flange. • Apply a 1/2" diameter ring of plumbers putty or other sealant around the underside of the flange according to the putty manufacturer's instructions. Insert the flange into the lavatory drain hole. • Assemble the gasket (tapered side up) and washer to the flange, and partially thread the nut to the flange. Do not fully tighten the nut yet. • Install the body washer and body to the flange, and wrench tighten. • Position the body so the seal hole is facing toward the back of the lavatory. • Handtighten the nut. • Remove any excess putty or sealant. 	

DRAIN (OTHER FINISHES)

- Remove the flange from the body.
- Thread the nut completely onto the body.
- Apply a 1/2" diameter ring of plumbers putty or other sealant to the underside of the drain flange according to the putty manufacturer's instructions.
- Insert the drain body up into the underside of the lavatory drain hole.
- Position the body so the seal hole is facing toward the back of the lavatory.
- Thread the flange onto the drain body from the topside of the lavatory.
- Securely handtighten the nut from the underside of the lavatory.
- Remove any excess putty or sealant.

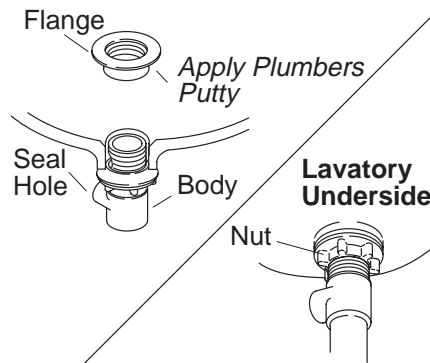

- Assemble the nylon washer, metal washer, and nut onto the long end of the rod.
- Assemble the nylon washer and rubber washer onto the short end of the rod.

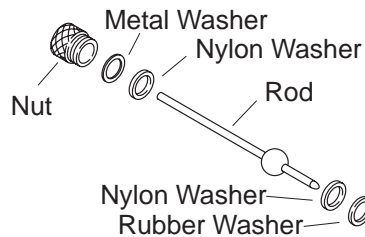

ALL DRAINS

- Insert the stopper into the flange.
- Remove the body nut from the seal hole.
- Fit the short end of the rod into the body seal hole and **under** the stopper for regular installations; **through** the hole for vandal-resistant installations.
- Loosely secure in place with the body nut.
- Remove and adjust the stopper so the stopper lifts about 3/8" when opened. To adjust, loosen the stopper nut and shorten or lengthen the stopper as needed. Re-tighten the stopper nut.
- Handtighten the body nut.
- Apply thread sealant to the tailpiece. Thread the tailpiece into the body and securely handtighten.

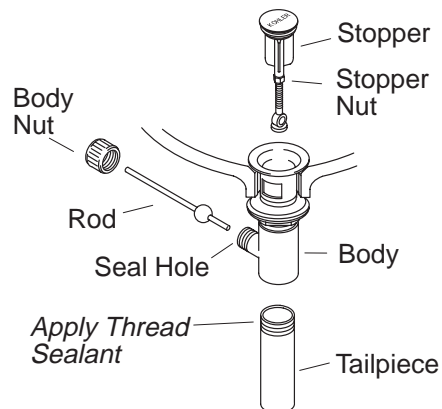

- Slide the clip and the link onto the rod with the thumb screw facing toward the back of the lavatory.
- To move the link to the proper position, squeeze the clip and slide it along the rod.
- Push the rod down (open position).
- Slide the lift rod through the hole in the link.
- Tighten the thumb screw on the link so the lift rod knob is 1/2" above the lift rod hole.

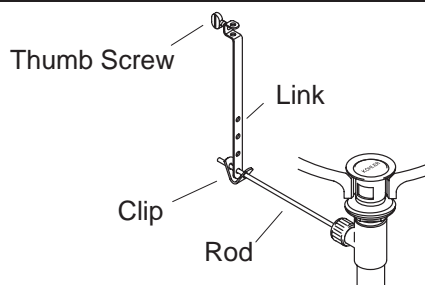

IF THE LAVATORY IS NOT INSTALLED, INSTALL IT AT THIS TIME. BE SURE TO FOLLOW ALL INSTRUCTIONS PACKED WITH THE LAVATORY.

SUPPLIES AND STOPS

- Connect the supply tubes to the faucet end bodies and supply stops. (Left is hot – right is cold.)
- Tighten all connections.

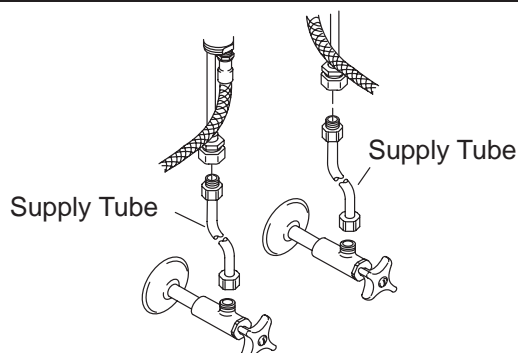

INSTALLATION CHECKOUT

- Connect the tailpiece and P-trap.
- Ensure that all connections are tight.
- Open the drain.
- Turn on the main water supply and check for leaks.
- Open both hot and cold valves and run water through the spout to confirm proper operation.
- Close both valves.

CALL US FOR HELP – 1-800-4-KOHLER

REQUESTING SERVICE

Here's what you need to do if you require service:

First review the installation instructions to ensure correct installation. If you are still unable to correct the problem, call our Customer Service Department for direct help. Dial **1-800-4-KOHLER**.