

Fig. #1

INSTALLING THE K-258 TRIM FOR WIDESPREAD AND KITCHEN VALVES

1. Refer to Fig. #1. If replacing ceramic trim, loosen set screw and pull handle off stem extension.
2. Remove stem extension. Insert wide-bladed screwdriver into slot on bonnet nut and turn counterclockwise to loosen. Remove bonnet nut; remove ceramic bell.
3. For new and replacement installations, place new ceramic bell over bonnet; secure with bonnet nut. Insert wide-bladed screwdriver into slot on bonnet nut and turn clockwise to tighten.
4. Place ceramic cap into oval handle; secure from underneath with flathead screw.
5. Align handle assembly onto stem extension; secure with set screw.

CAUTION: To avoid damaging ceramic cap, do not overtighten flathead screw. Recommended maximum torque is 10 inch-pounds.

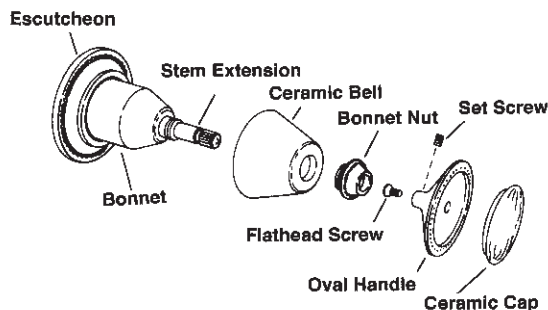

Fig. #2

INSTALLING THE K-260 TRIM FOR WALL MOUNT BATH VALVE

1. Refer to Fig. #2. If replacing ceramic trim, loosen set screw and pull handle off stem extension.

2. Remove stem extension. Insert wide-bladed screwdriver into slot on bonnet nut and turn counterclockwise to loosen. Remove bonnet nut; remove ceramic bell.
3. For new and replacement installations, place new ceramic bell over bonnet; secure with bonnet nut. Insert wide-bladed screwdriver into slot on bonnet nut and turn clockwise to tighten.
4. Place ceramic cap into oval handle; secure from underneath with flathead screw.
5. Align handle assembly onto stem extension; secure with set screw.

CAUTION: To avoid damaging ceramic cap, do not overtighten flathead screw. Recommended maximum torque is 10 inch-pounds.

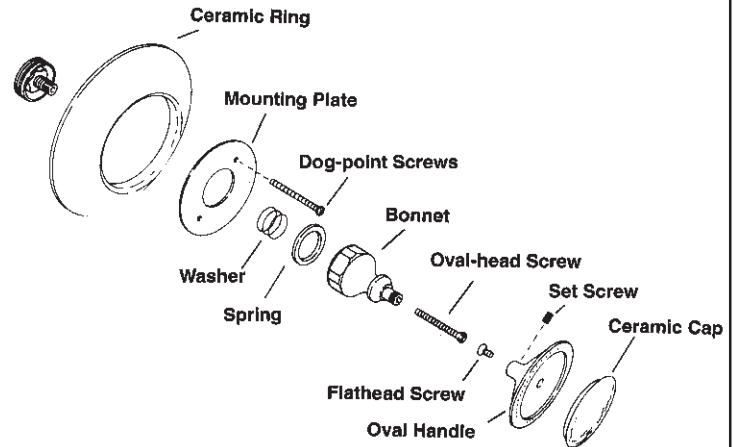

Fig. #3

INSTALLING THE K-262 TRIM FOR RITE-TEMP VALVE

1. Refer to Fig. #3. If replacing ceramic trim, loosen set screw and pull handle off stem extension.
2. Loosen oval-head screw and remove bonnet, washer and spring. Loosen dog-point screws and remove mounting plate. Remove ceramic ring.
3. For new and replacement installations, place ceramic ring over valve. Secure with mounting plate and two dog-point screws.
4. Place spring, washer, and bonnet over valve as shown. Secure bonnet onto valve with oval-head screw.
5. Place ceramic cap into oval handle; secure from underneath with flathead screw.
6. Align and place handle assembly onto bonnet; secure with set screw.

CAUTION: To avoid damaging ceramic cap, do not overtighten flathead screw. Recommended maximum torque is 10 inch-pounds.

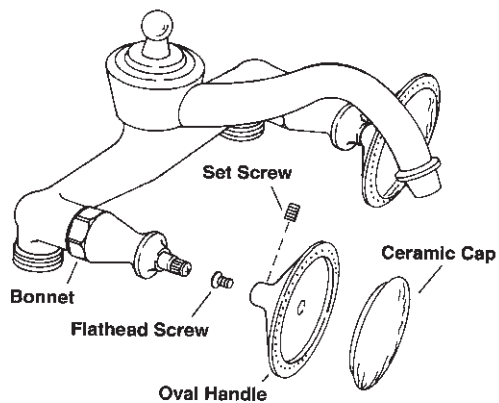

Fig. #4

**INSTALLING THE K-264 TRIM
FOR DECK MOUNT BATH VALVE**

1. **Refer to Fig. #4.** If replacing ceramic trim, loosen set screw and pull handle off bonnet.
2. For new and replacement installations, place ceramic cap into oval handle; secure from underneath with flathead screw.
3. Align and place handle assembly onto bonnet; secure with set screw.

CAUTION: To avoid damaging ceramic cap, do not overtighten flathead screw. Recommended maximum torque is 10 inch-pounds.

SERVICE PARTS

| | | |
|---|-------|---|
| 1 | 42291 | Ceramic Ring |
| 2 | 52722 | Ceramic Cap w/Flathead Screw |
| 3 | 52407 | Flathead Screw |
| 4 | 52571 | Ceramic Bell for Wall Mounted Bath |
| 5 | 52568 | Ceramic Bell for Lav., Bidet, Kitchen, and Bar Sinks |

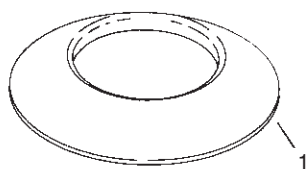

K-262

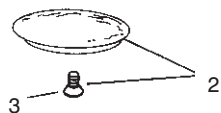

**K-262
K-258
K-260
K-264**

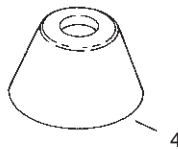

K-260

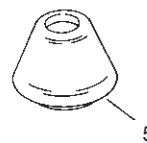

K-258