



Briar Rose Caxton®

Under-mount Bathroom Sink
K-14218-BR

Features

- Vitreous china.
- Under-mount.
- Deep oval basin.
- Without overflow.
- No faucet holes; requires wall- or counter-mount faucet.
- KOHLER Artist Editions designs.
- Briar Rose design.
- 17" (432 mm) x 14" (356 mm)

Recommended Accessories

K-9018 P-Trap

Components

Product includes:
1193643 Basin Clamps



ADA

Codes/Standards

ASME A112.19.2/CSA B45.1
ADA
ICC/ANSI A117.1

KOHLER® One-Year Limited Warranty

See website for detailed warranty information.

Available Color/Finishes

Color tiles intended for reference only.

Color	Code	Description
-------	------	-------------

	96	Biscuit
--	----	---------



Briar Rose Caxton® Under-mount Bathroom Sink K-14218-BR

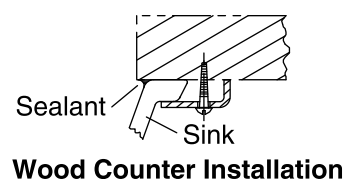
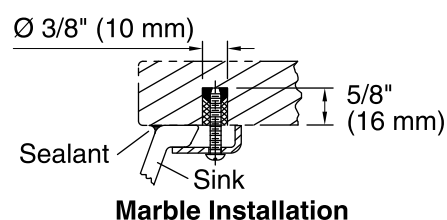
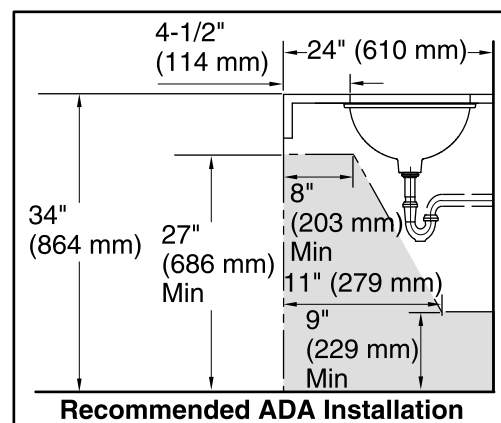
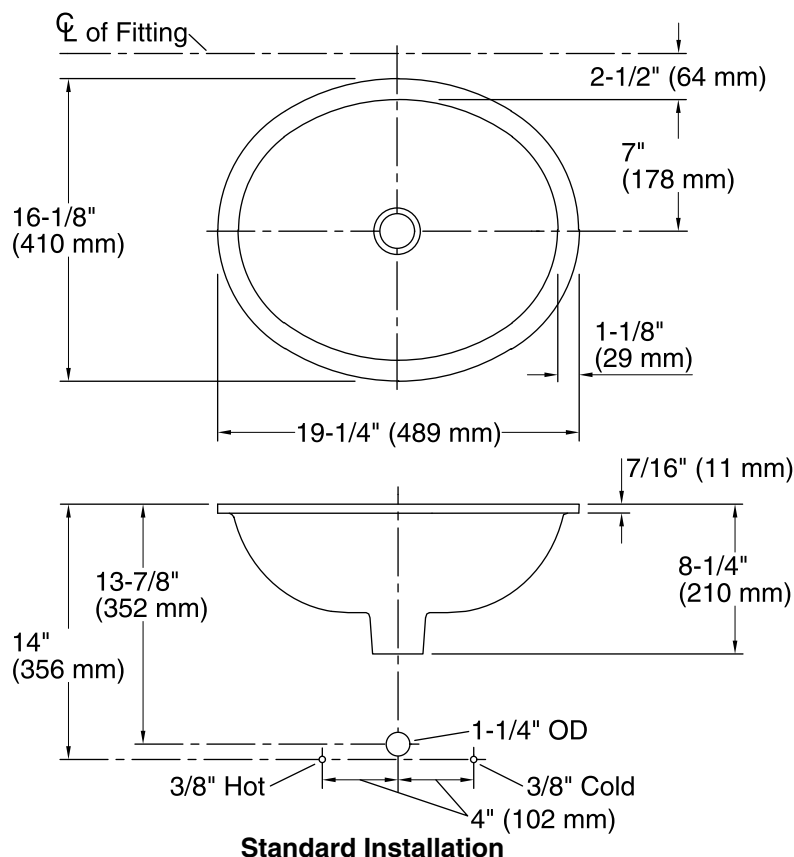

Technical Information

All product dimensions are nominal.

Bowl configuration: Single

Installation: Under-mount

Bowl area (Only) Length: 17" (432 mm)
Width: 14" (356 mm)
Water depth: 6-3/8" (162 mm)

Drain hole: 1-3/4" (44 mm)

Template: 1151011-7, required, included

Notes

Install this product according to the installation instructions.

NOTICE: Countertop manufacturer or cutter must use the cut-out template provided with the product, or a current one provided by Kohler Co. (call 1-800-4-KOHLER). Kohler Co. is not responsible for cutout errors when the incorrect cut-out template is used.

ADA compliant when installed to the specific requirements of these regulations.