



Verdera®
24" x 34" oval medicine cabinet
K-35571-NFC

Features

- Front mirror, inside door mirror, and back panel mirror provide superior visibility
- Two adjustable tempered-glass shelves offer additional bathroom storage
- Half-shelf adjustable accessory shelf for additional storage
- Hinges have 110° opening capability
- Box includes: Assembled mirrored cabinet, side panel kit, installation hardware

Material

- Anodized aluminum construction with a durable rustproof and chip-resistant finish
- KOHLER finishes resist corrosion and tarnishing

Installation

- Surface-mount or recessed
- Can be installed with left- or right-hand swing



Codes/Standards

None Applicable

**KOHLER® One-Year Limited
Warranty**

See website for detailed warranty information.



Verdera®
24" x 34" oval medicine cabinet
K-35571-NFC

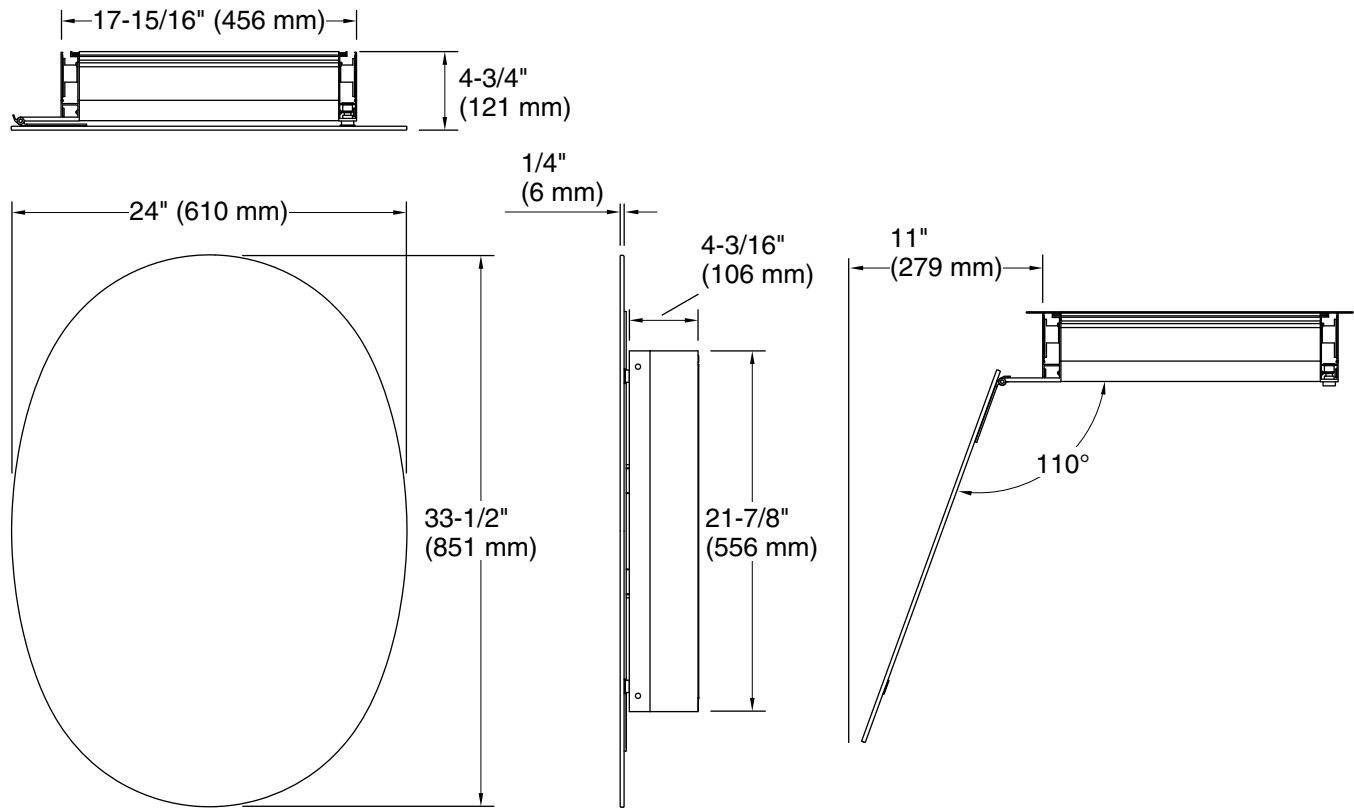

Technical Information

All product dimensions are nominal.

Notes

Install this product according to the installation instructions.

1-800-4KOHLER (1-800-456-4537)

Kohler Co. reserves the right to make revisions without notice to product specifications.

For the most current Specification Sheet, go to www.kohler.com USA or www.kohler.ca Canada

2-16-2025 20:41 - US/CA

THE BOLD LOOK
OF **KOHLER®**