



Brazn®
16-1/4" square undermount bathroom sink
K-21056

Features

- Brass drain and color-matched brass drain cover
- With overflow
- Square basin
- No faucet holes; requires counter-mount faucet with lift rod

Material

- Vitreous china

Installation

- Undermount



ADA **CSA B651** **OBC**

Codes/Standards

ASME A112.19.2/CSA B45.1
ADA
ICC/ANSI A117.1
CSA B651
OBC

KOHLER® Vitreous China Bathroom Sink Lifetime Limited Warranty

See website for detailed warranty information.

Available Colors/Finishes

Color tiles intended for reference only.

Color Code Description

	0	White
---	---	-------



Brazn®

16-1/4" square undermount bathroom sink
K-21056

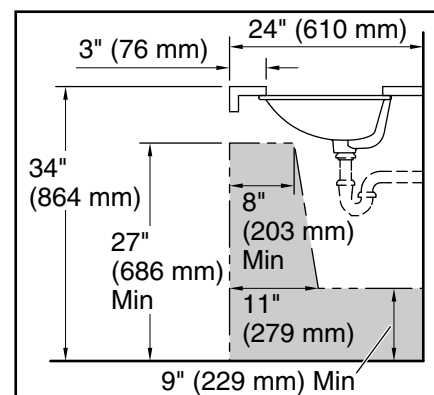
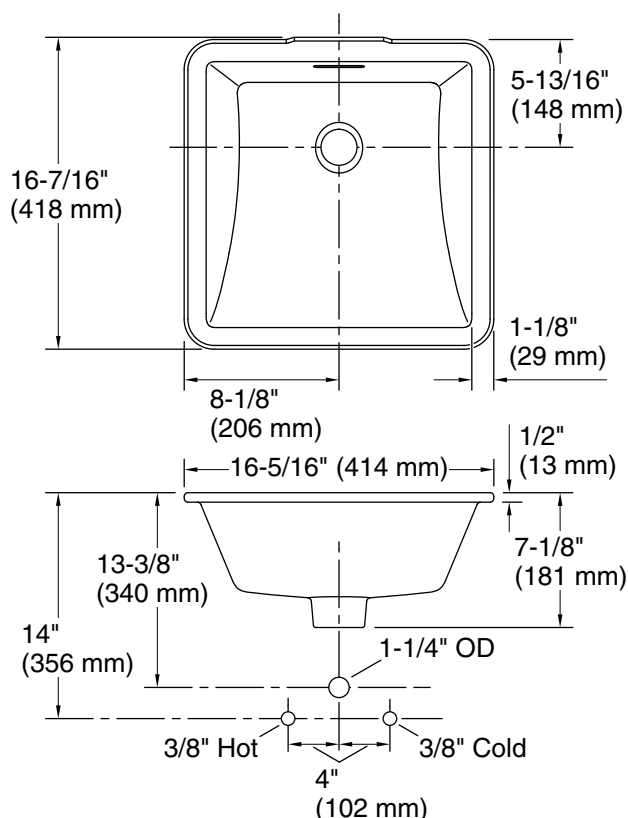

Recommended ADA Installation

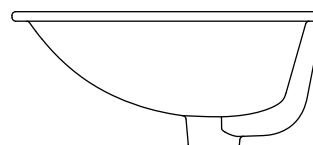

Technical Information

All product dimensions are nominal.

Basin configuration: Single Bowl

Bowl area (Basin #1):
Length: 13-7/8" (352 mm)
Width: 13-7/8" (352 mm)
Bowl depth: 5-1/8" (130 mm)

With overflow: Yes

Drain hole: 1-3/4" (45 mm)

Template: 1483027-7, required, included

Notes

Install this product according to the installation instructions.

NOTICE: Countertop manufacturer or cutter must use the cut-out template provided with the product, or a current one provided by Kohler Co. (call 1-800-4-KOHLER). Kohler Co. is not responsible for cutout errors when the incorrect cut-out template is used.

ADA, OBC, CSA B651 compliant when installed to the specific requirements of these regulations.