



## Whitehaven® Hayridge®

30" Sink with Tall Apron  
**K-7251**

### Features

- 30-inch minimum base cabinet width.
- KOHLER cast iron.
- Acid-resistant enamel finish.
- Single bowl.
- No faucet holes.
- Offset drain basin slopes toward drain to minimize water from pooling.
- 29-11/16" (754 mm) x 21-9/16" (548 mm)
- Decorative apron pattern.

### Installation

- Under-mount
- Self-Trimming® apron overlaps cabinet face for easy installation and beautiful results.

### Recommended Accessories

K-9000 P-Trap

### Optional Accessories

K-6638 Sink Rack

K-8801 Sink Strainer



### Codes/Standards

ASME A112.19.1/CSA B45.2

### KOHLER® Lifetime Limited Warranty for Cast Iron Components

See website for detailed warranty information.

### Available Color/Finishes

*Color tiles intended for reference only.*

Color	Code	Description
-------	------	-------------



0	White
---	-------

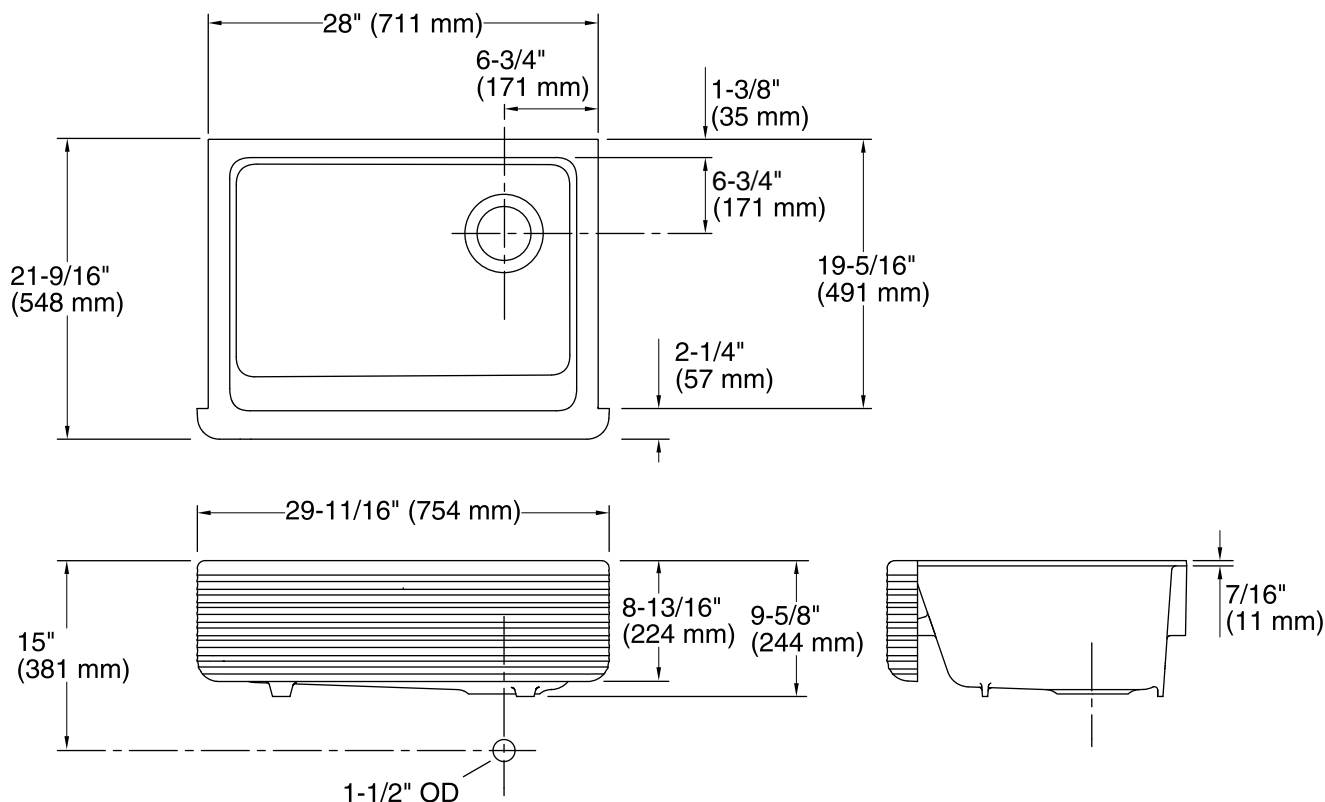

### Technical Information

All product dimensions are nominal.

Bowl configuration: Single

Installation: Under-mount

Min. base cabinet width: 30" (762 mm)

Bowl area (Only) Length: 24-3/4" (629 mm)

Width: 18-1/16" (459 mm)

Bowl depth: 9" (229 mm)

Drain hole: 3-5/8" (92 mm)

Template: 1156909-7, required, included  
1157000, required, included

### Notes

Install this product according to the installation instructions.

**IMPORTANT!** The distance from the top edge of the cabinet to the top of the cabinet door must be at least 9" (229 mm) to install this sink.

**NOTICE:** Countertop manufacturer or cutter must use the cut-out template provided with the product, or a current one provided by Kohler Co. (call 1-800-4-KOHLER). Kohler Co. is not responsible for cutout errors when the incorrect cut-out template is used.