

INSTALLATION INSTRUCTIONS[†] - 12V

DRY LOCATION

FOR USE IN DRY LOCATIONS ONLY
BEFORE INSTALLING

All installations should comply with national and local electrical codes. If you have any doubts concerning installation, contact a qualified, licensed electrician. Supply leads and interconnects are not listed for **In-Wall** use. Read all instructions thoroughly before starting installation.

- This fixture can only be used with Kichler® LED Tape Lighting power supply and accessories. This fixture must be connected to a NRTL Listed Class 2, 12V DC power supply.
- Voltage drop limits the linear run length of 12V DC fixtures, and these lengths may differ between the products listed below.

a. 4T1xxSxxxx = 16 feet (Standard)

b. 4T1xxHxxxx = 16 feet (High)

- Total wattage of tape light should not exceed power supply wattage. To determine the total wattage of tape light, multiply the total number of feet used by the wattages listed below for the appropriate tape light type.

a. 4T1xxSxxxx = 1.5 W/ft. (Standard)

b. 4T1xxHxxxx = 3 W/ft. (High)

* Maximum linear run length is determined using a 60W power supply & a 1' power supply lead with a continuous linear run of LED tape light.

Please contact Kichler's Advanced Technical Support team for questions about the maximum run length at techsupport@kichler.com.

INSTALLATION

1. Install power supply.

Note: The power supply should be installed by a qualified electrician and be installed in accordance with national and local electric codes. Refer to the power supply installation instructions for further detail.

2. Run supply lead wire from power supply to beginning of tape light run.

Do not connect lead wire to power supply yet.

3. Measure and if necessary, cut the first section of tape light, leaving a minimum of one inch of space on each end for connections.

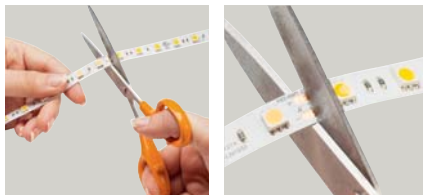

Note: To cut the tape light, use a pair of sharp scissors or snips and cut on the dotted cut line only.

4. Completely remove 1/4" of the adhesive backing from either end of the tape that will be inserted into the connector.



Remove 1/4" of the adhesive backing

Caution: If the adhesive backing is not removed, this may cause damage to the connector.

5. Connect tape light to supply lead wire.

Note: Make sure +/- symbols on tape light line up with the +/- symbols on the connector of the supply lead wire.

TO CONNECT

1. Open connector gently using your finger nail.
2. Slide tape light into front of connector making sure that the tape is kept flat when placed in the connector's guides. Gently push the tape light forward until the tape light is fully seated in the connector and is under the prongs.

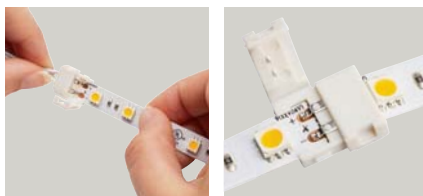

Note: Check that the connection is secure and that polarity (+/-) symbols are oriented in the same direction.

3. Close connector.



4. Remove 3M backing from tape light and apply making sure to press between the LED's and other components. **Pressing on the LED's and other components will result in damage to the tape.**



Note: For best results, peel off backing and apply tape light in small sections starting at the beginning of the run.



Note: Avoid using excessive force to prevent damage to LEDs and other components.

6. Install any additional sections of tape light and connectors in the same manner.
7. Connect power supply lead to power supply and turn on.

Note: Before powering on the system, double check that all connections are secure and that all polarity (+/-) symbols are oriented in the same direction.

[†] The instructions in this catalogue for Dry Location LED Tape Light are current as of January 1, 2016. The instruction sheet included with the product shall take precedent over the instructions in this catalogue. For the most up to date instructions please refer to www.kichler.com.