

INSTALLATION INSTRUCTIONS

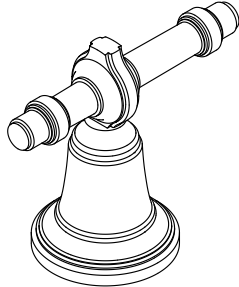

P23120-LV

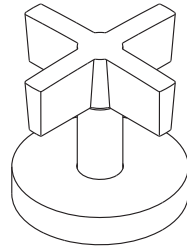

P24420-CR

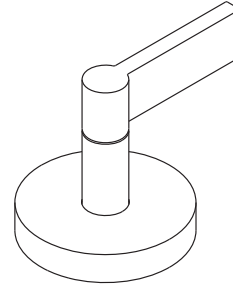

P24420-LV

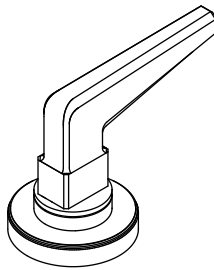

P24520-LV

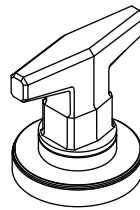

P24520-TT

INSTALLATION INSTRUCTIONS

THANK YOU FOR CHOOSING KALLISTA

We appreciate your commitment to Kallista quality products. Please take a moment to review this manual before you install your Kallista product. If you encounter any installation or performance problems, please do not hesitate to contact us at the phone number listed at the bottom of the page.

BEFORE YOU BEGIN

INSTALLER INFORMATION

- Please read all instructions before you begin.
- The appearance of your product may differ from what is shown in these instructions, however, the installation procedure is the same.
- This installation requires that the valve (P29515-00-NA) be installed prior to the trim, according to the instructions packed with the valve.
- Shut off the main water supply.
- Observe all local plumbing and building codes.
- Complete the finished deck material before installing the diverter valve trim.
- Before installation, unpack the new diverter valve trim and inspect it for damage. Return it to the carton until installation.
- Kallista reserves the right to make revisions in the design of faucets without notice, as specified in the Price Book.

TOOLS AND MATERIALS

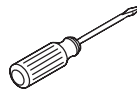

Screwdriver

INSTALLATION INSTRUCTIONS

INSTALL VALVE STEM EXTENSION

- Install a spline adapter on the spline at the end of the valve stem.
- Install another spline adapter on the spline at the end of the valve stem extension.
- Attach the valve stem extension to the valve stem with the pan head screw.

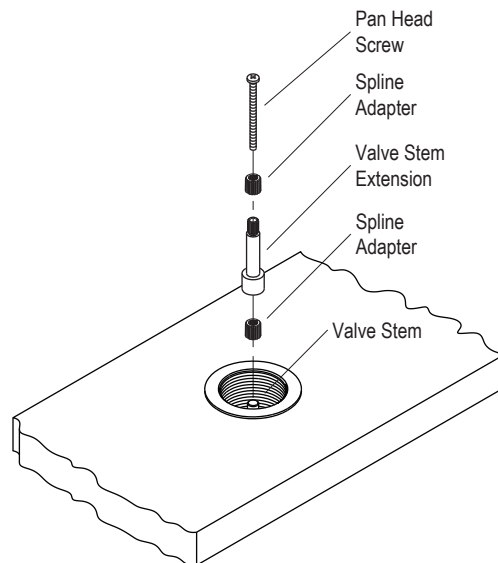

2. INSTALL HANDLE ASSEMBLY

If the mounting sleeve is visible:

- Ensure that the rubber gasket is installed in the underside of the escutcheon.
- Place the handle assembly over the stem extension making sure the handle is oriented as desired.
- Hold the handle with one hand and turn the escutcheon into the mounting sleeve until the escutcheon is flush with the mounting surface.

If the mounting sleeve is not visible:

- Ensure that the washer and rubber gasket is installed in the underside of the escutcheon.
- Place the handle assembly over the stem extension making sure the handle is oriented as desired.
- Hold the handle with one hand and turn the escutcheon into the mounting sleeve until the escutcheon is flush with the mounting surface.

