



Catalog Number
Notes
Type

Contractor Select™

IC20/IC20R

5" Incandescent Line-Voltage Housings and Trims

The IC-rated 5-inch incandescent new construction housing features an Air-Loc® seal to stop infiltration and exfiltration of air, reducing heating and cooling costs. The IC-rated housing can also be completely covered with insulation.

FEATURES:

- IC housings include an adjustable socket plate and detachable socket with snap-in springs to accommodate various lamp and trim combinations
- New construction housings feature patented Real Nail® 3 bar hangers: telescoping system with pre-installed removable bugle-headed nail for easy repositioning of housing in joist construction
- Housings include medium base porcelain socket with nickel-plated copper screw shell.
- Damp location listed.
- Trim options include 5" baffles, all in white finish.



IC20



205



V2015



IC20R



DOWNLIGHTING - HOUSINGS

Catalog Number	UPC	Description	Lamp Source	Socket	Voltage	Lamp Included	Pallet qty.
IC20	661209000927	5" New Construction IC Housing	Incandescent	E26 Screw Shell	120V	No	120
IC20 W	661209107749	5" New Construction IC Housing with Push-In Electrical Connectors	Incandescent	E26 Screw Shell	120V	No	120
IC20R	661209952714	5" Remodel IC Housing	Incandescent	E26 Screw Shell	120V	No	180

DOWNLIGHTING - TRIMS

Catalog Number	UPC	Description	Trim O.D.	Finish	Pallet qty.
205 WWH	661209950307	5" Downlight Baffle Trim	6 1/4"	White Baffle, White Trim Ring	768
V2015 WWH	661209080844	5" Fully Enclosed Downlight Baffle Trim	6 1/4"	White Baffle, White Trim Ring	576



Specifications

LAMP:

A19/BR30/PAR20/PAR30/PAR30L/R20/R30 • Lamp ratings based on trim selection.

SOCKET:

Medium base porcelain with nickel-plated copper screw shell • Drop socket with spring to accommodate certain trim installation.

LABELS:

UL listed for through-branch wiring, damp locations and IP • Product thermally protected against improper use of lamps • Union made • UL Listed/CSA certified.

TESTING:

All reports are based on published industry procedures; field performance may differ from laboratory performance.

REAL NAIL® BAR HANGERS (APPLICABLE TO NEW CONSTRUCTION HOUSING ONLY):

Telescoping, Patented (US Patent D552,969) Real Nail 3 system permits quick placement of housing anywhere within 24" O.C. joists or suspended ceilings • Bars scored in two locations for fast, clean breaking, allowing housing installation in tight applications • Bars captive to mounting frame • Edge-mounted for extra strength • Quick-Loc slot (location identified on the mounting frame) and oversized locking set screw lock fixture in position • May be installed either perpendicular or parallel to junction box.

JUNCTION BOX:

IC20: Pre-wired junction box provided with (5) 1/2" and (1) 3/4" knockouts, (4) Non-metallic sheathed cable connectors and ground wire, UL listed/CSA certified for through-branch wiring, maximum 8 No. 12 AWG 90° C branch circuit conductors (4 in, 4 out for IC20)
IC20R: Prewired junction box provided with (5) 1/2" knockouts, (4) non-metallic sheathed cable connectors and ground wire. Max (4) No. 12 AWG branch circuit conductors (2 in and 2 out) • Junction box provided with removable access plates • Knockouts equipped with pryout slots • **W options** are supplied with **push-in electrical connectors** for fast installation.

MOUNTING FRAME (NEW CONSTRUCTION HOUSINGS ONLY):

22-gauge die-formed galvanized steel mounting frame • Rough-in section (junction box, mounting frame, housing and bar hangers) fully assembled for ease of installation • Sight lines embossed on mounting frame to allow for easy viewing when aligning fixtures.

IC20 HOUSING:

IC housing, .032" aluminum sealed for Air-Loc Compliance • Housing is vertically adjustable to accommodate up to a 1" ceiling thickness.

IC20R HOUSING:

IC housing, .032" aluminum sealed for Air-Loc Compliance • Remodel springs accommodate up to 1 1/8" ceiling thickness.

WARRANTY:

1-year limited warranty. Complete warranty terms located at:

www.acuitybrands.com/CustomerResources/Terms_and_conditions.aspx

Note: Actual performance may differ as a result of end-user environment and application. Specifications subject to change without notice.

Dimensions

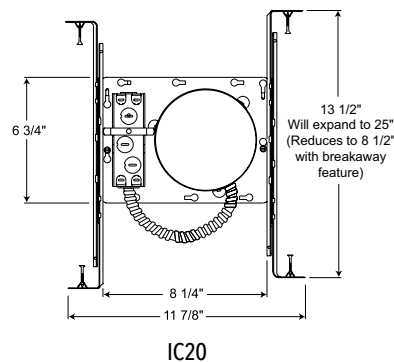
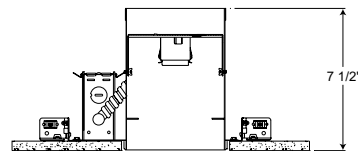

IC20

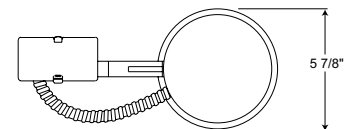
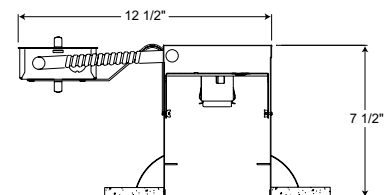

5 1/2" CEILING CUTOUT
IC20R