

STEEL CLEVIS HANGER, LIGHT DUTY

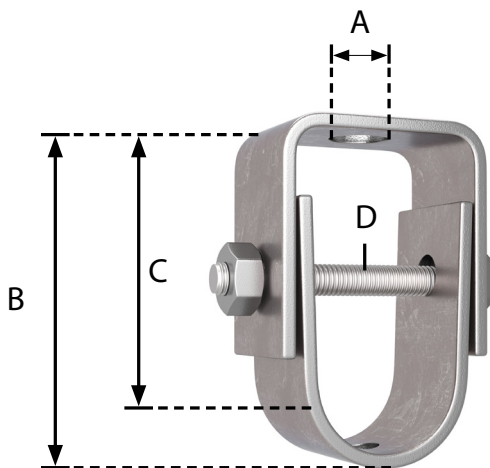

- Safely secures hanging or elevated pipes
- Durable electro zinc plated carbon steel
- Design allows for lateral and angular misalignment
- Designed for quick vertical adjustment
- Complies with SP-69 standards
- Simple installation



Part No.	Size	Rod Size	Max. Load	A	B	C	D
H69050	0.50"	0.37"	150 lbs	0.38"	2.81"	2.34"	0.25"
H69075	0.75"	0.37"	150 lbs	0.38"	3.00"	2.44"	0.25"
H69100	1"	0.37"	250 lbs	0.38"	3.31"	2.63"	0.25"
H69150	1.50"	0.37"	250 lbs	0.38"	4.00"	3.00"	0.25"
H69200	2"	0.37"	250 lbs	0.38"	4.44"	3.19"	0.25"
H69250	2.50"	0.50"	350 lbs	0.50"	5.38"	3.91"	0.38"
H69300	3"	0.50"	350 lbs	0.50"	6.00"	4.22"	0.38"
H69400	4"	0.62"	400 lbs	0.63"	7.50"	5.20"	0.38"