

CAUTION

Read all of these instructions before installation:

1. Turn off power at fuse box before installing/maintaining/servicing/modifying the system
2. Do not install in damp or wet locations
3. Do not attempt to energize anything other than a qualified lighting fixture
4. Check with a qualified electrician before wiring
5. Confirm installation shall be in accordance with NEC and all local codes

NOTE: If you need to shorten the pendant length, please refer to the quick pendant field cut instructions below

Save these installation instructions and refer to them when additions or changes to configurations are made

INSTALLATION INSTRUCTIONS

Ceiling Mounted Monopoint Canopy • QAC-1C

1. Remove screws on the outside canopy to separate the surface dome cover from the mounting bracket
2. Attach the mounting bracket to the existing ceiling electrical box
3. When wiring the transformer, connect the supply leads as follows:
 - a. white wire to neutral
 - b. black wire to hot
 - c. unisolated ground screw to ground
4. Place all wire and wire nut connections inside the electrical box
5. Replace the dome cover onto the mounting bracket and reattach the two screws
6. Holding the quick adapter connector on the pendant, push it into the receptacle on the canopy. Then turn clockwise until the connector is tightly locked

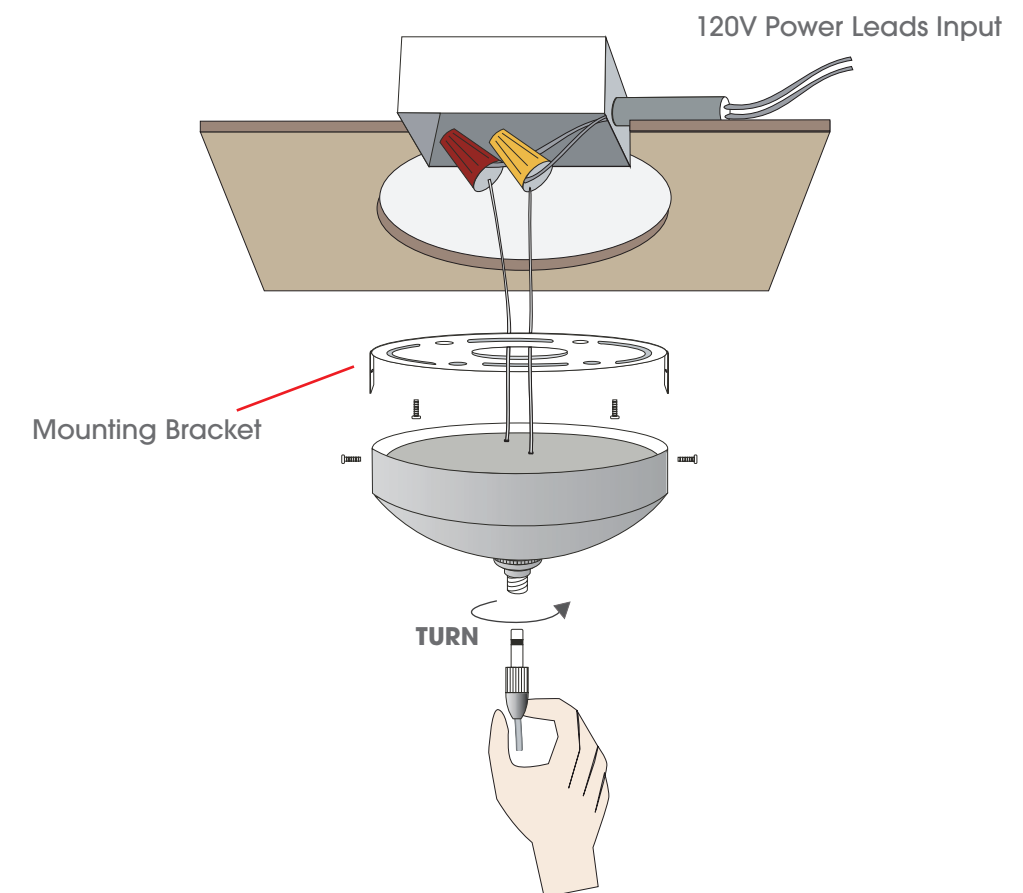

INSTALLATION INSTRUCTIONS

Low Voltage Monorail Quick Adapt Pendant • Field Cut Instructions

1. Locate the Quick Adapt connector at the top of the coaxial cord. Completely remove screws A and B with the provided allen key.

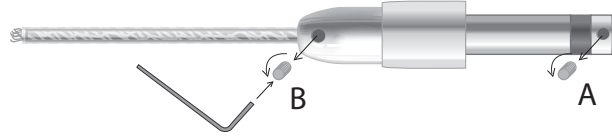

2. While holding the tip of the Quick Adapt connector, remove the base by turning it away from you.

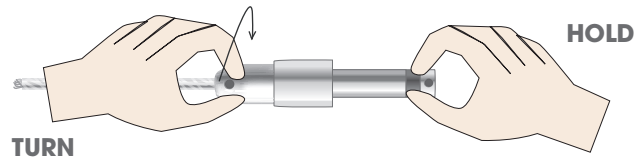

3. You can now identify the three components that make up the Quick Adapt connector.

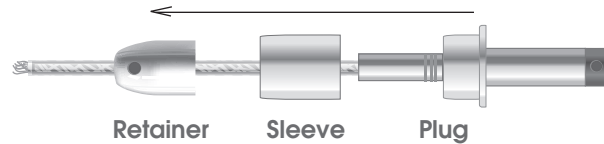

4. Disassemble the Quick Adapt connector by pulling the coaxial cord out of and away from all three components.

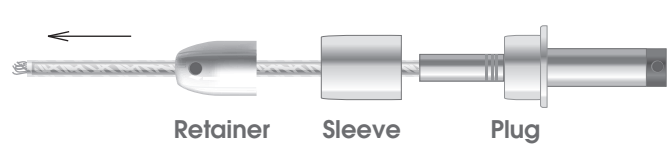

5. Measure the desired length and cut the cord. (Note: Approx. 1 inch of the cord will be inserted into the Quick Adapt connector)

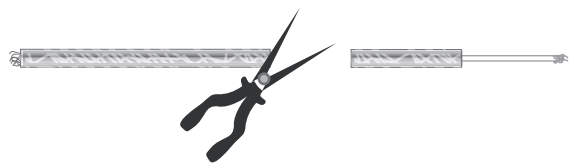

6. Once you've cut the cord to its desired length, it will look like picture A shown to the left. Peel back the braided jacket approx. 3/4" from the tip of the insulated center wire (Picture B).

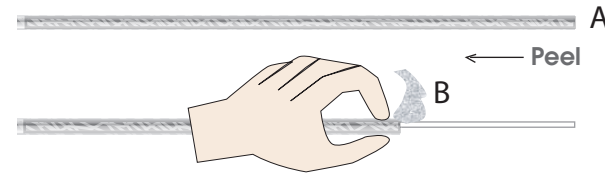

7. Cut off the excess braided jacket so that 3/4" of the insulated center wire is exposed. Strip no more than 1/8" off of the insulated center wire.

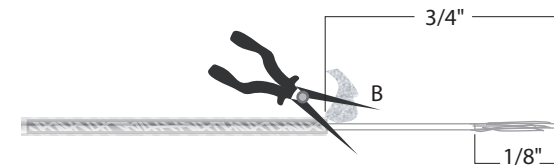

8. Twist the remaining braided jacket snugly around the center wire to ensure a clean insertion into the Quick Adapt connector.

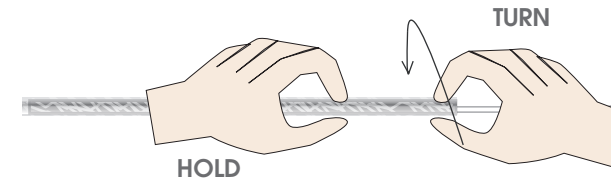

9. Reassemble the Quick Adapt connector by passing the cord through the retainer and sleeve first. Then insert the cord into the turn plug making sure that the foot of the plug covers the braided jacket. Turn the plug while inserting the cord for an easier insertion. Make certain you can see the center wire at the top opening A of the plug to ensure a good connection.

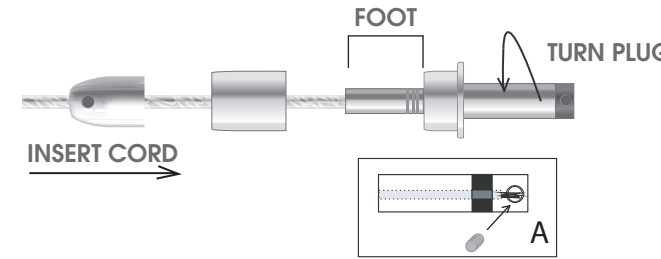

10. Again using the provided allen key, tighten screw A at the tip of the plug. Reattach the sleeve and retainer to the plug. Tighten screw B on at the retainer. Your Quick Adapt Pendant is now ready to attach to one of many mounting options in our Quick Adapt System.

