

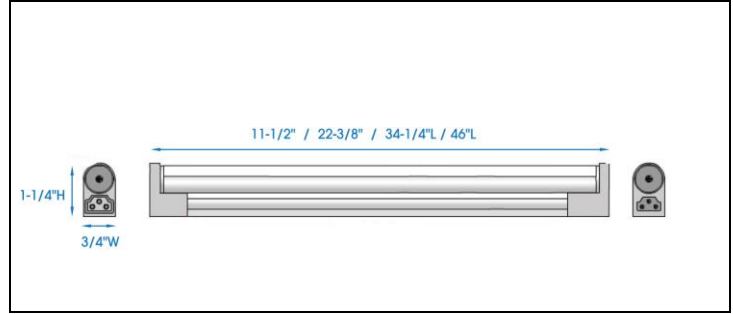

S201

COVE / CABINET / SHOWCASE / DISPLAY
LED SLEEK PLUS ADJUSTABLE

Type	
Project	
Catalog No.	



SPECIFICATIONS

Voltage	120V
Max Run	80 ft
CRI	82
Beam Angle	110°
Operating Temp *	0°F to 140°F
Lamp Life	50,000 hours
Housing	Aluminum
Environment	Dry
Certifications	ETL / RoHS
Finish	WH – White
Warranty	5 Years – see published warranty terms for detailed information.

* Exceeding the operating temperature values may damage the LEDs by reducing the lifespan, lumen output, adversely impact color consistency, and void the warranty. It is recommended adequate airflow and heatsinking be taken into consideration in the installation and application of this product. Improper thermal management may lead to premature product failure.

LUMEN DATA

Part Number	Watts	Color Temp	Lumens	Efficacy (lm/W)
S201-12	3.4	3000K	187	55
		4000K	200	59
		6000K	212	62
S201-24	6.5	3000K	401	62
		4000K	418	64
		6000K	434	67
S201-36	9.5	3000K	598	63
		4000K	624	66
		6000K	649	68
S201-48	14.3	3000K	978	68
		4000K	1012	71
		6000K	1045	73

Note : Not Dimmable

ORDERING INSTRUCTIONS

SERIES	LENGTH	COLOR TEMP	FINISH
S201	12 : 11-1/2 in 24 : 22-3/8 in 36 : 34-1/4 in 48 : 46 in	30 : 3000K 40 : 4000K 60 : 6000K	WH : White

Example: S201-12/30-WH



www.jescolighting.com
support@jescolighting.com
Tech Support: 855.592.0029

15 Harbor Park Drive
Port Washington, NY 11050
Main Line: 800.527.7796
Fax Line: 855.265.5768

219 South 6th Ave
City of Industry, CA 91746
Main Line: 855.654.0110
Fax Line: 626.333.2955

Rev 9
8/7/2014

Specifications subject to change without notice.



S201

COVE / CABINET / SHOWCASE / DISPLAY
LED SLEEK PLUS ADJUSTABLE

Type	
Project	
Catalog No.	

DESCRIPTION

- Low profile design with minimal footprint. LED SLEEK Plus features an adjustable light unit providing 45° rotation on either direction side to direct light where necessary.
- Direct replacement for Linkable Fluorescent T5 fixtures.
- S201 Linkable Fixtures may be interconnected end-to-end with Direct Connectors (SG-DC), or with connecting cables (SG-CC) offered in various lengths.
- Each fixture is furnished with (1) Direct Connector (SG-DC), and (2) Vertical Mounting Clips (SG-MC-V).
- Fixtures may be hardwired by using a Hardwire Box (SG-B or SG-BM) or plugged directly into standard wall outlet with a cord and plug (sold separately).
- Energy efficient fixtures consume only 3.5W per foot, significantly lowering operating costs.

WIRING DIAGRAM

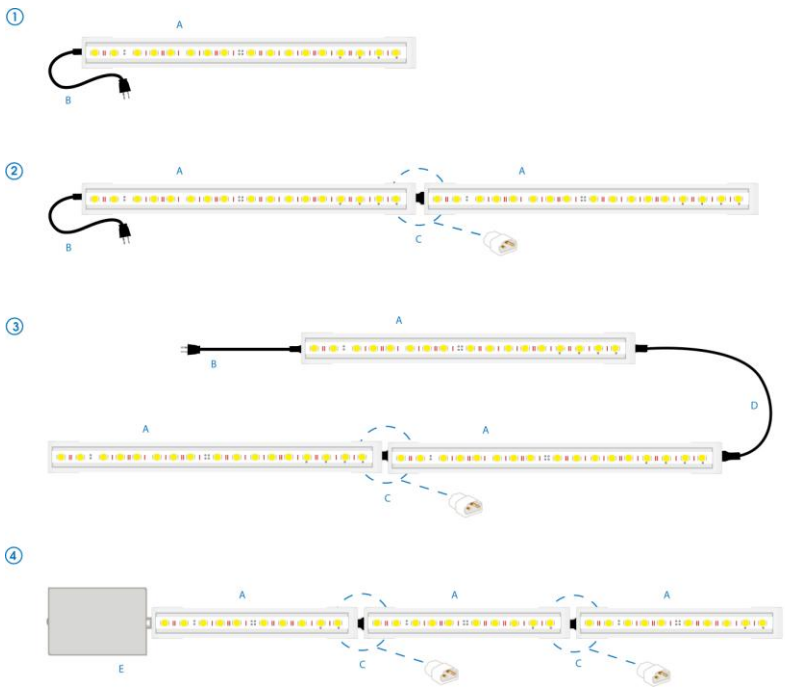

- A. S201-12/30/40/60
S201-24/30/40/60
S201-36/30/40/60
S201-48/30/40/60
- B. SG-PC24-W/72W/96W/144W
- C. SG-DC
- D. SG-CC6/12/24/36
SG-CC6L/12L/24L/36L
- E. SG-BM





S201

COVE / CABINET / SHOWCASE / DISPLAY
LED SLEEK PLUS ADJUSTABLE

Type	
Project	
Catalog No.	

ACCESSORIES & COMPONENTS

	Part Number	Description
	SG-CC6L SG-CC12L SG-CC24L SG-CC36L	Right Angle Connecting Cable 6" white 12" white 24" white 36" white
	SG-PCL SG-PCLL	Right Angle Power Cord & Plug 6" (From back) 6" (From front)
	SG-BM	Commercial Grade Metal Hard-Wire Box. Enables fixtures to be controlled by a wall switch. 2-3/4" L x 1-3/4" W x 1-3/4" H
	SG-DC	Direct connector for end-to-end connection. Each fixture is shipped with (1) direct connector.
	SG-MC-V	Stainless Steel Mounting Clip 0° vertical mount. (2) included with each fixture.
	SG-MC-45	Stainless Steel Mounting Clip 45° vertical mount. (2) included with each fixture.

	Part Number	Description
	SG-CC6 SG-CC12 SG-CC24 SG-CC36	Connecting Cable 6" white 12" white 24" white 36" white
	SG-PC24-W SG-PC72-W SG-PC96-W SG-PC144-W	Power Cord & Plug 2' white 6' white 8' white 12' white
	SG-BM-SW	Commercial Grade Metal Hard-Wire Box with Switch. Enables fixtures to be controlled by a wall switch. 3-1/2" L x 2" W x 1-1/8" H
	SG-B	Plastic Hard-Wire Box with Switch. Enables fixtures to be controlled by a wall switch. 3-5/8" L x 2-1/2" W x 1-3/8" H
	SG-MC-VH	Stainless Steel Mounting Clip 90° vertical mount. Vertical and horizontal mount.
	SG-MC-A	Stainless Steel Mounting Clip Adjustable.