

JAMES MARTIN

VANITIES

Installation Instructions for 3cm Countertops with Integrated FreePower Wireless Charging Device and Undermount Sinks

(Models: 050-S48, 060-S48, 050-S60S)

FP FREEPOWER

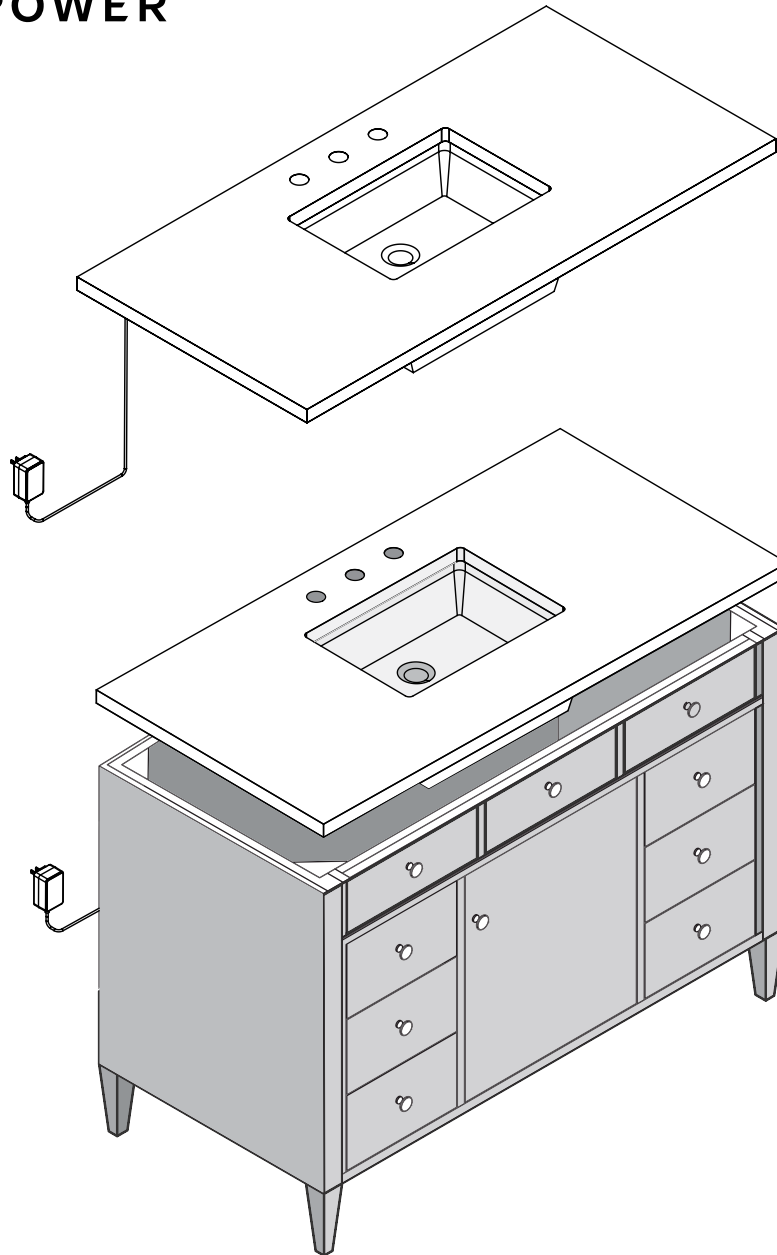

BEFORE YOU REMOVE THE TOP FROM THE CARTON

Prior to removing the countertop from the carton, inspect the carton for damage and package contents.
If any damage is found, contact your place of purchase.

Products shown in this manual do not reflect a specific vanity or sink.

Installation Instructions for 3cm Countertops with Integrated FreePower Wireless Charging Device and Undermount Sinks

IMPORTANT STEPS BEFORE YOU BEGIN

- For your safety and to achieve the best possible results, James Martin Vanities recommends you consult with a professional contractor.
- Ensure the vanity cabinet is in place and has been properly installed to meet plumbing codes.
- Identify location of 120V 12A 60 Hz GFCI wall outlet (1) and create an opening in the back panel of the vanity for access to power outlet (2). Opening should be large enough to line up with power outlet or at least large enough for plug-in to pass through.
- Shut off the water supply. Water supply and drain access must be in place prior to installing the countertop and sink.
- Ensure the vanity cabinet is level.

1. Locate GFCI power outlet

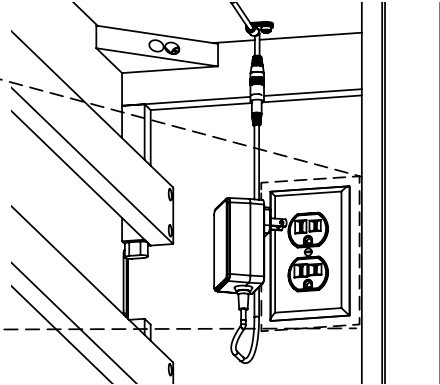
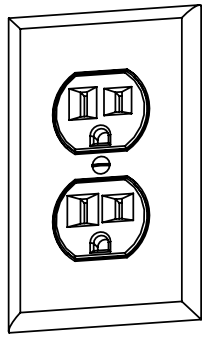

2. Cut an opening in the back of the vanity

Power Adaptor Supply Dimension: 1-7/8" W x 1-5/8"D x 3" H

TOOLS AND MATERIALS: (Not included)



Level

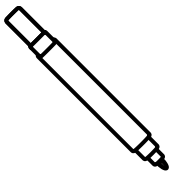

Marker

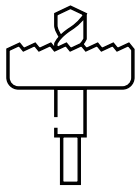

Hole Drill Saw

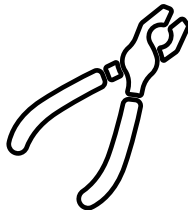

Pliers

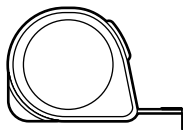

Tape Measure

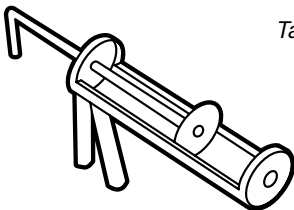

Caulk Gun

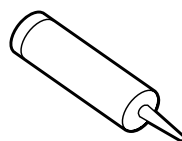

Silicone Sealant

PROPER HANDLING OF 3CM COUNTER TOP

IMPORTANT: The countertop is very fragile. Take caution when handling, and have someone assist you.

- Carefully unpack the countertop and place finished side down on flat, soft and sturdy surface.



Rotate carton from flat position and lift top vertically.

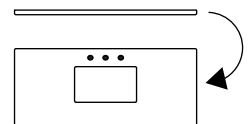

Lift top vertically with two people.

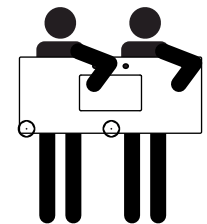

Never lift or carry the vanity top flat.

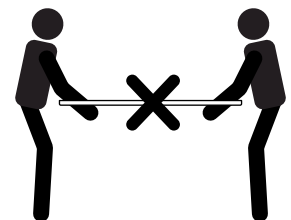

**Installation Instructions for 3cm Countertops with
Integrated FreePower Wireless Charging Device and Undermount Sinks**

COUNTERTOP CARTON CONTENTS

A

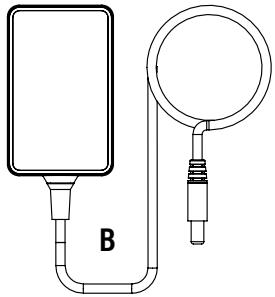
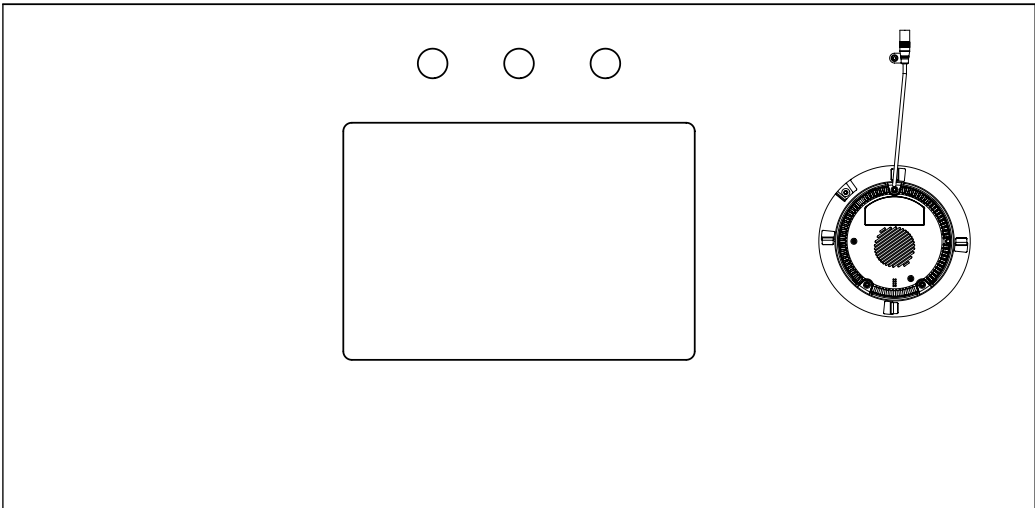

PLEASE NOTE: The drawing represents the underside of the countertop. Once turned over for installation, the charging device will be on the left side.

Part	Description	Quantity
	Assembly Instructions • FreePower Specifications* and User Guide	1 ea.
A	3cm Countertop with Preinstalled FreePower Wireless Charging Device	1
B	Power Supply for FreePower Wireless Charging Device	1
C	Set screw	4
D	Sink clamp	4
E	Washer	4
F	Lock washer	4
G	Wing nut	4

SINK MOUNTING HARDWARE

(Included)

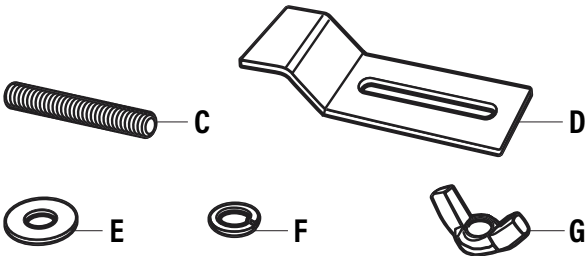

* Refer to FreePower Specification sheet for further information.

SINK CARTON CONTENTS

(Sink(s) ship in a separate carton)

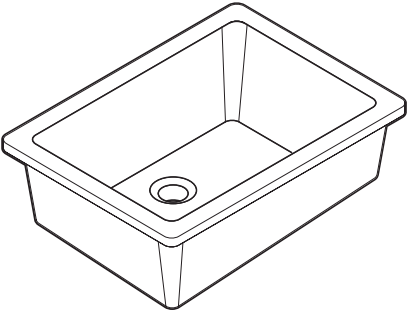

Installation Instructions for 3cm Countertops with Integrated FreePower Wireless Charging Device and Undermount Sinks

Products shown in this manual do not reflect a specific vanity or sink.

SINK INSTALLATION

IMPORTANT: Make sure all surfaces are clean. Place top finished side down on a soft surface.

1. Using a tape measure, draw a straight 3" line marking the center points of all sides of the sink cut out.

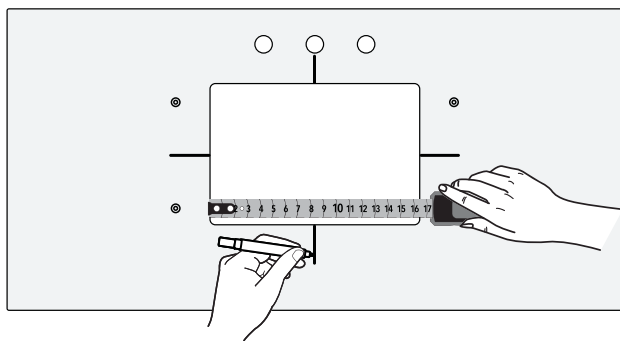

2. Carefully unpack the undermount sink and place on a soft surface, underside of bowl facing up. Using a tape measure, identify and mark center point on all sides of the bottom and profile of the lip of the sink.

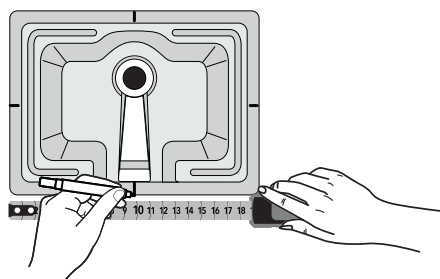

3. Carefully lift the sink and place it centered over the countertop cutout, underside of bowl facing up and with the overflow drain at the opposite end from the faucet holes. Align all marked center points along each side of the lip of the sink, with the marked center points along cut out in the countertop. Ensure the sink is centered over the opening and carefully trace around the perimeter of the sink with a marker.

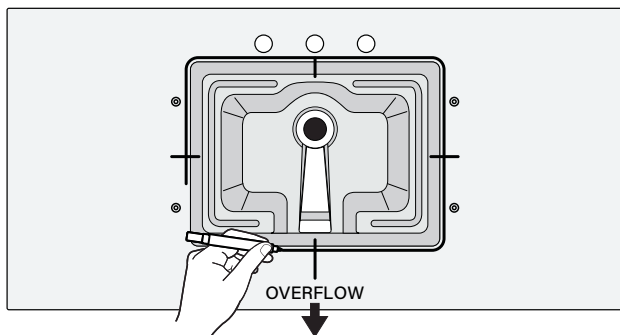

4. Carefully lift the sink from the countertop and place it on a soft surface, bowl side down. Apply a bead of silicone sealant around the top edge of the sink rim.

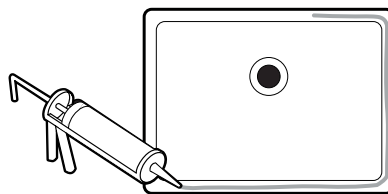

5. Carefully lift and turn the sink over on the countertop, positioning it within your marked outline, ensuring again that the overflow is opposite from the faucet holes. Once positioned, press firmly in place.

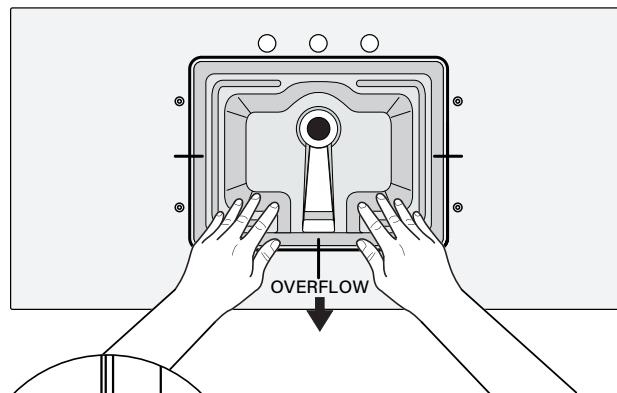

6. Wipe away any excess sealant. To ensure proper adhesion, and for added stability, apply the sink clips before allowing the sealant to dry.

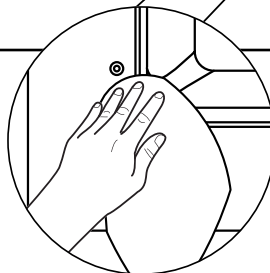

7. Attach sink clips by placing the contoured end of the bracket against the sink lip, aligning the open, notched area over the threaded inserts. The bracket will be at a slight angle, and the angle will vary depending on the thickness of the sink lip. Insert the set screw. Allow sealant to dry as indicated by manufacturer. Although the sealant is what secures the sink to the top, we suggest keeping the clips in place after installation.

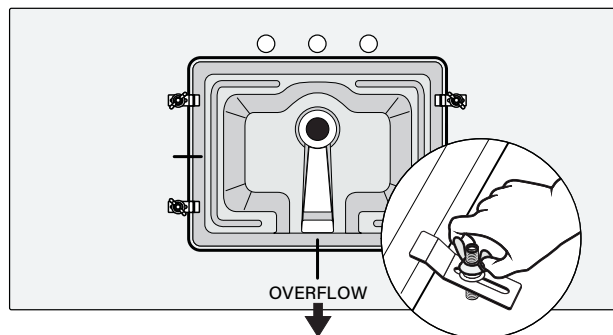

Installation Instructions for 3cm Countertops with Integrated FreePower Wireless Charging Device and Undermount Sinks

PREPARING THE VANITY CABINET FOR INSTALLATION OF THE COUNTERTOP AND SINK

IMPORTANT: Make sure all surfaces are clean.

8. Apply an adhesive around the top edge of the vanity cabinet. Add an extra dot on all 4 corners of the vanity top.

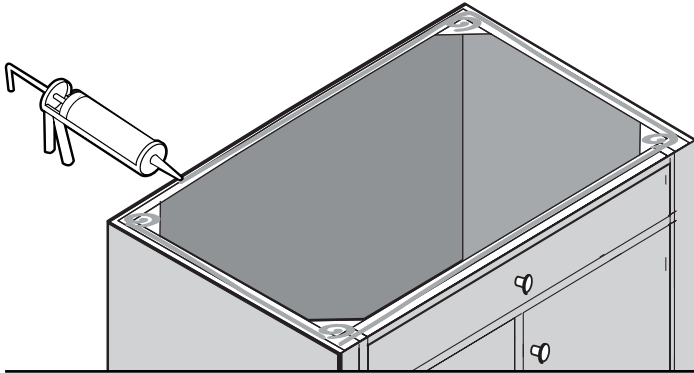

IMPORTANT: The countertop is very fragile. Take caution when handling, and have someone assist you.

9. With assistance from another person, carefully lift the countertop with sink to a vertical position and ease onto the vanity cabinet, front edge first.

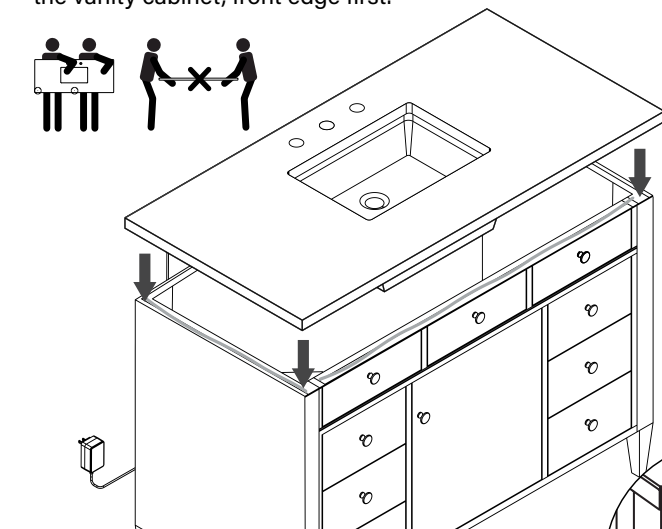

10. Once positioned, press firmly into place. Wipe away any excess sealant using a damp cloth.

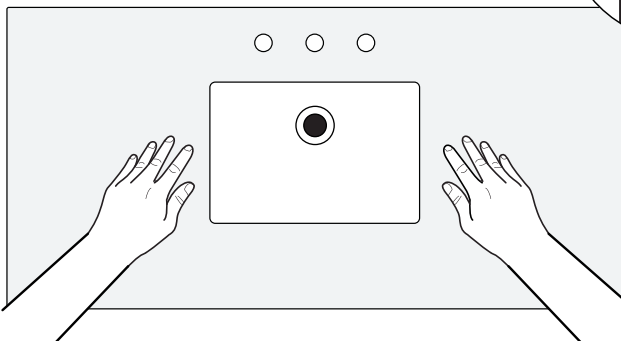

CONNECTING THE FREEPOWER DEVICE TO THE POWER SOURCE

IMPORTANT: Plug the Power Supply into the GFCI power source before attaching the barrel jack connector to the power supply to the FreePower device.

11. Plug in the Power Supply Cord into the GFCI Wall Outlet through the access opening created at the beginning of the the installation process.

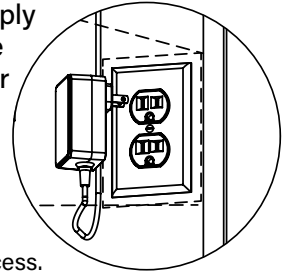

12. Attach the barrel jack connector to the power supply to the FreePower device.

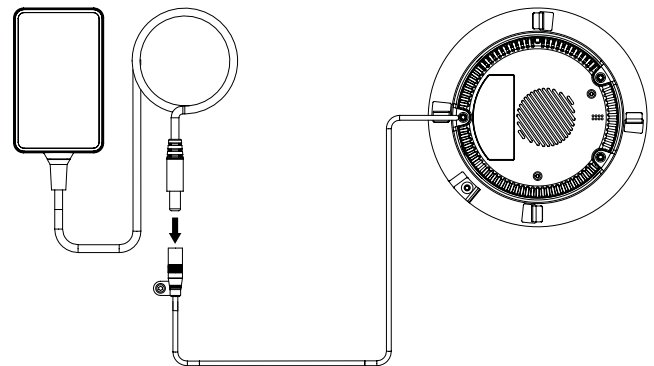

INSTALLING AN OPTIONAL BACKSPLASH

13. If you are installing a backsplash (available on specific models), place a generous amount of silicone sealant on the back of it and press it into place against your bathroom wall. Fill any gaps that are left with silicone sealant. Wipe away any excess sealant with a damp cloth.

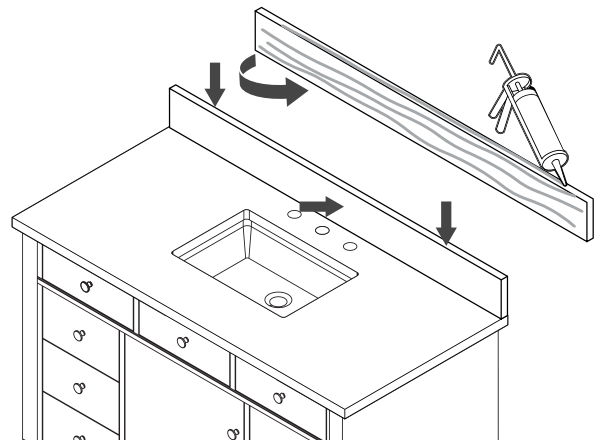

14. Once assembled, allow the silicone sealant to fully dry according to the manufacturer's recommendation. When dry, proceed to the installation of your faucet and drain. Refer to the Spec Sheets for Use and Care instructions. Refer to FreePower User Manual for wireless charging device operation instructions.