



SHOWERHEAD INSTALLATION GUIDE

Jacuzzi Item / #ST04826-BN / ST04827-CP
 #ST05826-BN / ST05827-CP
 #ST06826-BN / ST06827-CP

Questions, problems, missing parts? Before returning to your retailer, call our customer service department at 1-800-288-4002, 9 a.m. - 5 p.m., EST, Monday - Friday.

ATTACH YOUR RECEIPT HERE

Purchase Date _____

CAUTION-TIPS FOR REMOVAL OF OLD SHOWERHEAD:

Always turn off water supply before removing existing showerhead or replacing any part. Open the valve handle to relieve water pressure and ensure that water is completely shut off.

CARE INSTRUCTIONS:

To preserve the finish of your showerhead, apply non-abrasive wax. Any cleaners should be rinsed off immediately. Do not use abrasive cleaners on the showerhead.

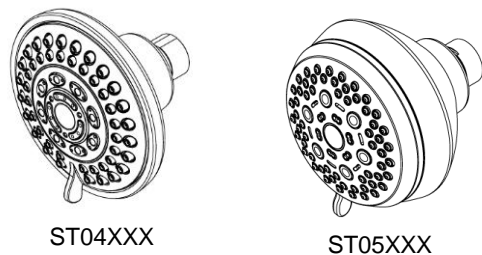

ST04XXX

ST05XXX

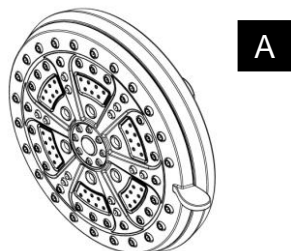

ST06XXX

PACKAGED CONTENT

PART	DESCRIPTION	QUANTITY
A	Showerhead	1

SAFETY INFORMATION

Please read and understand this entire manual before attempting to assemble, operate, or install the products.

WARNING:

- Follow the installation instructions carefully. Proper installation is the installer's responsibility.
- Failure to follow correct installation procedures can result in the showerhead being loose, which can result in serious injury.

CAUTION:

- Check local building codes before beginning installation to ensure compliance.

Tools Required for Assembly



Thread Sealant Tape



Wrench

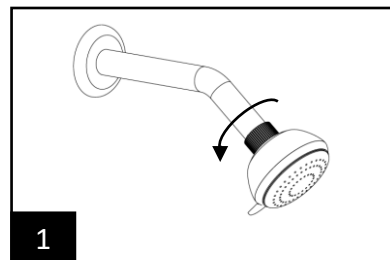

1

Remove the old showerhead from the existing shower arm by turning the ball joint counterclockwise.

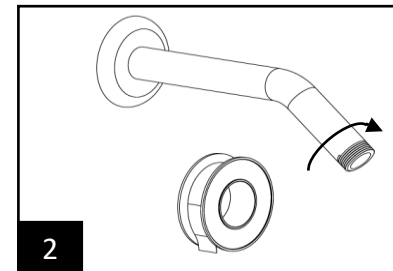

2

Apply thread sealant tape in a clockwise direction to the open end of the shower arm.

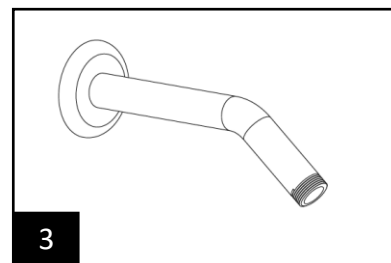

3

Flush the lines without the showerhead to remove debris before installing showerhead.

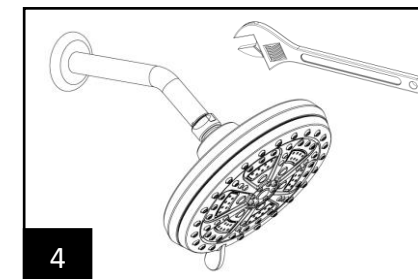

4

Carefully use a wrench on the thread flats of the ball joint to tighten. Do not overtighten.

Meets ASME A112.18.1M Requirements 1.8gpm (6.8L/min) Max, 1.35gpm (5.1L/min) Min at 45psi

TROUBLESHOOTING

PROBLEM	POSSIBLE CAUSE	CORRECTIVE ACTION
Uneven water flow	Water nozzles are blocked with mineral build-up or debris	Gently rub easy clean nozzles with fingertip to remove any mineral build-up or debris
Low water flow	Mineral build-up or debris have clogged the screen in the ball joint	Rinse the mineral build-up or debris from the screen