



Elara® Plus Technical Specifications

Letter	Description	7959
-	Drain Location	Center End Drain
-	Pump Location	(Zone 1) Right Hand, (Zone 2) Left Hand
-	Cutout Template	N/A
-	Drop-in Cutout Dimensions (L x W)	77" x 57" (1473 mm x 1016 mm)
-	Total Weight	1537 lbs (697 kg)
-	Floor Loading	54 lb/ft ² (264 kg/m ²)
-	Product Weight	300 lbs (136 kg)
-	Operating Gallons	123 gal (466 Liters) min. / 148 gal (560 Liters) max.
-	Soaking Depth	16" (406 mm)
L	Outer Length	79" (2007 mm)
W	Outer Width	59" (1499 mm)
H	Overall Height	25.50" (648 mm)
A	Overflow Height	19.0" (483 mm)
B	Long Edge to Drain Center	39.50" (1003 mm)
C	Short Edge to Drain Center	10.50" (267 mm)
D	Drain Shoe Length	10" (254 mm)
E	Deck Height	2.0" (51 mm)
F	Deck Width*	4.375" (112 mm)
G	Service Access Dimensions	12" x 18" (305 mm x 457 mm)
I	Floor Cutout for Drain	15" x 4" (381 mm x 107 mm)
J	Interior Dimensions (top of bath) JW x JL	46.25" x 45.50" (1175 mm x 1155 mm)
K	Interior Dimensions (bottom of bath) KW x KL	50.25" x 69" (1276 mm x 1156 mm)
L2	Interior Depth- Drain End	21.5" (546 mm)
M	Backrest Angle	37°

Each Zone requires a separate, dedicated GFCI protected circuit

Model with components		GFCI Outlet (60Hz)
Whirlpool	Motor/Pump (Zone 1)	120V/15A
	Motor/Pump (Zone 2)	120V/15A

Drain Kit Included:

HP55827- Rotary Drain Kit

Standard Features Include:

28 Jets, Whisper + Motor Pump (2x), Chromatherapy Lighting, 1 Neck Messaging Waterfall, 3 Pillows, Chrome Rotary Drain, Lounge Seating, J4 Luxury Control Panel
Available Upgrade: J5 Luxury LCD Control Panel (2x)

KEY DIMENSIONS* [NOTE: The overall dimensions are nominal with a tolerance of +0 and -.25" (6mm).]

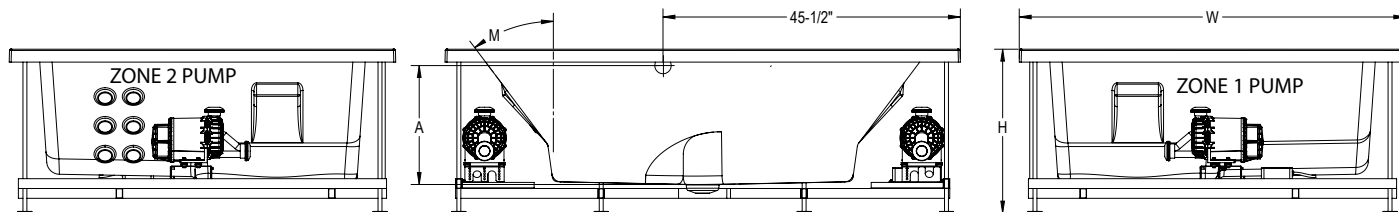
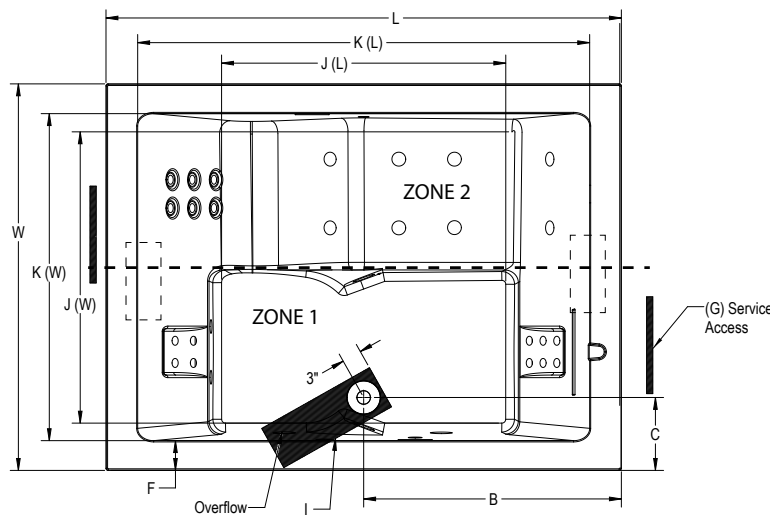

Refer to installation instructions included with fixture before beginning installation. Please confirm product availability and specifications before commencing with any installation work.

PRODUCT SPECIFICATIONS AND AVAILABILITY ARE SUBJECT TO CHANGE WITHOUT NOTICE