

Mounting Adaptor (#11599-H)

This adaptor will fit a sink opening of: 6-5/8" I.D.
and NO FLANGE with raised bead

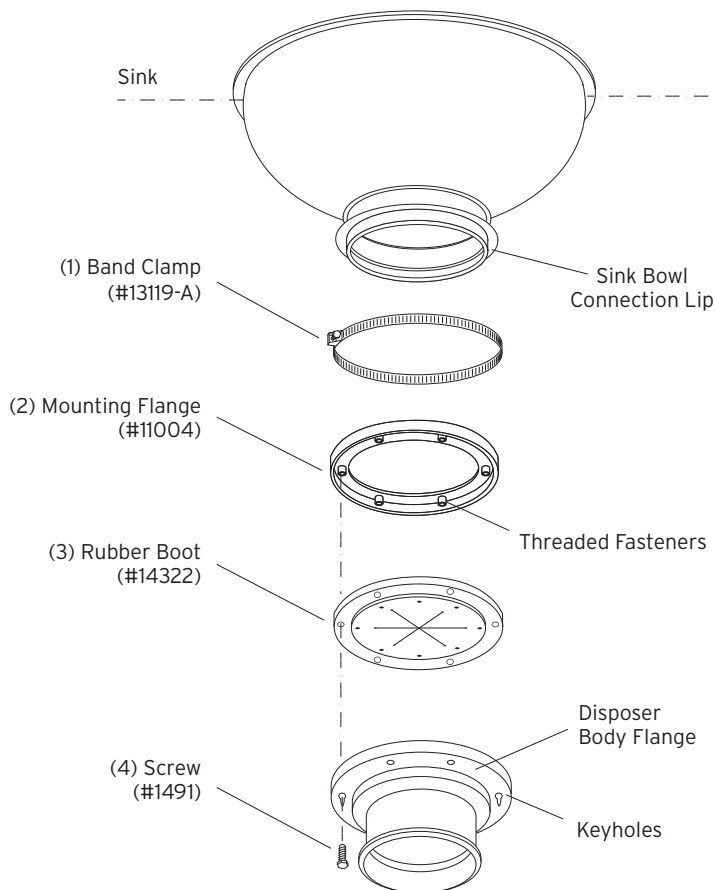

Installation Instructions

1. Place black rubber boot (3) into mounting flange (2), pushing upper (or smaller) half of rubber boot (3) through mounting flange (2), and aligning threaded fasteners with holes in the boot (3).
 2. Place rubber boot (3) and mounting flange (2) into disposer flange and align holes. Insert six screws (4) from the underside of the disposer flange and tighten all screws until both flanges touch.
 3. Place band clamp (1) around the outside of rubber boot (3) and mount disposer/adaptor assembly to sink bowl. Adjust disposer legs to proper height so groove in rubber boot (3) engages groove on sink bowl.
- NOTE:** Disposers from 3 H.P. through 10 H.P. have factory assembled legs. Disposers from 1/2 H.P. through 2 H.P. require two accessory legs.
4. Tighten band clamp (1) around the rubber boot (3) until snug.

IMPORTANT: Ensure band clamp fits under the lip of the rubber boot (3).