



The Pop Down® Sink Drain

WWW.ICOBATH.COM

Standard Installation

Note: This waste fits sinks WITH or WITHOUT over-flow. This drain fits BOTH types of sinks.

- 1 CALMA recommends installation a by Licensed Plumber
- 2 Check that sink drain opening is 1-5/8" minimum diameter and that the flange sits neatly in sink drain recess

- 3 Apply non-staining sealant to underside of FLANGE (B) sufficient to contact and seal well
Neutral cure silicone sealant is also okay. WARNING: Oil-based Plumbers Putty may react with some finishes

- 4 Place FLANGE (B) with sealant into sink opening and check that flange/sink seal is good

- 5 THICK SINKS: Use only one RUBBER WASHER (C)

THIN SINKS: Use 2 RUBBER WASHERS (C) on either side of SPACER (D), as shown. Be sure washers are seated correctly

- 6 Carefully screw BODY (E) on to FLANGE (B) from underside of sink. Make sure RUBBER WASHER (C) is correctly seated in the recess on top of lower body. Do not over-tighten. Use rubber-safe lubricant if needed.

**Installation Trick: If the bottom of the sink is a very coarse/rough casting, apply a small bead of silicone to the top of the RUBBER WASHER (C) to seal sink manufacturer's voids and thus create an effective seal.

- 7 Attach TAIL PIECE (H) to BODY (E) with NUT (G) and TAIL PIECE WASHER (F) in order shown

- 8 TAIL PIECE (H) may need to be trimmed to suit balance of waste system . P-trap and drain accessories not included

- 9 Install Cartridge (A). Drain is open when flush and closed when down

- 10 OPTIONAL: Override mechanism (A) to prevent closure with included c-clip, simply clip-on to base of mechanism

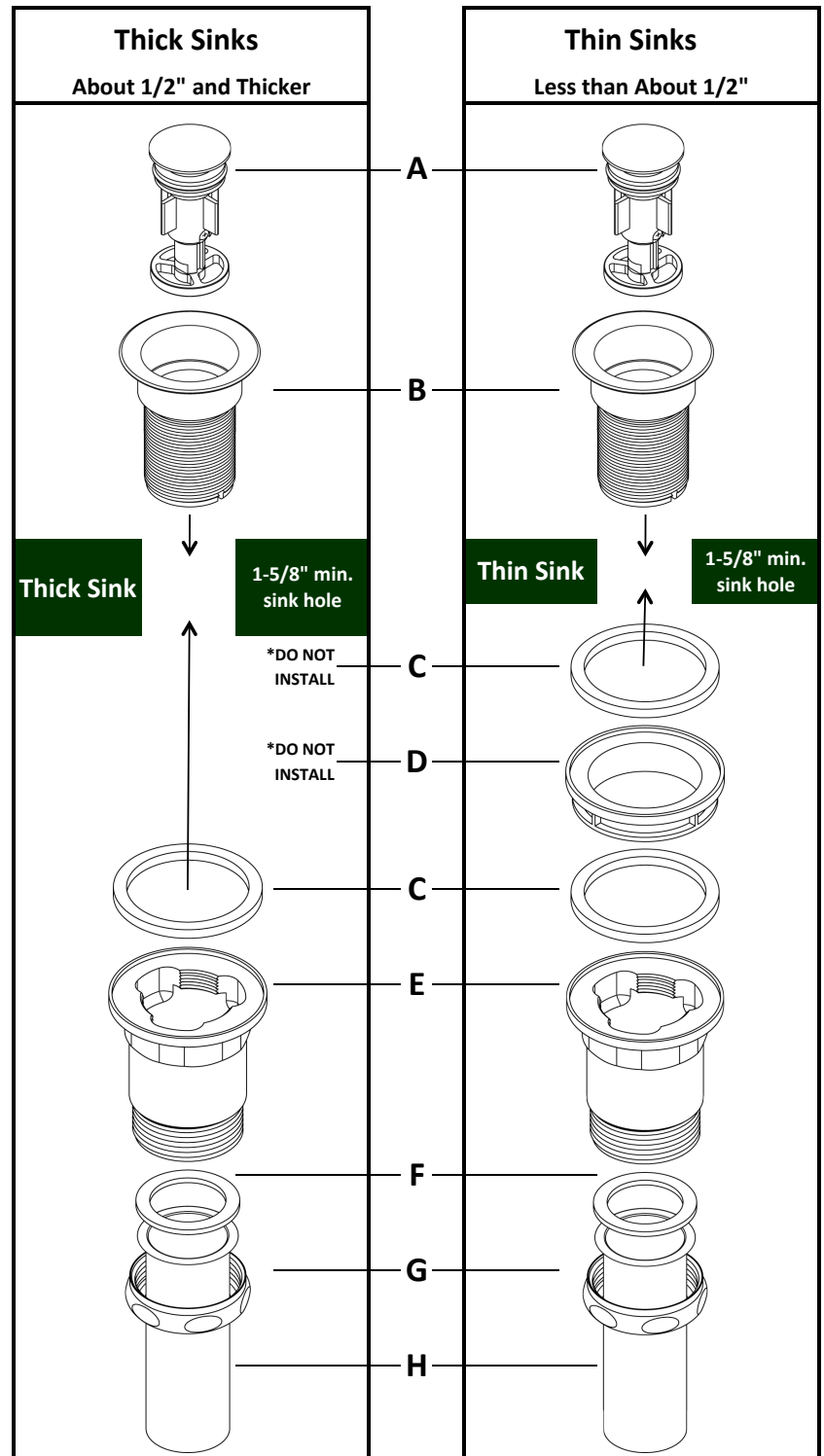

Drawings not to scale

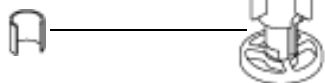

REVISÉD: 21-Apr-17

BBUX71310

© 2017



The Pop Down® Sink Drain

WWW.ICOBATH.COM

Installation with accessory Extension for extra-thick sinks (only)

Stack our Extensions to suit virtually any sink thickness (sold separately)

- 1 CALMA recommends installation a by Licensed Plumber
- 2 Check that sink drain opening is 1-5/8" minimum diameter and that the flange sits neatly in sink drain recess
- 3 Apply non-staining sealant to underside of **FLANGE (B)** sufficient to contact and seal well
Neutral cure silicone sealant is also okay. **WARNING:** Oil-based Plumbers Putty may react with some finishes
- 4 Place **FLANGE (B)** with sealant into sink opening and check that flange/sink seal is good
- 5 Use **EXTENSION(s) 29356** to achieve virtually any sink depth. Apply Teflon thread tape to bottom of **FLANGE (B)** and screw in to top of **EXTENSION**. Your custom installation may require the use of **RUBBER WASHER (C)** and **SPACER (D)**
See *ALTERNATE exploded view; far right column
- 6 Carefully screw **BODY (E)** on to **FLANGE (B)** from underside of sink. Make sure **RUBBER WASHER (C)** is correctly seated in the recess on top of lower body. Do not over-tighten
Installation Trick: If the bottom of the sink is uneven or is a very coarse/rough casting, apply a small bead of silicone to the top of the **RUBBER WASHER (C) to seal sink manufacturer's voids and thus create an effective seal
- 7 Attach **TAIL PIECE (H)** to **BODY (E)** with **NUT (G)** and **TAIL PIECE WASHER (F)** in order shown
- 8 **TAIL PIECE (H)** may need to be trimmed to suit balance of waste system . P-trap and drain accessories not included
- 9 Install **Cartridge (A)**. Drain is open when flush and closed when down
- 10 **OPTIONAL:** Override mechanism (A) to prevent closure with included c-clip, simply clip-on to base of mechanism

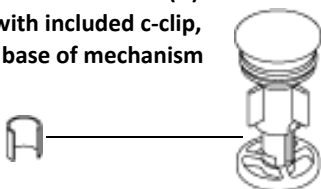
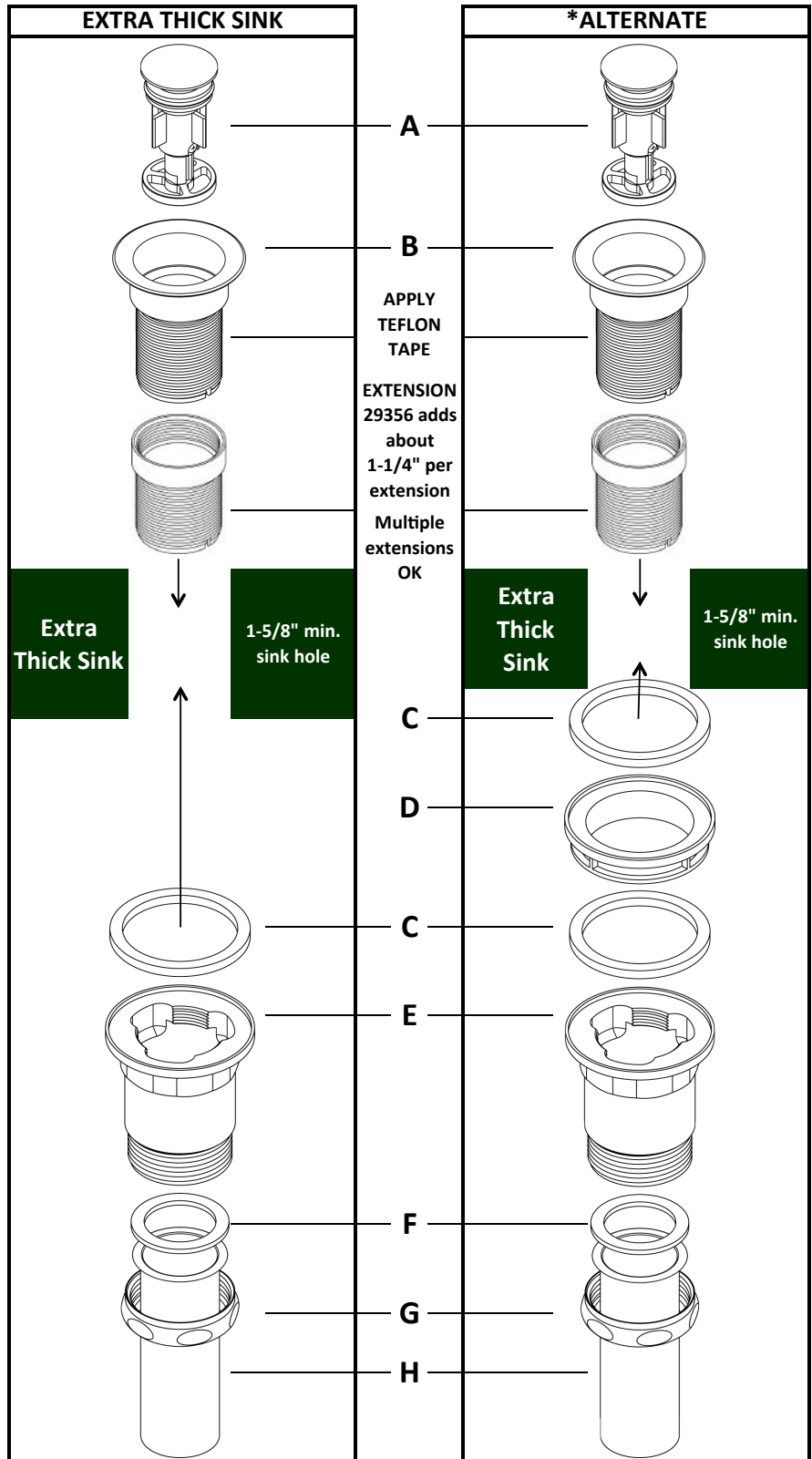

Drawings not to scale

C

REVISED: 21-Apr-17

BBUX71310

© 2017