

Soft Contemporary 3-Bulb Light Kit Installation Instructions



IMPORTANT: Read all warnings before you begin.

⚠ CAUTIONS

- Read entire installation instructions carefully before beginning installation and save these instructions.
- To avoid possible risk of electrical shock and fire, install this light fixture only on listed Hunter ceiling fan model numbers 28420, 28421, 28422, 28445, 28448, and 28449. Find the fan model number on the ceiling fan package or on the nameplate on top of the motor housing of the ceiling fan.

⚠ WARNINGS

- To avoid possible electrical shock, before installing light fixture disconnect power by turning off the circuit breakers both to the outlet box and to its associated wall switch location. If you cannot lock the circuit breakers in the off position, securely fasten a prominent warning device, such as a tag, to the service panel.
- Connect house wiring to the fan before attaching the light fixture to the fan.
- All wiring must be in accordance with national and local electrical codes. If you are unfamiliar with wiring, you should use a qualified electrician. Professional installation is recommended.
- To reduce the risk of fire or personal injury, allow bulbs and surrounding surfaces to cool to room temperature before touching or removing them.

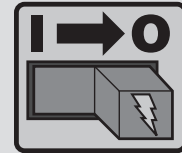

Install this light fixture only on listed Hunter ceiling fan model numbers
28420, 28421, 28422, 28445, 28448, and 28449.

This light fixture weighs 5.98 pounds.

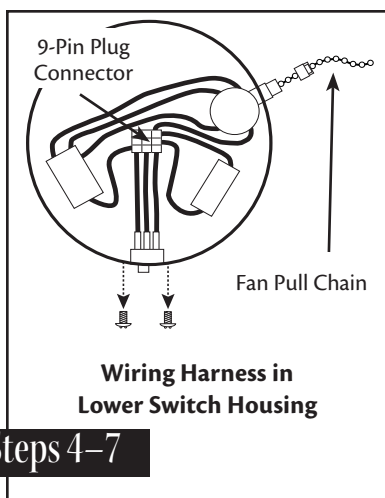
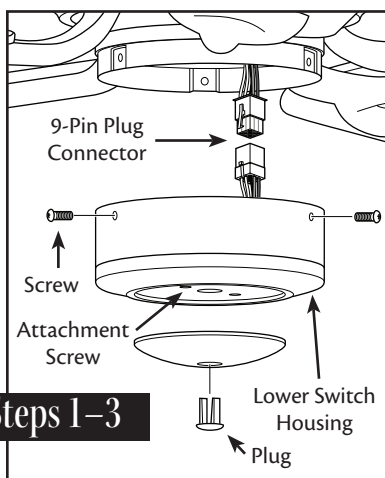
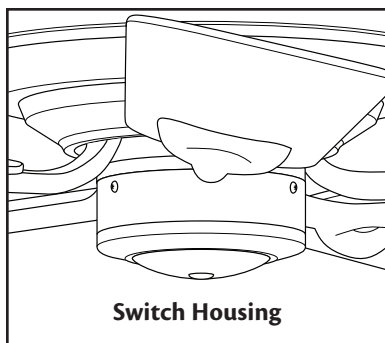

Preparing the Light Kit for Installation

1. Disconnect power to the ceiling fan by turning off the circuit breakers both to the outlet box and to any associated wall switch locations.
 2. Unscrew the three screws from the upper switch housing. Disconnect the 9-pin plug connectors. Remove the lower switch housing.
 3. Unscrew the two attachment screws on the bottom of the switch housing. Push the plug from inside the lower switch housing to remove the plug and switch housing cap.
- NOTE:** Save the plug button and switch housing cap should you choose to remove the light fixture in the future.

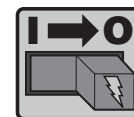

Removing the Wiring Harness from the Lower Switch Housing

Before installing the light fixture, remove the wiring harness and its components from the fan's lower switch housing. Then install the wiring harness into the light fixture.

4. Locate the reversing switch and carefully remove the two screws holding the reversing switch to the lower switch housing. Remove the reversing switch.
5. Remove the patented breakaway connector from the fan pull chain.
6. Carefully loosen the bellmouth nut from the fan pull chain and remove the fan pull chain switch from the lower switch housing.
7. Locate and carefully remove the two capacitors from the lower switch housing.

You have now disconnected the wiring harness and its components from the lower switch housing.

Installing the Wiring Harness into the Light Fixture

8. Insert the fan pull chain switch through the round opening on the side of the light fixture switch housing. Thread the bellmouth nut over the pull chain and hand tighten the nut securely.
9. Reattach the patented breakaway connector to the end of the pull chain.
10. Insert the reversing switch into the square hole on the side of the light fixture switch housing. Install and tighten the two screws you removed previously from the fan switch housing.
11. Carefully place the capacitors in the light fixture switch housing.

You have now installed the wiring harness and its components in the light kit.

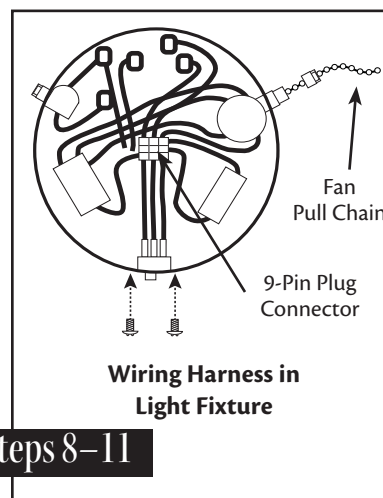

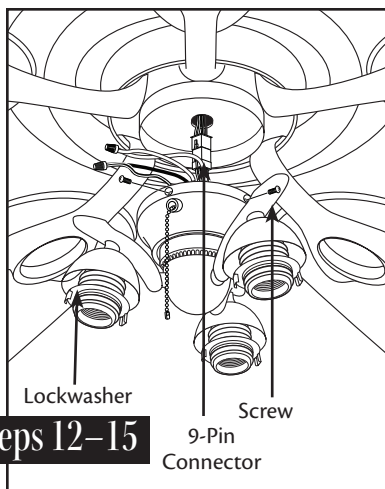

12. Using the wire nuts currently on the single black wire and single white wire, connect the black wire from the light fixture to the black/white wire from the wiring harness. Connect the white wire from the light fixture to the white wire from the wiring harness.

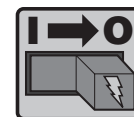

13. To connect the wires, hold the bare metal leads together and place a wire nut over them, then twist the wire nut clockwise until tight.

⚠ CAUTION: Be sure no bare metal wires or wire strands are visible after making the connections.

14. Reconnect the 9-pin plug connector.
15. Install screws to reattach the lower switch housing to the upper switch housing.

Installing Globes and Bulbs

16. Remove the lockwashers from the light sockets.
17. Place the lip of the globe into the cup and tighten the lockwasher onto the socket until the globe is secure.
18. Install three 60-watt maximum (Type B-10) candelabra bulbs into the sockets.
19. The installation is complete and you can restore power to the ceiling fan.

Hunter Fan Company
2500 Frisco Avenue
Memphis, Tennessee 38114

Troubleshooting

Light does not come on.

1. Make sure bulbs are installed properly and filament is not blown.
2. Make sure breakers or fuses are on.
3. Verify that the light power lead is connected at the ceiling. Refer to your ceiling fan manual for locating assembly and wiring.

Glass rattles.

1. Make sure the glass globe is secure.

For other problems or questions, contact the
Hunter Fan Company Technical Support at
US 888-830-1326 / Canada 866-268-1936.

<http://www.hunterfan.com>

