

# ASSEMBLY AND SAFETY INSTRUCTION

## Q150 QUARTZ HALOGEN SECURITY LITE

### SAFETY PRECAUTIONS

1. Do not mount the body of this fixture within one inch of any combustible material
2. Do not mount in a closed room or boxed-in location where air cannot circulate around the fixture. The normal operating temperature of a quartz halogen fixture is very high and requires free air circulation so the fixture will not over heat.
3. Turn off power before installation and servicing. Before installing consult local electrical codes for wiring and grounding requirements.
4. For use with 120 volts only.
5. Do not look directly at lighted lamp.

Fig. 1

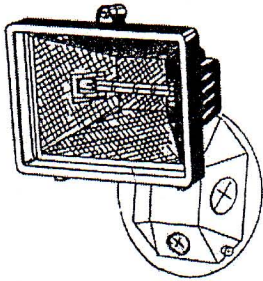

Mounting Plate (Not Included))

Fig. 2

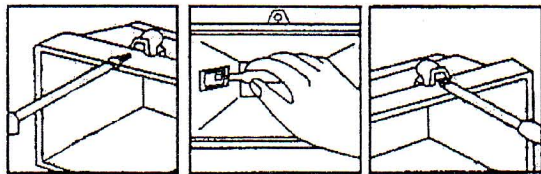
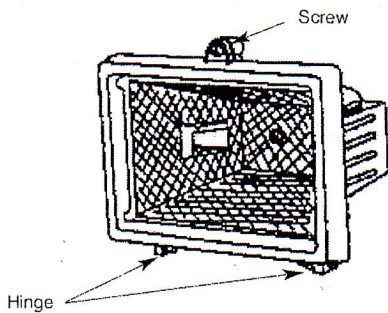

### INSTALLATION:

1. This unit operates on regular household power. ( 120V. 60Hz )
2. Fixture is supplied with two leads of 18AWG, SF-2 wires six inches long. Connect one to black service wire and other to white service wire, using wire nuts, crimp-on lugs or other approved device. Make sure connections are secure and no loose wire strands are sticking out of connector. Then, connect fixture ground wire to house ground wire for grounding requirement.

### AIMING:

1. Rotate fixture horizontally to illuminate the desired area. Make Sure that the bulb in the fixture is no more than 4 degrees from Level horizontally for maximum bulb life.
2. Set the vertical aiming by loosening bolt at the pivot. Aim fixture At desired angle and securely re-tighten bolt. Apply silicone Sealant on the following location for raintight.
  - A. Elbow screw.
  - B. Elbow joint.
  - C. Thread plug.
  - D. Cover and junction box joints.

### INSTALLING BULB & SERVICING

1. Loosen the screw to release glass shield.
2. Using a clean cloth or paper to protect the T -3 bulb from your Bare hands, fit the T - 3 bulb into the right hand spring loaded Socket and push towards it. Make sure that each of the bulb Is securely seated against the socket contact.
3. Replace glass shield with screw(s), fully closed.

### TROUBLE SHOOTER - CHECK LIST

#### IF LIGHT DOES NOT WORK:

- Check Your Power Source.
- Check Electrical Connections.
- Check To Insure Proper Seating Of Lamp.
- Check If Lamp Filament Burned Out.

Hubbell Outdoor Lighting • 101 Corporate Drive • Spartanburg, SC 29303 • PHONE: 864-599-6000

For more information visit our website: [www.hubbell-ltg.com](http://www.hubbell-ltg.com)



®

Outdoor Lighting