

Family: Quebec | Item No. 1290 IB

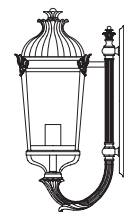

Drawing 1 - Strap Detail

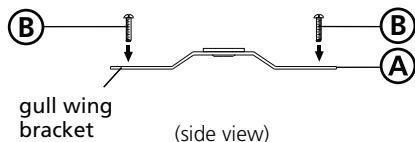

Drawing 2 - Fixture Mounting

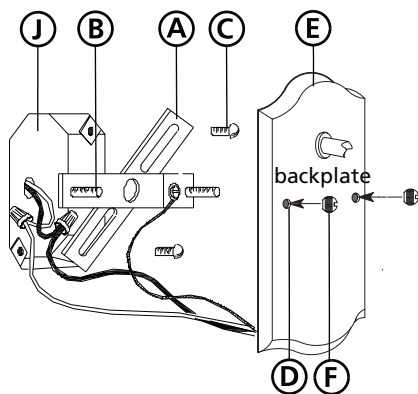

Drawing 3 - Glass Installation

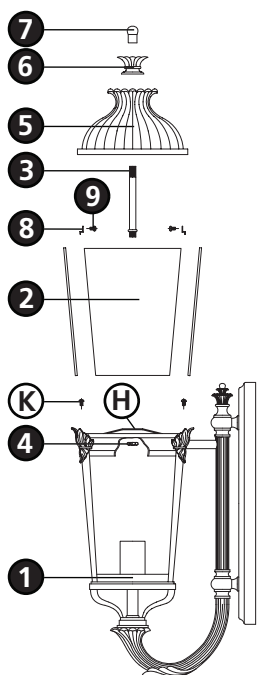

▼ start here

1

1. Find a clear area in which you can work.
2. Unpack fixture and glass from carton.
3. Carefully review instructions prior to assembly.

***** The construction of this fixture will be accomplished by first installing the mounting strap, assembling the fixture, making all necessary electrical connections, and then mounting the fixture.**

2

1. Prepare mounting strap **(A)** by threading the two 1 1/4" long mounting screws **(B)** into the back of the gull wing bracket - see **Drawing 1**.
 - Be sure the holes into which the screws are threaded match the spacing of holes **(D)** in the back plate **(E)** - see **Drawings 1 and 2**.
2. Attach mounting strap **(A)** to junction box **(J)** using two 1" screws **(C)** - see **Drawing 2**.

3

1. To assemble fixture, remove cross bar **(H)** by removing screws **(K)** with a Phillips screw driver - see **Drawing 3**.
2. Remove glass clips **(8)** from inside cage assembly **(1)** by removing screw **(9)** with a Phillips screwdriver.
3. Slip glass panels **(2)** into cage assembly **(1)**.
4. Replace glass clips **(8)** and screws **(9)**.
5. Slip center stem **(3)** into center hole of bracket **(H)** removed earlier and secure it with hex nut **(4)**.
6. Fixture can now be lamped accordingly.
7. Slip roof **(5)** onto center stem **(3)** and down onto cage assembly **(1)**.
8. Slip break **(6)** onto center stem **(3)**.
9. Thread knob **(7)** onto end of center stem **(3)** to secure roof.

SAFETY WARNING: READ WIRING AND GROUNDING INSTRUCTIONS (I.S. 18) AND ANY ADDITIONAL DIRECTIONS. TURN POWER SUPPLY OFF DURING INSTALLATION. IF NEW WIRING IS REQUIRED, CONSULT A QUALIFIED ELECTRICIAN OR LOCAL AUTHORITIES FOR CODE REQUIREMENTS.

4

Make electrical connections from supply wire to fixture lead wires. Refer to instruction sheet **(I.S. 18)** and follow all instructions to make all necessary wiring connections. Then refer back to this sheet to continue installation of this fixture.

5

1. To mount fixture, slide backplate **(E)** over screws **(B)** and secure with ball knobs **(F)** - see **Drawing 2**.

Note: Maximum wattage for 1290 fixture is 60 watts per bulb.

2.7.08