

Family: Dunhill | Item No. 4594

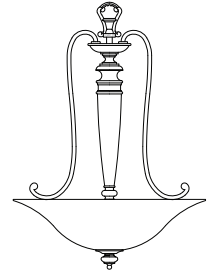

Drawing 1 - Fixture Assembly

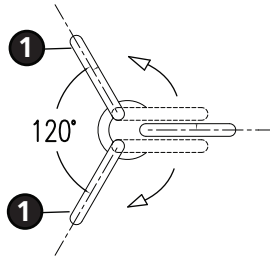

Drawing 2 - Fixture Assembly

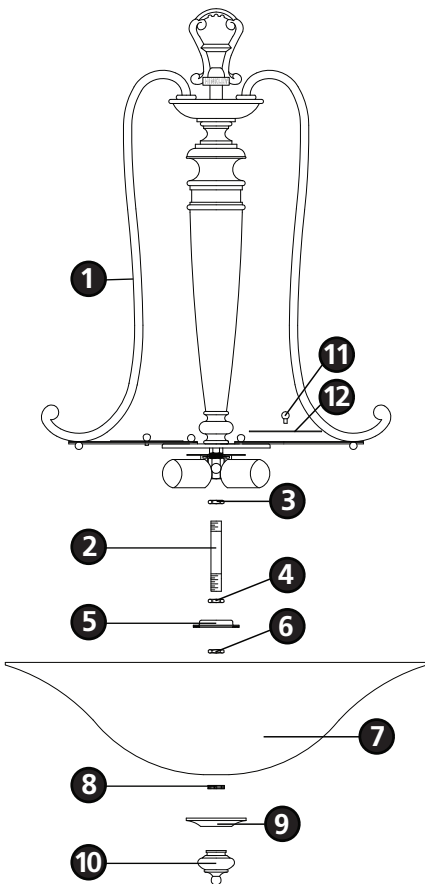

▼ start here

1

1. Find a clear area in which you can work.
2. Unpack fixture and glass from carton.
3. Carefully review instructions prior to assembly.

***** The construction of this fixture will be accomplished by first assembling the main body of the fixture, making all necessary electrical connections, hanging the fixture from the ceiling, and then installing the glass.**

SAFETY WARNING: READ WIRING AND GROUNDING INSTRUCTIONS (I.S. 18) AND ANY ADDITIONAL DIRECTIONS. TURN POWER SUPPLY OFF DURING INSTALLATION. IF NEW WIRING IS REQUIRED, CONSULT A QUALIFIED ELECTRICIAN OR LOCAL AUTHORITIES FOR CODE REQUIREMENTS.

2

1. Rotate arms (1) attached to center column, until they are equally spaced **120 degrees** apart - see **Drawing 1**.
2. To assemble main body, take threaded tubing (2) and thread hex nut (3) down on one end approximately 1/2" - see **Drawing 2**.
3. Thread tubing (2) into coupler (A) approximately 1-1/2" and tighten hex nut (3) against coupler (A) to secure tube.
4. Thread hex nut (4) onto tubing (2) approximately 1-1/2", then slip cap (5) on tubing (2) with gasket material facing down.
5. Thread hex nut (6) onto tubing (2) and tighten up against cap (5).
6. Please refer to the hanging instruction sheet (I.S. 19) provided to hang this fixture. Then refer back to this sheet to install the glass.

3

1. Prior to installing glass, fixture can now be lamped accordingly.
2. Slip glass (7) onto tubing (2) and hold in position - see **Drawing 1**.
3. Thread knurl nut (8) onto tubing (2) and tighten to secure glass.
4. Slip cap (9) onto tubing (2) and thread finial (10) onto end of tubing (2) and tighten.
5. To attach diffuser, remove ball knob with stud (12) from crossbar.
6. Place diffuser plate (11) on crossbar and line up holes and thread ball knob stud (12) back in to crossbar to secure.

Note: Maximum wattage for 4594 fixture is 100 watts per bulb.

10.11.10