

## STANDARD FEATURES



ISLAND  
HOODS

- Unique CircuFlow Ventilation System™ with centrifugal blower design prevents grease and contaminants from collecting in duct work for safe operation.
- Appropriate CFM specifications to perfectly match any Hestan cooking product (see specification recommendations) for optimized fume and grease extraction.

CircuFlow Ventilation System™

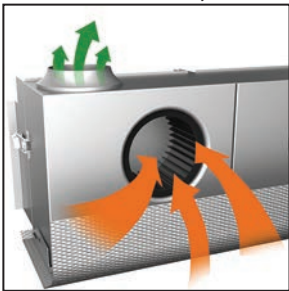

Removable blower Housing



LED lighting



- Baffle-less, variable speed blower CircuFlow Ventilation System™ collects 70% more grease than most competing models.
- Ultra-quiet CircuFlow Ventilation System™ provides best-in-class air flow and extraction efficiency.
- Removable blower components are dishwasher-safe for easy cleaning.
- Optimized low-temp LED lighting for optimum illumination.
- Blower speed automatically increases when higher temperatures are detected and when full blower power is not needed the blower speed automatically lowers for even quieter operation.
- Marquise Accented™ front and back face profile compliments design integrity.
- Available in 36", 42", 54" widths.



*KVI42 Model Shown*

## OPTIONS & ACCESSORIES

- Available in Twelve (12) Hestan signature color finishes.
- Duct Covers in (12) colors.

*36" and 42" Hood*

*54" Hood*

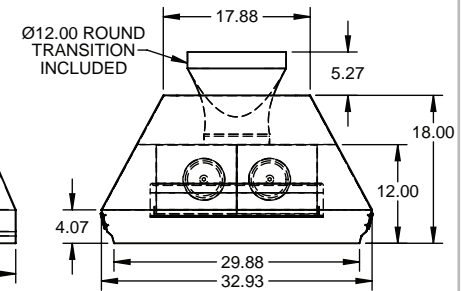
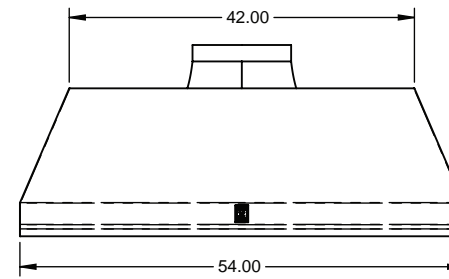
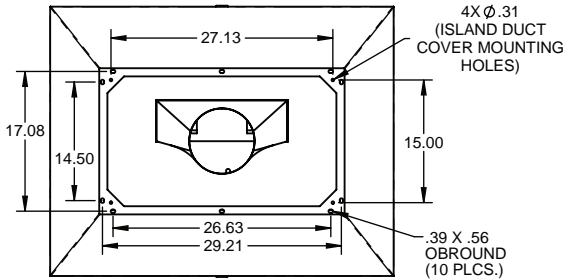
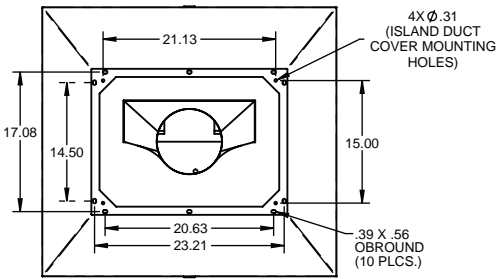
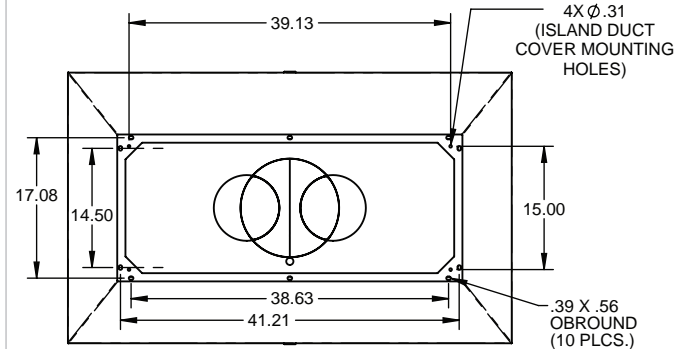
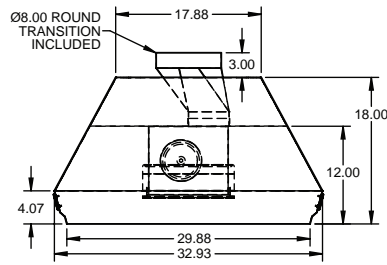
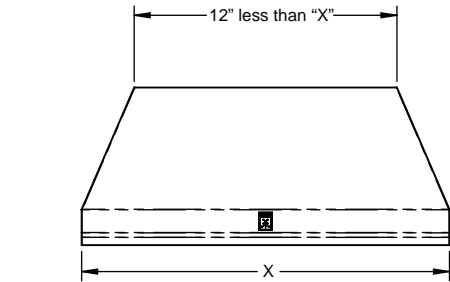

**\*\*\* ALL DIMENSIONS SHOWN FOR REFERENCE ONLY \*\*\***

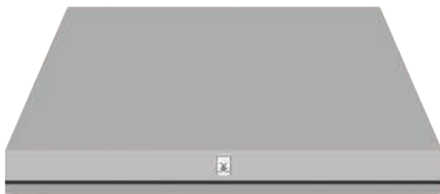

36"

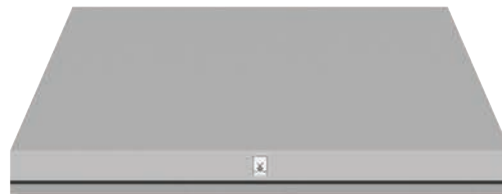

42"

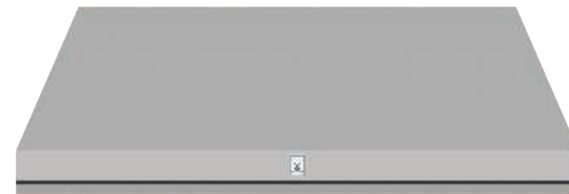

54"



ALL Models	Description	Width Dimensions X (in.)	Recommended for Rangetop Size	CFM SP@0.0"	Equivalent CFM**	Volts	Amps	Hz	RPM	Sones	# Lights	Approx SHP WT (lbs)
KVI36	36" Island Hood	35.88	30"	550	900	120	4.0	60	1550	6.0	4	95
KVI42	42" Island Hood	41.88	36"	550	900	120	4.0	60	1550	6.0	4	116
KVI54	54" Island Hood	53.88	48"	1100	1800	120	7.5	60	1550	6.4	6	188

Hestan indoor products are approved for indoor use only. Hestan Commercial Corporation reserves the right to change materials and specifications without notice.

\*\*When comparing the Hestan system with blower units made by other manufacturers, use the "Equivalent CFM"

**CONTACT US:** [www.hestanhome.com](http://www.hestanhome.com) phone 888.905.7463 3375 E. La Palma Ave., Anaheim, CA 92806