



Tower Cart
GCR/GCD
Parts List

Hestan Commercial Corporation
3375 E. La Palma Ave
Anaheim, CA 92806
(888) 905-7463

RETAIN THIS FOR FUTURE REFERENCE



REPLACEMENT PARTS - TOWER CARTS

Hestan Commercial Corp. | (888) 905-7463

All warranty and non-warranty repairs should be performed by qualified service personnel. To locate an authorized service agent, contact your Hestan dealer, local representative, or the manufacturer. Before you call, please have the model number and serial number information ready.

ITEM	PART NO.	DESCRIPTION	QTY					
			GCD30	GCD36	GCR30	GCR36	GCR42	
1	*009162	DOOR, RH, STD CART, GRILL, WA, 30 (complete assembly w/ handle & hinges)	1					
	*009225	DOOR, RH, STD CART, GRILL, WA, 36 (complete assembly w/ handle & hinges)		1				
	1.1	*012191	SERVICE, DOOR, RH, TOWER CART, WA, 30" (w/out handle & hinges)	1				
		*012193	SERVICE, DOOR, RH, TOWER CART, WA, 36" (w/out handle & hinges)		1			
	1.2	011691	SERVICE, BUMPER, PLASTIC, .50 DIAM. X 0.11 H, PKG 4	1	1			
	1.3	011692	SERVICE, MS, 10-24 X 3/8, PH, FLT, SS, PKG 4	1	1			
	1.4	002558	HANDLE, CABINET	1	1			
	1.5	007872	DAMPER, CLIP-TOP HINGE	2	2			
1.6	011702	SERVICE, MS, 8-32 X .375, PH, FLT, SS, PKG 8	1	1				
1.7	007869	HINGE, CONCEALED, CLIP-TOP, OVERLAY	2	2				
1.8	007871	MOUNTING PLATE, CLIP-TOP HINGE, 3H	2	2				
2	*009180	DOOR, LH, STD CART, GRILL, WA, 30 (complete assembly w/ handle & hinges)	1		1			
	*009230	DOOR, LH, STD CART, GRILL, WA, 36 (complete assembly w/ handle & hinges)		1		1		
	*009231	DOOR, LH, STD CART, GRILL, WA, 42 (complete assembly w/ handle & hinges)					1	
	2.1	*012194	SERVICE, DOOR, LH, TOWER CART, WA, 30" (w/out handle & hinges)	1		1		
		*012196	SERVICE, DOOR, LH, TOWER CART, WA, 36" (w/out handle & hinges)		1		1	
		*012197	SERVICE, DOOR, LH, TOWER CART, WA, 42" (w/out handle & hinges)					1
1.2	011691	SERVICE, BUMPER, PLASTIC, .50 DIAM. X 0.11 H, PKG 4	1	1	1	1	1	
1.3	011692	SERVICE, MS, 10-24 X 3/8, PH, FLT, SS, PKG 4	1	1	1	1	1	
1.4	002558	HANDLE, CABINET	1	1	1	1	1	
1.5	007872	DAMPER, CLIP-TOP HINGE	2	2	2	2	2	
1.6	011702	SERVICE, MS, 8-32 X .375, PH, FLT, SS, PKG 8	1	1	1	1	1	
1.7	007869	HINGE, CONCEALED, CLIP-TOP, OVERLAY	2	2	2	2	2	
1.8	007871	MOUNTING PLATE, CLIP-TOP HINGE, 3H	2	2	2	2	2	
3	*011728	DRAWER ASSY., TOWER CART, 30" (complete assembly w/ handle)			2			
	*011729	DRAWER ASSY., TOWER CART, 36" (complete assembly w/ handle)				2		
	*011730	DRAWER ASSY., TOWER CART, 42" (complete assembly w/ handle)					2	
	3.1	011691	SERVICE, BUMPER, PLASTIC, .50 DIAM. X 0.11 H, PKG 4			1	1	1
	3.2	011692	SERVICE, MS, 10-24 X 3/8, PH, FLT, SS, PKG 4			1	1	1
	3.3	002558	HANDLE, CABINET			1	1	1
	3.4	011708	SERVICE, MS, 8-32 X .25, PH, PAN, SS, PKG 12			1	1	1
	3.5	011709	SERVICE, NUT, ACORN, 8-32 X 5/16", SS, PKG 6			1	1	1
	3.6	011710	SERVICE, MS, 8-32 X .5, PH, PAN, SS, PKG 12			1	1	1

*Colored version available. Refer to pg. 4 for further detail.

ITEM	PART NO.	DESCRIPTION	QTY				
			GCD30	GCD36	GCR30	GCR36	GCR42
4	009197	SLIDES, FULL-EXT., 20, SOFT-CLOSE (pair)			2	2	2
5	010674	EYEBOLT, 1/4-20 X 3.5" SHANK, ZN	1	1	1	1	1
6	011432	TRAY, LP TANK, STD CART, WA	1	1	1	1	1
7	011710	SERVICE, MS, 8-32 X .5, PH, PAN, SS, PKG 12	1	1	1	1	1
8	006264	BRACKET, DRAWER SLIDE, LP TANK	2	2	2	2	2
9	011711	SERVICE, NUT, KEPS, #8-32, SS, PKG 6	1	1	1	1	1
10	008206-030	SHELF, STD CART, GRILL, 30	1		1		
	008206-036	SHELF, STD CART, GRILL, 36		1		1	
	008206-042	SHELF, STD CART, GRILL, 42					1
11	011710	SERVICE, MS, 8-32 X .5, PH, PAN, SS, PKG 12	1	1			
12	011713	SERVICE, MS, 10-24 X .500, PH, TRUSS, SS, PKG 8	1	1			
13	007852	CASTER, SWIVEL, 3", W/O BRAKE	2	2	2	2	2
14	007854	CASTER, SWIVEL, 3", W/ BRAKE	2	2	2	2	2
15	011714	SERVICE, WSH, FLAT, 1/4 SAE, SS, PKG 4	4	4	4	4	4
16	011715	SERVICE, NUT, KEPS, 1/4-20, ZN, PKG 4	4	4	4	4	4
17	009157	ASSY., BRACKET A, SIDE SHELF	1	1	1	1	1
18	010569	ASSY., BRACKET B, REAR, SIDE SHELF	1	1	1	1	1
19	010205	PLUG, ROUND, 1.750 DIA. MOUNT, STEEL	2	2	2	2	2
20	009191	GUARD, ELEC. BOX, STD CART, GRILL	1	1	1	1	1
21	011716	SERVICE, NUT, KEPS, #10-32, SS, PKG 4	1	1	1	1	1
22	006261-030	ACCESS PANEL, REAR, GRILL, 30	1		1		
	006261-036	ACCESS PANEL, REAR, GRILL, 36		1		1	
	006261-042	ACCESS PANEL, REAR, GRILL, 42					1
23	011713	SERVICE, MS, 10-24 X .500, PH, TRUSS, SS, PKG 8	1	1	1	1	1
24	008055	STRAIN RELIEF, SNAP-IN, 1.14" SQUARE MOUNT	1	1	1	1	1
25	010568	ASSY., BRACKET A, REAR, SIDE SHELF	1	1	1	1	1
26	009158	ASSY., BRACKET B, SIDE SHELF	1	1	1	1	1
27	007530	SIDE SHELF, GRILL, WA	2	2	2	2	2
27.1	010197	SERVICE, BUMPER, RUBBER, .50 DIAM. X .250 H, PKG 4	2	2	2	2	2
28	010244	KIT, HEX BOLTS & WASHERS, 6 PCS	1	1	1	1	1

COLOR CODE	COLOR
BK	Stealth - Black
WH	Froth - White
RD	Metador - Red
YW	Sol - Yellow
OR	Citra - Orange
BG	Tin Roof - Burgundy
PP	Lush - Purple
BU	Prince - Blue
GR	Grove - Green
GG	Pacific Fog - Dark Gray
TQ	Bora Bora - Turquoise



*For colors, add 2 letter color code to end of part number (e.g., 000123-BK)

REPLACEMENT PARTS - TOWER CARTS



APPLICABLE MODEL NUMBERS		
30"	36"	42"
GCR30	GCR36	GCR42
GCD30	GCD36	-

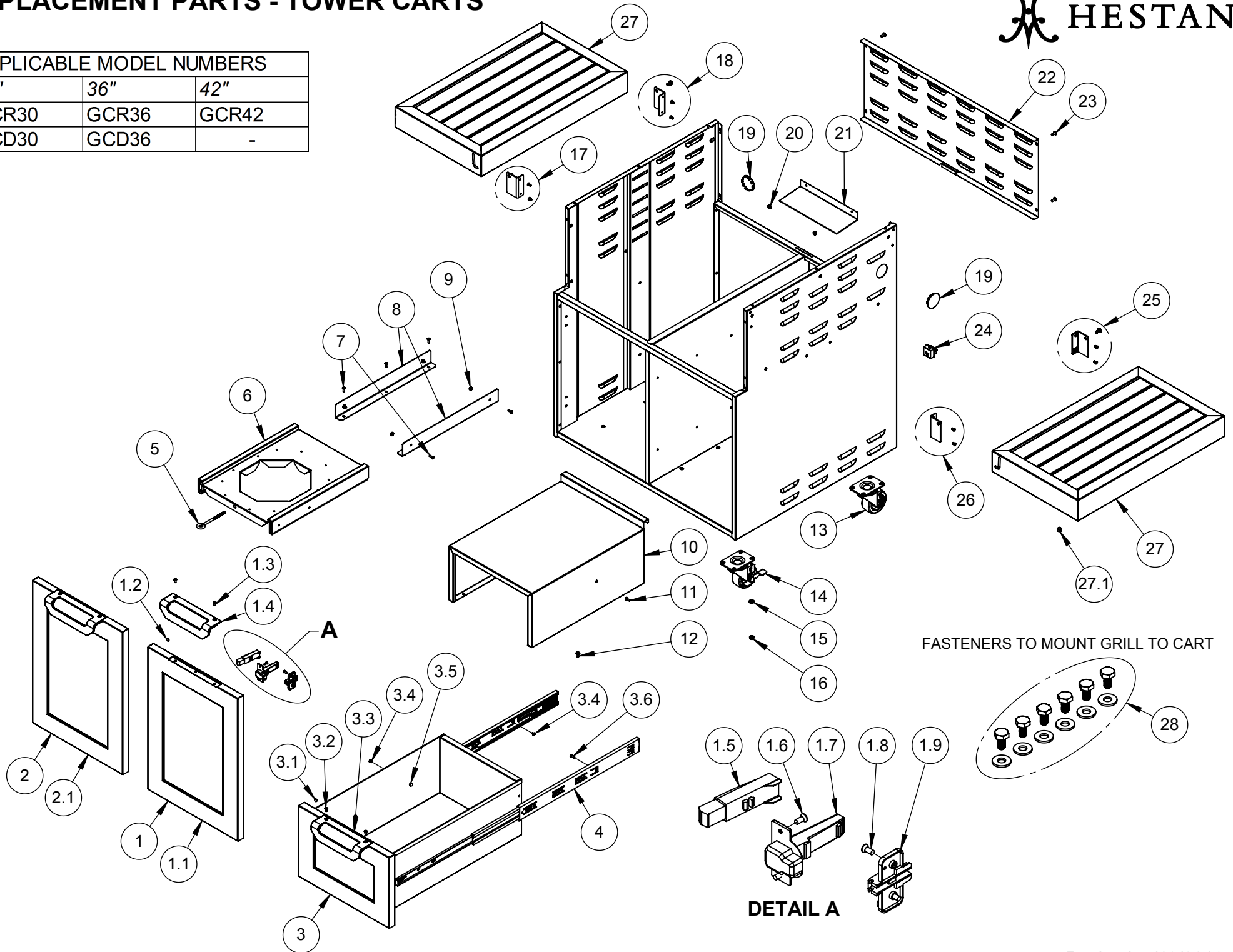



Hestan Commercial Corporation
3375 E. La Palma Ave
Anaheim, CA 92806
(888) 905-7463

RETAIN THIS FOR FUTURE REFERENCE