

ASPIRE

BY HESTAN

Tower Cart

ECD₃₀ / ECD₃₆ / ECD₄₂

Parts List

Hestan Commercial Corporation
3375 E. La Palma Ave.
Anaheim, CA 92806
(888) 905-7463
RETAIN THIS FOR FUTURE REFERENCE

All warranty and non-warranty repairs should be performed by qualified service personnel. To locate an authorized service agent, contact your Hestan dealer, local representative, or the manufacturer. Before you call, please have the model number and serial number information ready.

			ECD30 ECD36 ECD42		
ITEM	PART NO.	DESCRIPTION	QTY		
1	*017386	DOOR W/ MARQUISE, RH, ASPIRE CART, 30 (complete assembly w/ handle & hinges)	1	-	-
	*017388	DOOR W/ MARQUISE, RH, ASPIRE CART, 36 (complete assembly w/ handle & hinges)	-	1	-
	*024117	DOOR W/ MARQUISE, RH, ASPIRE CART, 42 (complete assembly w/ handle & hinges)	-	-	1
1.1	017391	SERVICE, DOOR, RH, ASPIRE CART, 30 (w/out handle & hinges)	1	-	-
	017392	SERVICE, DOOR, RH, ASPIRE CART, 36 (w/out handle & hinges)	-	1	-
	024118	SERVICE, DOOR, RH, ASPIRE CART, 42 (w/out handle & hinges)	-	-	1
1.2	011691	SERVICE, BUMPER, PLASTIC, .50 DIAM. X 0.11 H, PKG 4	1	1	1
1.3	002559	INSERT, RECESSED, HANDLE	1	1	1
1.4	*002554	INSERT, RIGIDIZED, HANDLE	1	1	1
1.5	011692	SERVICE, MS, 10-24 X 3/8, PH, FLT, SS, PKG 4	1	1	1
1.6	002558	HANDLE, CABINET	1	1	1
1.7	007869	HINGE, CONCEALED, CLIP-TOP, OVERLAY	2	2	2
1.8	011702	SERVICE, MS, 8-32 X .375, PH, FLT, SS, PKG 8	1	1	1
1.9	007871	MOUNTING PLATE, CLIP-TOP HINGE, 3H	2	2	2
2	*017389	DOOR W/ MARQUISE, LH, ASPIRE CART, 30 (complete assembly w/ handle & hinges)	1	-	-
	*017390	DOOR W/ MARQUISE, LH, ASPIRE CART, 36 (complete assembly w/ handle & hinges)	-	1	-
	*024121	DOOR W/ MARQUISE, LH, ASPIRE CART, 42 (complete assembly w/ handle & hinges)	-	-	1
2.1	017393	SERVICE, DOOR, LH, ASPIRE CART, 30 (w/out handle & hinges)	1	-	-
	017394	SERVICE, DOOR, LH, ASPIRE CART, 36 (w/out handle & hinges)	-	1	-
	024119	SERVICE, DOOR, LH, ASPIRE CART, 36 (w/out handle & hinges)	-	-	1
1.2	011691	SERVICE, BUMPER, PLASTIC, .50 DIAM. X 0.11 H, PKG 4	1	1	1
1.3	002559	INSERT, RECESSED, HANDLE	1	1	1
1.4	*002554	INSERT, RIGIDIZED, HANDLE	1	1	1
1.5	011692	SERVICE, MS, 10-24 X 3/8, PH, FLT, SS, PKG 4	1	1	1
1.6	002558	HANDLE, CABINET	1	1	1
1.7	007869	HINGE, CONCEALED, CLIP-TOP, OVERLAY	2	2	2
1.8	011702	SERVICE, MS, 8-32 X .375, PH, FLT, SS, PKG 8	1	1	1
1.9	007871	MOUNTING PLATE, CLIP-TOP HINGE, 3H	2	2	2
3	013415	TANK BASE, ASPIRE CART	1	1	1
4	017382	SERVICE, SMS, TEK, #8 X 1/2", PH, PAN, SS, PKG 6	1	1	1
5	016805	GROMMET, LOCKING, 1-3/4 HOLE KNOCKOUT	1	1	1
6	007852	CASTER, SWIVEL, 3", W/O BRAKE	2	2	2
7	007854	CASTER, SWIVEL, 3", W/ BRAKE	2	2	2

ITEM	PART NO.	DESCRIPTION	ECD30	ECD36	ECD42
			QTY		
8	011853	SERVICE, NUT, LCK, SERRATED FLANGE, 1/4-20, SS, PKG 4	4	4	4
9	009157	ASSY., BRACKET A, SIDE SHELF	1	1	1
10	010569	ASSY., BRACKET B, REAR, SIDE SHELF	1	1	1
10.1	011717	SERVICE, HB, 1/4-20 X .500, SS, PKG 4	1	1	1
10.2	017383	SERVICE, MS, 10-24 X 1/2, PH, FLT, UC, SS, PKG 2	1	1	1
11	015472	PLUG, ROUND, 1.750 DIA. MOUNT, PLASTIC	2	2	2
12	009191	GUARD, ELEC. BOX, STD CART, GRILL	1	1	1
13	017384	SERVICE, NUT, KEPS, #10-24, SS, PKG 4	1	1	1
14	011713	SERVICE, MS, 10-24 X .500, PH, TRUSS, SS, PKG 8	1	1	1
15	006261-030	ACCESS PANEL, REAR, GRILL, 30	1	-	-
	006261-036	ACCESS PANEL, REAR, GRILL, 36	-	1	-
	006261-042	ACCESS PANEL, REAR, GRILL, 42	-	-	1
16	008055	STRAIN RELIEF, SNAP-IN, 1.14" SQUARE MOUNT	1	1	1
17	010568	ASSY., BRACKET A, REAR, SIDE SHELF	1	1	1
18	009158	ASSY., BRACKET B, SIDE SHELF	1	1	1
19	012663	SIDE SHELF, ASPIRE CART	2	2	2
19.1	011691	SERVICE, BUMPER, PLASTIC, .50 DIAM X 0.11 H, PKG 4	1	1	1
20	010244	KIT, HEX BOLTS & WASHERS, 6 PCS	1	1	1
21	014117	MANUAL, USE & CARE, OUTDOOR ASPIRE GRILL CART	1	1	1

COLOR CODE	COLOR
BK	Stealth - Black
RD	Matador - Red
OR	Citra - Orange
BU	Prince - Blue



*FOR COLORS, ADD 2 LETTER COLOR CODE TO END OF PART NUMBER (e.g., 000123-BK)

REPLACEMENT PARTS - TOWER CARTS

ASPIRE
BY HESTAN

APPLICABLE MODEL NUMBERS		
30"	36"	42"
ECD30	ECD36	ECD42

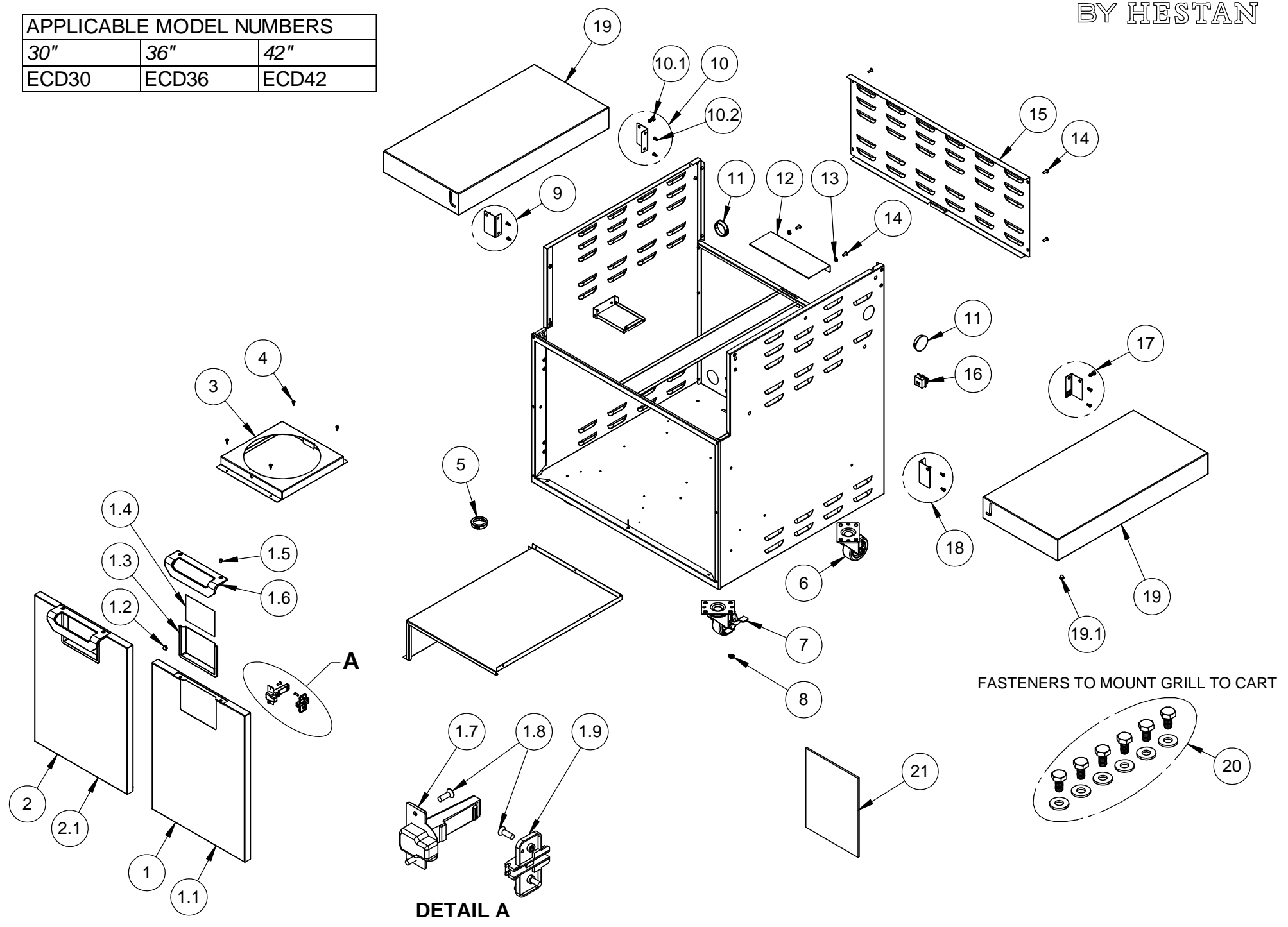

DETAIL A

FASTENERS TO MOUNT GRILL TO CART

ASPIRE

BY HESTAN

Hestan Commercial Corporation

3375 E. La Palma Ave.

Anaheim, CA 92806

(888) 905-7463

RETAIN THIS FOR FUTURE REFERENCE