



# model MK8A

Freeze-protection Bury Valve

## FEATURES & BENEFITS

---

## OPTIONS

---

For more information, visit [www.hawasco.com](http://www.hawasco.com) or call (888) 640-4297.



## SPECIFICATIONS

---

Model MK8A is a special freeze-protected valve that drains water from Model 8300FP combination shower/eyewash after closing to prevent freezing. 3/4" NPT inlet. Standard sizes are 60" and 78" (152.4 and 198.1 cm) for bury depths of 24" and 42" (61 and 106.7 cm) respectively. Servicing Instructions: For replacement of damaged parts, order the VRKMK8A repair kit which includes packing, stuffing box, stuffing box nut, spring and plunger assembly with four O-rings.

## APPLICATIONS

---

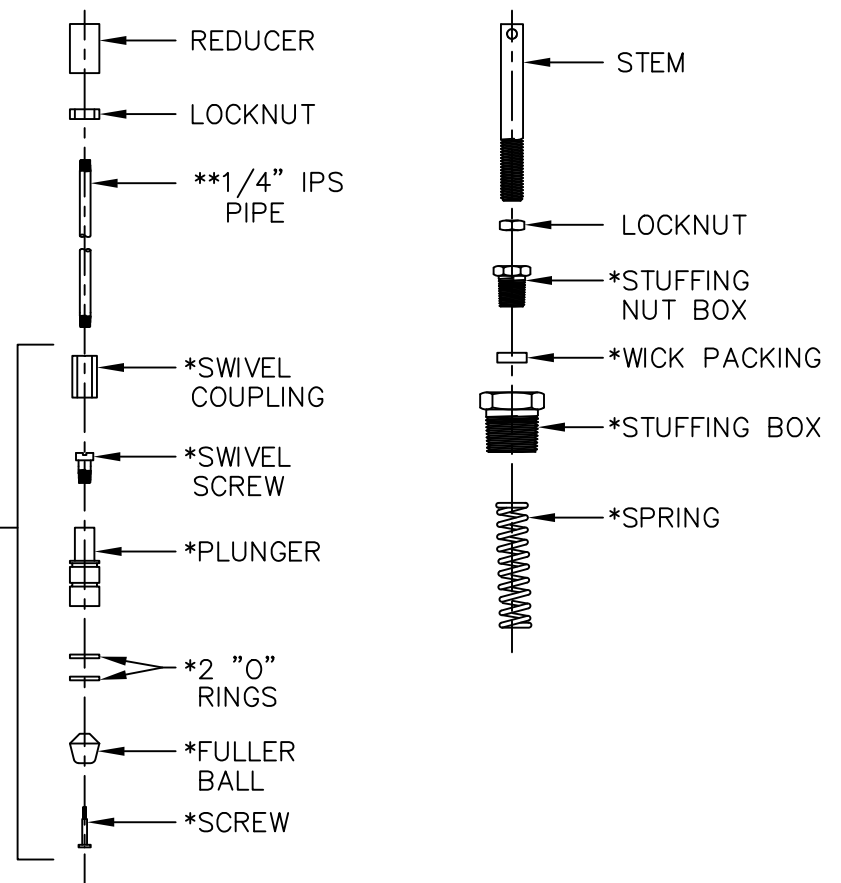
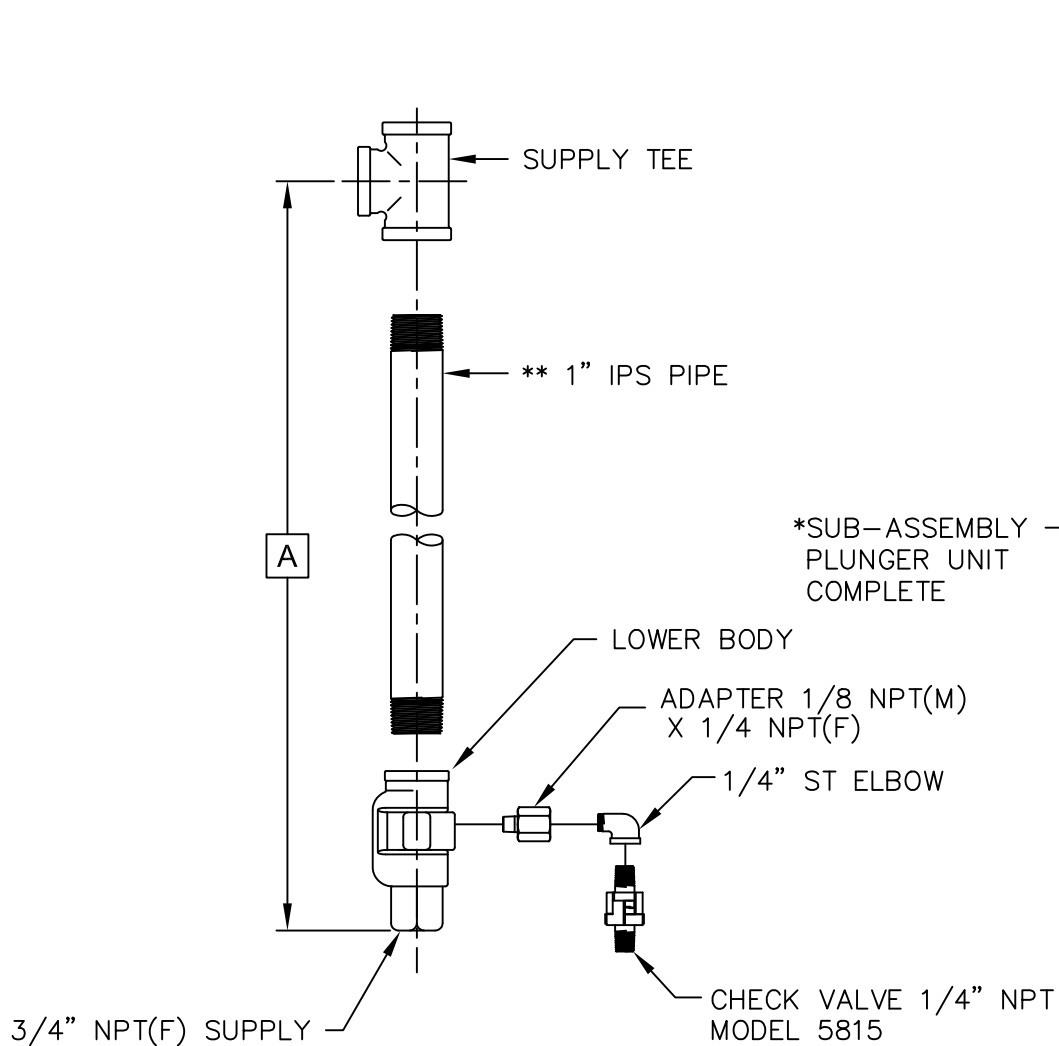

\*SUB-ASSEMBLY PLUNGER UNIT COMPLETE

REPLACEMENT PARTS FOR ITEMS MARKED WITH AN ASTERISK (\*) ARE INCLUDED IN VALVE REPAIR KIT MODEL VRKMK8A AVAILABLE FROM HAWS.

\*\* SPECIFY BURY DEPTH WHEN ORDERING THESE PARTS

A	FOR BURY DEPTH
60"	24"
78"	42"

1455 KLEPPE LANE  
SPARKS, NEVADA 89431  
(775) 359-4712 FAX (775) 359-7424  
E-MAIL: HAWS@HAWSCO.COM  
WEBSITE: WWW.HAWSCO.COM

ECN NO.:	REVISOR:	MODEL(S)	PART NUMBER:
ECN: 4561	LVWC	MK8A FREEZE PROOF VALVE	0002080286.D
DRAWN:	DATE:	CHKD.:	DRAWING NO.:
C.H.	09/90		07895A00
APPROVED:	DATE:	SCALE: 1:5	DRAWING TYPE: INSTALLATION
			SIZE: A SHEET 1 OF 1