



model 3377BFFR

Bottle Filler Attachment

FEATURES & BENEFITS

PUSH BUTTON

Polished chrome-plated push-button requires less than 5 lbs. (2.7 kg) of push force to activate.

FREEZE-RESISTANT VALVE

Fully-engineered system with the pneumatic-operated, freeze-resistant valve installed below frost line to drain water to non-freezing depth allowing fountain to function year round. Assembly can be lifted to surface and lowered back into casing for easy maintenance without disturbing the fountain.

LAMINAR FLOW

Adjustable, splash-free, 1 gpm (3.78 L) laminar water flow.

CONSTRUCTION

Heavy-duty 3/16" (.47 cm) galvanized steel pedestal attachment is supplied with a top down access plate and finished with green powder-coat paint.

ATTACHMENT INSTALLATION

Bottle filler attachment can be ordered with a 3377FR pedestal drinking fountain, or added to an existing installation.



OPTIONS

For more information, visit www.hawsc.com or call (888) 640-4297.

SPECIFICATIONS

Model 3377BFFR freeze-resistant bottle filler attachment for the 3377FR pedestal drinking fountain shall include a 14 gauge Type 304 Stainless Steel bottle filler bracket, and a 3/16" galvanized steel top-access pedestal extension with green powder-coated finish, polished chrome-plated brass push-button, and vandal-resistant bottom plate. May be an accessory to a new 3377FR pedestal drinking fountain or retrofit to an existing 3377FR.
.....
REQUIRES MODEL 6518.2FR PRICED SEPARATELY.

APPLICATIONS

Perfect for either public or private outdoor settings, the 3377BFFR is a great fit in areas where aesthetics are important to the overall appeal of the architecture. Suitable in areas where weather conditions exist, this series stands strong as a nice addition to any community. This type of pedestal bottle filler may also be placed in a variety of settings such as parks, schools, and other outdoor environments around office buildings where the temperature may drop into freezing conditions. Haws manufactures drinking fountains, faucets and electric water coolers to be lead-free by all known definitions including NSF/ANSI/CAN 61-Section 9, NSF/ANSI/CAN 372, California Proposition 65, and the Federal Safe Drinking Water Act. Product is compliant to California Health and Safety Code 116875 (AB 1953-2006), and NSF/ANSI/CAN 61: Q ≤ 1.



INSTALLATION INSTRUCTIONS:

- 1) INSTALL 6518.2FR BURY VALVE AND 3377FR FOUNTAIN ACCORDING TO THEIR INSTALLATION INSTRUCTIONS.
- 2) REMOVE THE ACCESS PLATE FROM THE EXISTING 3377FR PEDESETAL. FEED THE INSULATED SUPPLY TUBING AND AIR LINE THROUGH THE HOLE IN THE BOTTOM PLATE OF THE PEDESTAL EXTENSION.
- 3) BOLT THE PEDESTAL EXTENSION ONTO THE 3377FR FOUNTAIN USING THE (4) 1/4-20 FLATHEAD BOLTS PROVIDED. A BALL-END HEX WRENCH IS RECOMMENDED FOR BOLT INSTALLATION.
- 4) INSTALL THE BOTTLE FILLER BRACKET ONTO THE PEDESTAL USING THE (4) 3/8-16 HEX BOLTS PROVIDED. CONNECT THE WATER SUPPLY LINE TUBE TO THE DISPENSING NOZZLE. CONNECT THE AIR LINE TO THE PUSH BUTTON VALVE.
- 5) RE-INSTALL THE ACCESS PLATE ON TOP THE PEDESTAL EXTENSION.

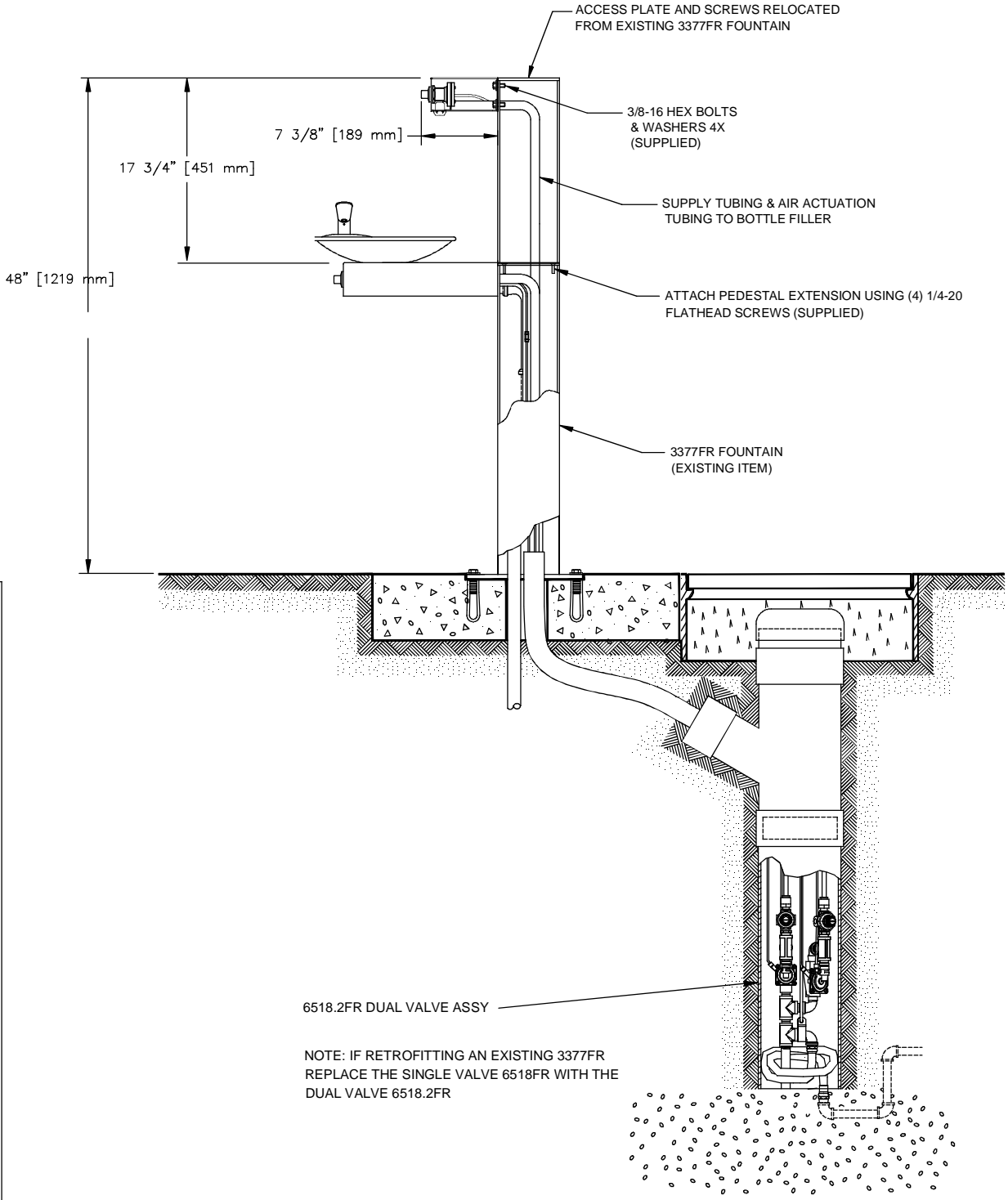
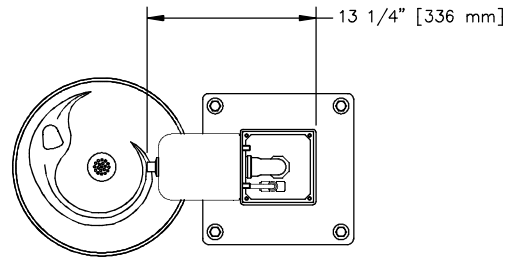

NOTE: IF RETROFITTING AN EXISTING 3377FR REPLACE THE SINGLE VALVE 6518FR WITH THE DUAL VALVE 6518.2FR

		MODEL(S)	
ECONO: 5081		3377BFFR	
REVISION	DATE	CHKD:	DATE
2	10/24/16	WVC	
DRAWN: MJ		SCALE: 1:16	
APPROVED: FV		DRAWING TYPE: INSTALLATION	
ECONO: 5081		SIZE: A	
DATE: 06/08/16		SHEET: 1 OF 1	
DATE: 10/24/16		REVISION	
DATE: 10/24/16		2	

1456 KLEPPE LANE
SPARKS, NEVADA 89431
(775) 359-4712 FAX (775) 359-7424
E-MAIL: HAWS@HAWS.CO.COM
WEBSITE: WWW.HAWS.CO.COM

PART NUMBER: 0510000510.D