

INSTALLATION INSTRUCTIONS:

- 1) INSTALL 6518.2FR BURY VALVE AND 3377FR FOUNTAIN ACCORDING TO THEIR INSTALLATION INSTRUCTIONS.
- 2) REMOVE THE ACCESS PLATE FROM THE EXISTING 3377FR PEDESETAL. FEED THE INSULATED SUPPLY TUBING AND AIR LINE THROUGH THE HOLE IN THE BOTTOM PLATE OF THE PEDESTAL EXTENSION.
- 3) BOLT THE PEDESTAL EXTENSION ONTO THE 3377FR FOUNTAIN USING THE (4) 1/4-20 FLATHEAD BOLTS PROVIDED. A BALL-END HEX WRENCH IS RECOMMENDED FOR BOLT INSTALLATION.
- 4) INSTALL THE BOTTLE FILLER BRACKET ONTO THE PEDESTAL USING THE (4) 3/8-16 HEX BOLTS PROVIDED. CONNECT THE WATER SUPPLY LINE TUBE TO THE DISPENSING NOZZLE. CONNECT THE AIR LINE TO THE PUSH BUTTON VALVE.
- 5) RE-INSTALL THE ACCESS PLATE ON TOP THE PEDESTAL EXTENSION.

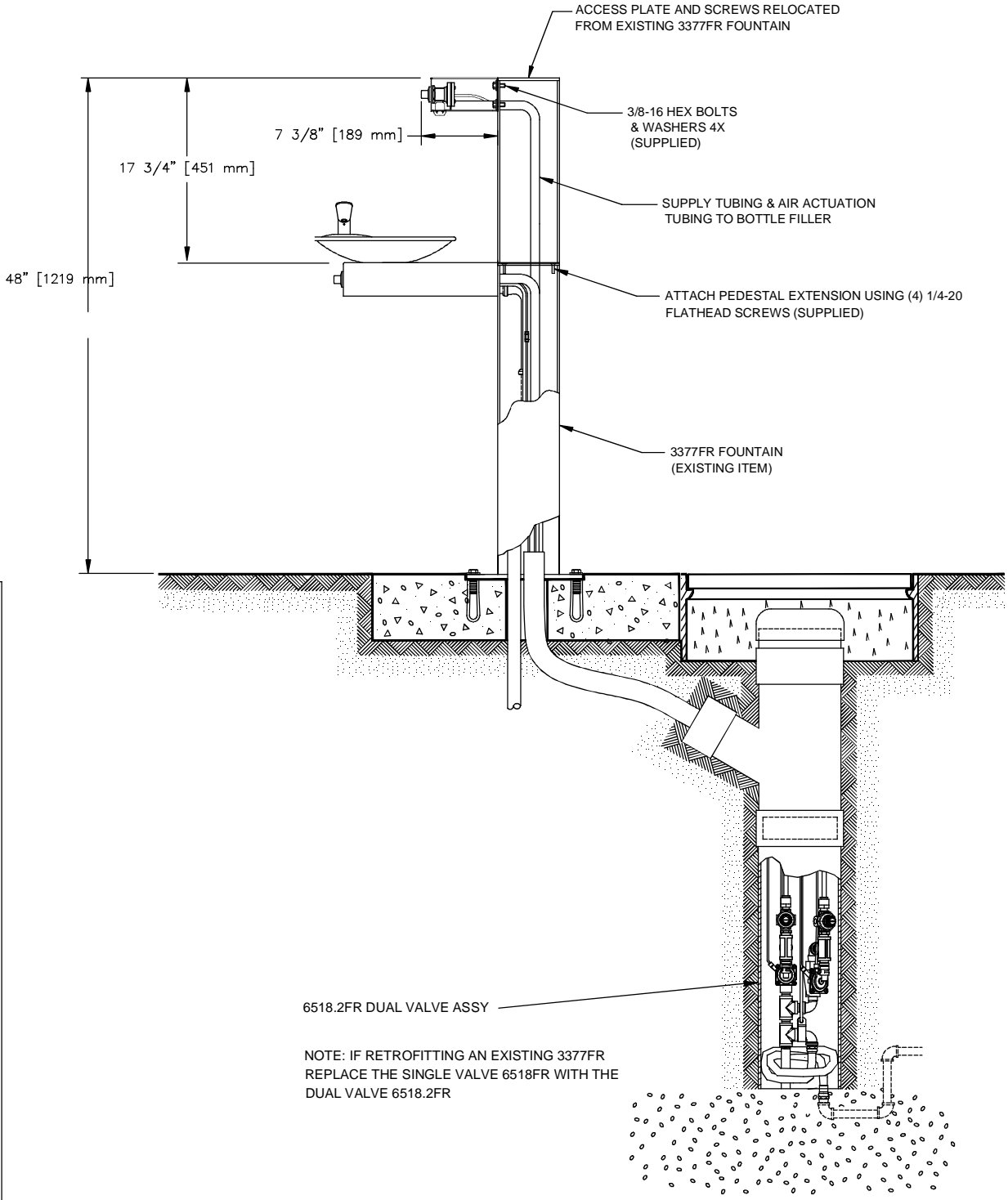
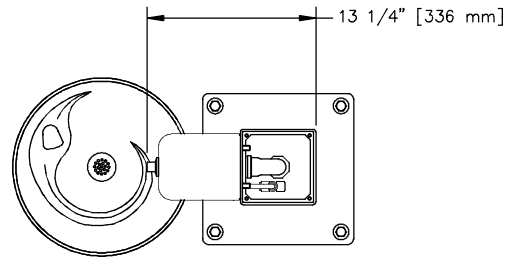

NOTE: IF RETROFITTING AN EXISTING 3377FR REPLACE THE SINGLE VALVE 6518FR WITH THE DUAL VALVE 6518.2FR

Haws		1456 KLEPPE LANE	
SPARKS, NEVADA 89431		(775) 359-4712 FAX (775) 359-7424	
E-MAIL: HAWS@HAWSCO.COM		WEBSITE: WWW.HAWSCO.COM	
ECNNO: 5081	REVISD PER BY: MODEL(S)	3377BFFR	PART NUMBER: 0510000510.D
DRAWN: MJ	DATE: 06/08/16	CHKD: VWC	REVISION: 2
APPROVED: FV	DATE: 10/24/16	SCALE: 1:16	DRAWING TYPE: INSTALLATION
		SIZE: A	SHEET: 1 OF 1