

# 42612 Wall Box Installation Instructions

For use with SJ2, SJ8 & SJ8GRN Remote Chillers

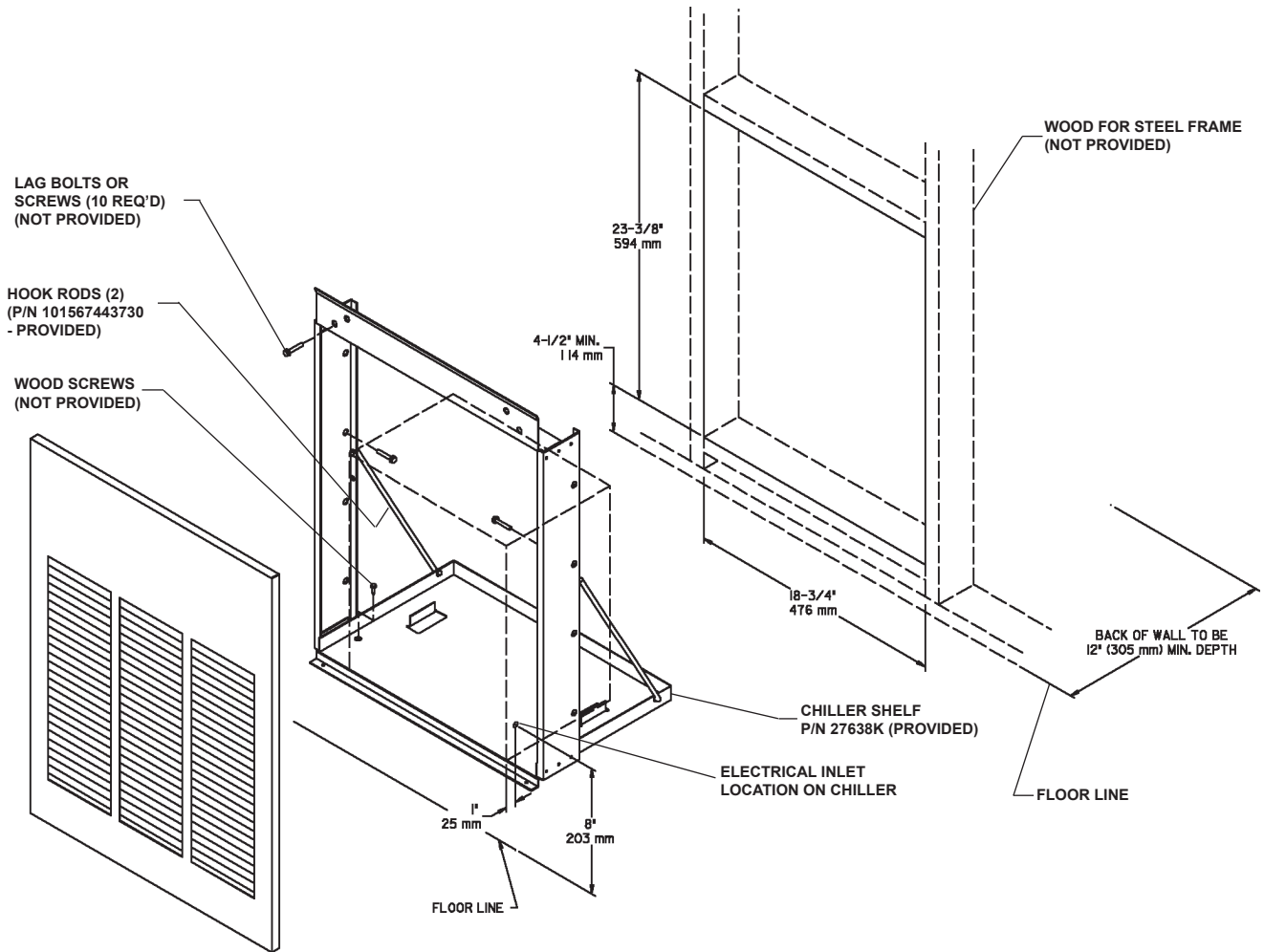

1. **Cut a rectangular wall opening** 18 3/4" (476mm) W x 23 3/8" (594mm) H and 4 1/2" (min.) (114mm) above the floor line.

**NOTE:** Building construction must allow for adequate air flow on both sides and top of remote chiller unit. Minimum of 4" (102mm) is required.

2. **Install plumbing and electrical rough-ins.** A junction box for a (3) wire, 10 amp branch circuit is provided on the inside of the chiller. (Standard 120 Volts, 60 Hz and single phase)
3. **Remove frame and related hardware** from packaging. Remove tape holding hook rods to shelf. Install the frame squarely in wall opening with frames upright edges flush with the finished wall face. Place shelf inside frame and line up the (2) holes on each. Insert loose ends of rods into holes on sides of shelf panel. Using appropriately sized wood screws (not provided), fasten the shelf and frame to bottom of wall opening. Secure the frame sides and top to the wall using appropriately sized lag bolts or screws (not provided).

**NOTE:** Be sure that frame is squared in location. Do not use less than the required screw quantity.

**Halsey Taylor**  
2222 CAMDEN COURT  
OAK BROOK, IL 60523  
800.476.4106  
www.halseytaylor.com

For Technical Service, please call 1.800.476.4106

97255C (Rev. A - 09/16)