

Lutron Stand Alone (LV)

- Control multiple LED light bars, LED strip lights and pucks
- Great for dining rooms, bedrooms, bathrooms, and kitchens
- Dimming offers energy savings over standard wall switches
- Dimming to 1%
- Arrives ready to install
- Input voltage 120 V~ 60 Hz, 600 VA / 450 W
- Operate between 32 °F (0 °C) and 104 °F (40 °C)
- 0% to 90% humidity, non-condensing
- UL Listed

Note

For installation by a qualified electrician in accordance with all local and national electrical codes. Use copper conductors only. For indoor use only. Check to see that the driver type and rating are suitable for the application. **Compatible with E-series and Lutron Low Voltage Drivers.** DO NOT install if product has any visible damage. If moisture or condensation is evident, allow the product to dry completely before installation.

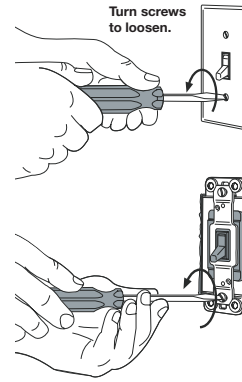

12 V System



2

black	light almond	ivory	white



Diva



Ariadni

**Wall Dimming Controls
2 Wire Low Voltage (LV)**

- Wattage: 600
- L x W x H: 115 x 57 x 55 mm (4 1/2" x 2 1/4" x 2 3/16")

Material: Plastic, Aluminum

Color	Diva	Ariadni
black	820.66.352	820.66.355
light almond	820.66.452	820.66.455
ivory	820.66.652	820.66.655
white	820.66.752	820.66.755

Supplied With

- Mounting screws
- Wire nuts
- Installation instructions



Diva



Ariadni

Wall Plates

L x W x H: 120 x 70 x 10 mm (4 3/4" x 2 3/4" x 3/8")

Material: Plastic

Color	Diva	Ariadni
black	820.66.353	820.66.356
light almond	820.66.453	820.66.456
ivory	820.66.653	820.66.656
white	820.66.753	820.66.756

Supplied With

- Mounting screws
- Cover plate

Dimensional data not binding. We reserve the right to alter specifications without notice.



12 VDC E-series Drivers	page 2.27
24 VDC E-series Drivers	page 2.51
Lutron Driver	pages 2.87 - 2.88