

# Alban Outdoor Wall

8518301, 8618301, 8620701,  
8718301, 8520701, 8720701 1.2

## GENERATION LIGHTING WALL

### GENERAL PRODUCT INFORMATION:

These fixtures are intended to be installed utilizing NEC compliant junction boxes.

This product is safety listed for wet locations.

This instruction shows a typical installation.

### CAUTION - RISK OF FIRE

This product must be installed in accordance with the applicable installation code by a person familiar with the construction and operation of the product and the hazards involved.

Use minimum 90°C supply conductors.

**SAVE THESE INSTRUCTIONS!**

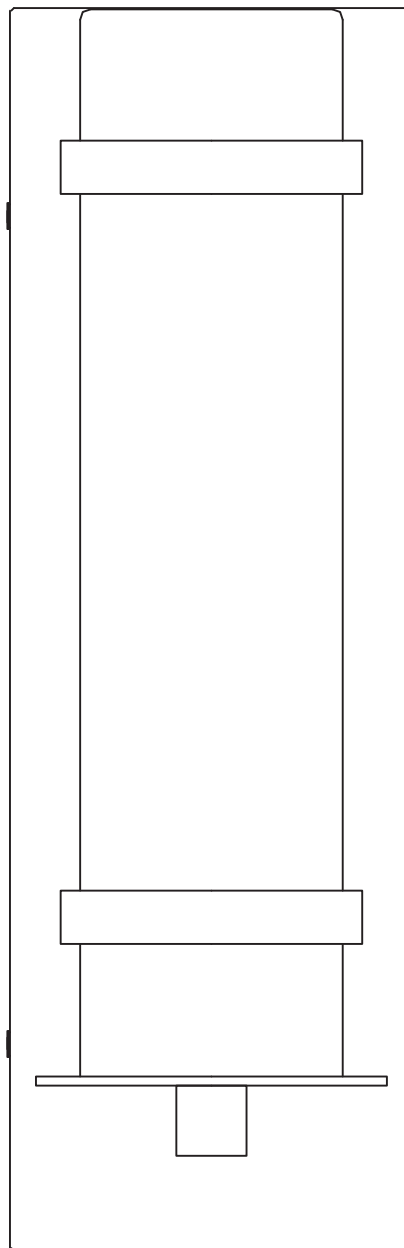

GENERATION LIGHTING  
7400 Linder Ave., Skokie, IL 60077  
T 847.410.4400 | F 847.410.4500  
www.generationlighting.com

# Install the Fixture

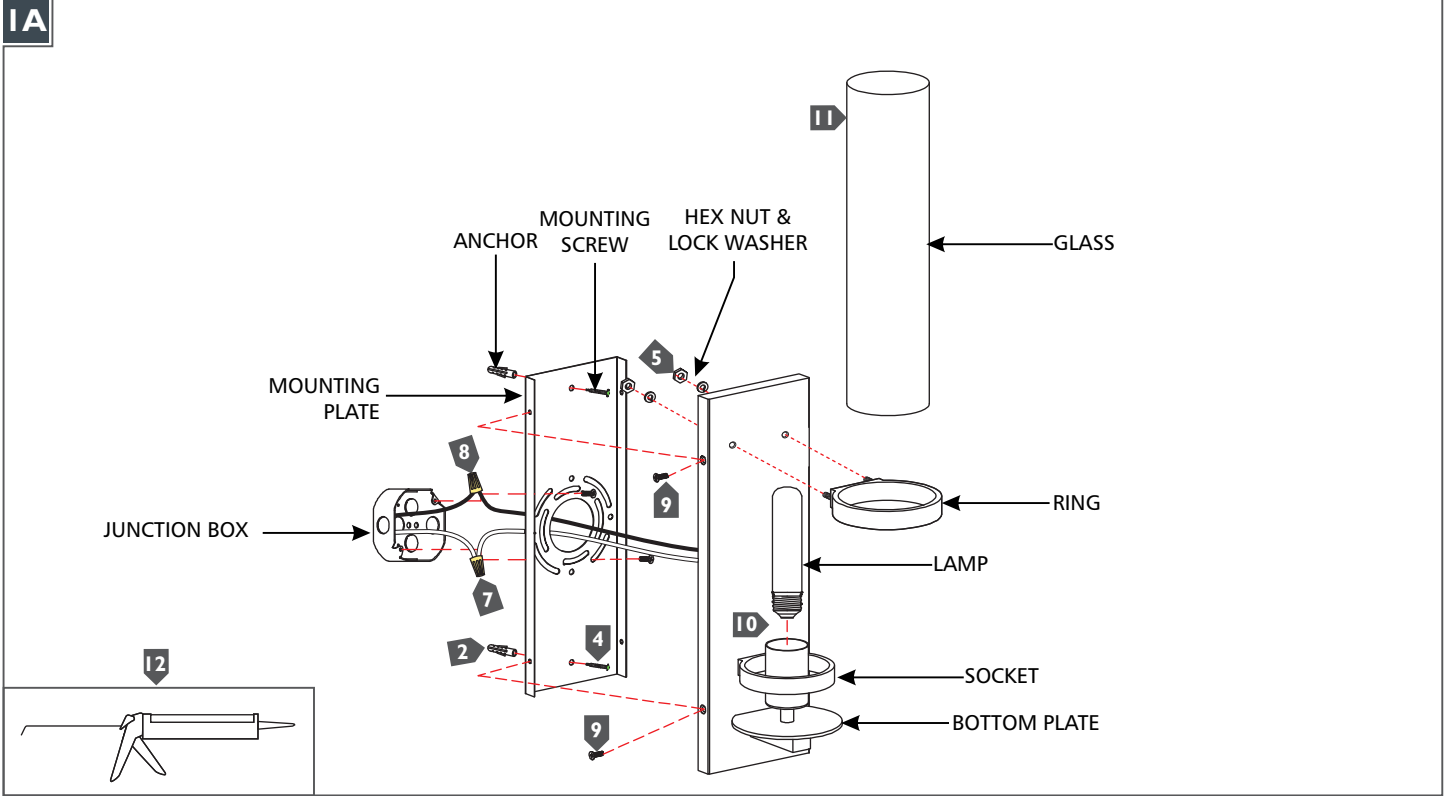

- 1** Temporarily install the mounting plate to the junction box and mark the anchor hole locations through the mounting plate holes. Remove the mounting plate.
- 2** Drill appropriate sized holes at the marked locations and install the anchors.
- 3** Secure the mounting plate to the junction box.
- 4** Screw the anchor screws into the anchors.
- 5** Install the ring onto the fixture base and secure in place with provided lock washers and hex nuts.
- 6** Connect the fixture to a suitable ground in accordance with local electrical codes.
- 7** Connect the white fixture wire to the neutral power line wire with a wire nut.
- 8** Connect the black fixture wire to the hot power line wire with a wire nut.
- 9** Mount the fixture base onto the mounting plate and secure it with the fixture screws.
- 10** Screw the lamp into the socket. Refer to the label on the socket for Max Wattage Information.
- 11** Align the glass to the ring and slide it carefully into the ring allowing it to rest on the bottom plate.
- 12** For wet locations, caulk around the base of the fixture with waterproof construction sealant.