

GTE18NSWR

GE® ENERGY STAR® 18.3 Cu. Ft. Top-Freezer Refrigerator

DIMENSIONS AND INSTALLATION INFORMATION (IN INCHES)

OVERALL DIMENSIONS	Height to top of hinge (in.) A	66-3/4
	Height to top of case (in.) B	65
	Case depth without door (in.) C	27-3/4
	Case depth less door handle (in.) D	31-1/10
	Case depth with door handle (in.) E	32-3/4
	Depth with fresh food door open 90° (in.) F	58-7/10
	Width (in.) G	29-3/4
	Width with door open 90° with door handle (in.) H	30-1/2
AIR CLEARANCES	Each side (in.)	1/8
	Top (in.)	1
	Back (in.)	1

FRONT VIEW

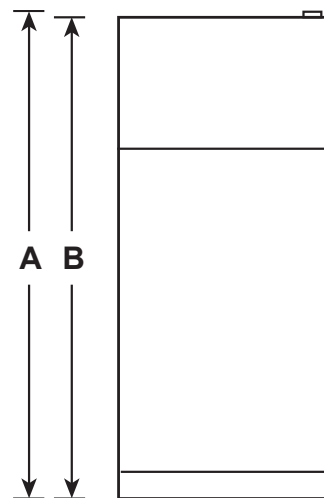

TOP VIEW

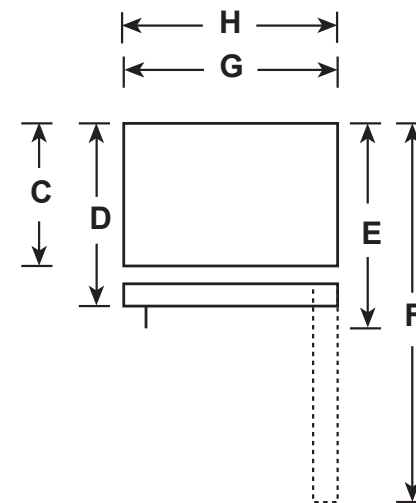

For answers to your Monogram, GE Cafe™, GE Profile™ or GE Appliances product questions, visit our website at geappliances.com or call GE Answer Center® Service, 800.626.2000.



Listed by
Underwriters
Laboratories



As an ENERGY STAR® partner, GE has determined that this product meets the ENERGY STAR guidelines for energy efficiency.

GTE18NSWR

GE® ENERGY STAR® 18.3 Cu. Ft. Top-Freezer Refrigerator

FEATURES AND BENEFITS

#1 Quality and Dependability – Among 16-22 cu. ft. refrigerators based on an independent study of property maintenance personnel.

Source: The Stevenson Company, 2020—Market research company with over 20 years of experience in the appliance industry.

Interior LED lighting – Find all your favorite foods under natural-looking light

Premium Inner Door – Enjoy greater flexibility and organizational options with modular bins right on the door.

2 Adjustable Humidity Controlled Drawers – Adjustable humidity controls help keep food fresh.

Upfront Temperature Control – Easy-to-access upfront temperature controls help regulate the fresh food section.

Spillproof glass shelves – Raised edges help contain spills and make clean up quick and easy.

Adjustable Wire Freezer Shelf – Provides the flexibility to organize your frozen food items.

GTE18NSWRSS – Stainless Steel

GTE18NSWRWW – White

GTE18NSWRBB – Black

