

Getting started
with your

multi-door refrigerator



Before you start



Set up your refrigerator

Remove tape and glue residue from surfaces before turning on the refrigerator. Choose a place near a grounded electrical outlet, allowing for clearances for ease of installation, proper circulation, and plumbing and electrical connections.



Before operating for the first time

After you remove all of the package materials, clean the inside of your refrigerator before using it. See **CARE AND CLEANING** in your Use & Care Manual.

You're in control



Your appliance control display*

We recommend you set your temperatures at 37°F (3°C) for the refrigerator compartment and 0°F (-18°C) for the freezer. After 24 hours, you can adjust the control as desired, allowing the temperature to stabilize.

*Control display varies by model. See the Use & Care Manual for more detailed information about your appliance.

EXTERNAL DISPENSER CONTROL DISPLAY

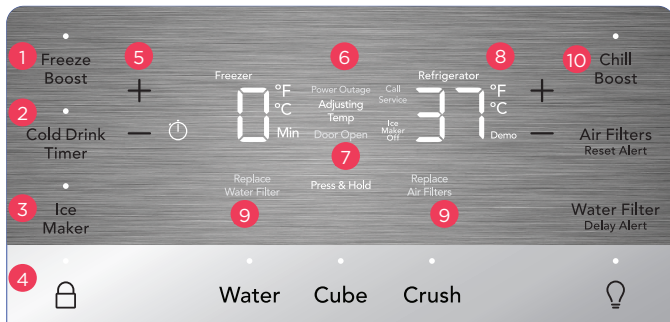

- 1 Activate **Freeze Boost** prior to grocery shopping to lower the temperature and freeze food faster. Freeze Boost remains active for up to 24 hours.
- 2 Press **Cold Drink Timer** to start a timer for chilling drinks.
- 3 The ice maker makes ice until the ice bin is full. Press and hold **Ice Maker** for 3 seconds to turn it on/off.
- 4 Press and hold for 3 seconds to enable/disable the appliance control display.
- 5 Press either **+** or **-** to adjust to desired temperature setting inside the refrigerator or freezer compartment. **Adjusting Temp** illuminates until you reach the desired temperature(s).
- 6 **Power Outage** illuminates and alert sounds after a power outage ends until you reset it by pressing any button.
- 7 **Door Open** illuminates and alert sounds if the door is open 5+ minutes until you close the door.
- 8 **°F/°C** allows you to switch between Fahrenheit (°F) and Celsius (°C).
- 9 **Replace Water Filter** or **Replace Air Filters** illuminates when it's time to change the filters, generally every 6 months.
- 10 Prior to grocery shopping, we recommend you activate **Chill Boost** to cool your food faster.

SIDE DOOR DISPENSER CONTROL DISPLAY



- 1 Use to lock the display. Press and hold for 3 seconds to enable/disable. The indicator flashes and an alert sounds when **CONTROL LOCK** is enabled. You can't make changes on the display while the lock is engaged.
- 2 Select compartment for temperature change (**FREEZER** or **REFRIGERATOR**). Press either the **+** or **-** to adjust to desired temperature setting.
Freezer temp - Control temperatures range from -6°F / -21°C to +6°F / -15°C.
Refrigerator temp - Control temperatures range from +34°F / +1°C to +44°F / +7°C. This unit is designed to operate at 37°F Refrigerator/0°F Freezer. Temperatures should stabilize within 24 hours of installation.
- 3 **Clear Alerts** resets any alarms that are active and illuminated on the display (**Door Open, High Temp, Power Outage**).
- 4 Activate **Freeze Boost** prior to grocery shopping to lower the temperature and freeze food faster. Freeze Boost remains active for up to 24 hours.
- 5 **°F/°C** allows you to switch between Fahrenheit (°F) and Celsius (°C).
- 6 Press and hold for 3 seconds to enable/disable the water dispenser. When enabled, the LEDs above **Water Dispenser** illuminates.
- 7 Press and hold **Default Settings** for 3 seconds to reset to default settings.
- 8 Press and hold **Water Filter** or **Air Filters** for 3 seconds to reset after replacing the filter.

Keep it fresh

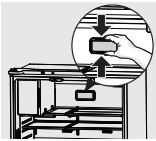

Frigidaire PureAir® AF-2™ Replacement Refrigerator Air Filter (1 included)

- More powerful than baking soda, the new **PureAir AF-2 Replacement Refrigerator Air Filter** absorbs undesirable smells keeping your fridge fresher for up to 6 months.
- The air filter is located at the top center of the refrigerator compartment. To change your filter:
 1. Remove the air filter cover by squeezing the top and bottom of the cover together and removing it from the liner.
 2. Remove the old filter and discard it.
 3. Unpack the new filter and snap it into the filter cover. Install the open face (carbon media) of the filter facing outward in the cover.
 4. Replace the air filter cover by squeezing the sides and snapping it back into place.
 5. To reset, after replacing the filter, press and hold **Air Filter** on the appliance control display for 3 seconds. The status will reset to **GOOD**.



FRGPAAF2™

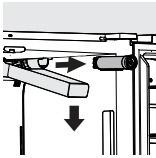

Frigidaire PurePour Connect™ PWF-2™ Ice & Water Refrigerator Filter (1 installed)

- Makes safer water second nature - certified to reduce contaminants and keep great-tasting water flowing for you and your family for up to 6 months.
- The water filter is located at the top right side of the refrigerator compartment.
- Before dispensing water for the first time, be sure to prime the water supply system (**NOTE:** Ensure you enable **Water Dispenser** on SIDE DOOR DISPENSER models. LEDs above the button are lit.) :
 1. Hold a glass against the paddle for about 4 minutes to purge air from the system.
 2. Continue dispensing at least 1 full gallon (3.6 L) of water and discard.



FRPWFU02™

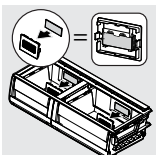

Install your new PureAir PK-2 Produce Keeper Plus™ Refill to extend the life of produce (2 included)

1. Remove the outer plastic wrapper.
2. Insert the unopened packets into the holder in the Crisper, as shown on the left.



FRPAPK2RF™

For optimal results, replace your air and water filters every 6 months, and your Produce Keeper Plus every 12 months.

FAQs

My refrigerator is making unfamiliar sounds. Is this normal?

Your new, high-efficiency unit may introduce unfamiliar sounds. These sounds normally indicate your appliance is operating correctly. See the **NORMAL OPERATING SOUNDS** section of your Use and Care Manual for more information.

How do I use the side door dispenser?

Your side door dispenser is located in the left hand refrigerator door. To use the dispenser simply hold the door with one hand while placing your glass under the nozzle and pushing the paddle to dispense water with your other hand. If your glass doesn't enable the paddle due to size, use your finger to activate the paddle for dispensing.

Why does my refrigerator seem to run continuously?

Your variable speed compressor is designed to run 100% of the time except during the defrost cycle. At times it will run faster, such as after a defrost cycle.

How does my CrispSeal® Fresh Crisper work?

Our crispers block out dry air and slow down the aging process of your produce by reducing ethylene gases, which cause produce to ripen faster.

Good news - no settings needed! CrispSeal Fresh crispers are equipped with an automatic humidity control membrane. We do not recommend replacing the auto-humidity membrane unless it becomes damaged or dirty. If the membrane requires cleaning, you can simply wash it with soap and water. Make sure you thoroughly dry the membrane before replacing in your refrigerator.



For more information refer to **TROUBLESHOOTING** in the back of your Use & Care Manual.

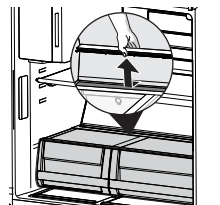

Let's make it official!

Take the first step to becoming a part of the Frigidaire family and discover more benefits by registering your multi-door refrigerator.

Look for the PhotoregisterSM icon on your registration card or register via the Frigidaire App.



We are
here
for you



Have a question?



Want help?



Need service?

Scan the QR Code to the right or visit
frigidaire.com • frigidaire.ca
for owner support



quick start guide

GAS RANGE



BEFORE YOU START



Set up your cooktop

Make sure your burner caps are centered on the burners and the cooking grates are in place.

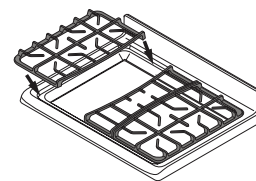
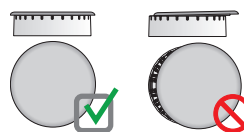

Set up your oven

Make sure your oven racks are in place prior to operating the range.



Set your clock

It's easy! Touch **Menu Options** bars on the screen and scroll to **Clock**. Touch **Set Clock** and set time using graph. Set AM or PM, and touch **Save**.

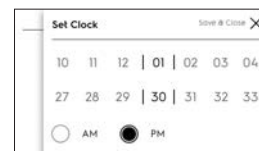

Before cooking for the first time

To get your oven ready to go, set your oven to bake at 350°F for about 30 minutes. As the range gets settled in your home, it's normal to experience some noises and smoke.

GAS COOKTOP BASICS



Choose your cookware

Cookware should have flat bottoms that make direct contact with the entire surface burner grate.



Find the best burner to use

Small burners are best used for low heat or small amounts of food in small pans. Standard burners are great for most cooking needs. Use the largest burner when heating up large pots of liquid or food.



Set the right flame size

Set the flame size appropriately for the pan.

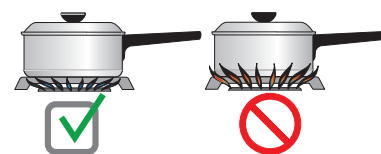

Be careful to not allow flames to extend beyond the outer edge of the pan.

USING THE GRIDDLE



Set up your griddle

Your cooktop has two standard sized burners in the center that can be used to heat larger cookware like a griddle.

1. Put the griddle securely in place of the middle burner grate.
2. Preheat the griddle for 5 minutes on medium to medium low setting.

Slow preheat ensures even heat distribution during the cooking process. **DO NOT** preheat the griddle on HI setting. Preheating on HI may warp the griddle and prevent even heat distribution.

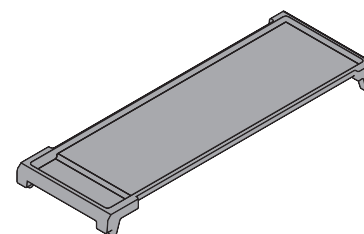

Cleaning your griddle

We recommend washing the griddle with a brush and hot water. Use a little soap if needed, and rinse well. Dry with a lint-free cloth and store in a dry place. Avoid cleaning the griddle in a dishwasher.

YOU'RE IN CONTROL



Your oven controls

Using your oven starts with just pressing the keys on your oven control. Temperature and cooking modes will appear in the display as you go.

1. Press **ON/OFF** button or touch the screen to get started.
2. Select **Start** to begin a bake cycle at 350° or select a different Oven Mode or temperature.
3. If you select **Oven Mode**, scroll down to see all of the options.
4. The default temperature for the Oven Mode you choose will appear. Use the keypad to change the temperature if needed.
5. Touch **Start**. To cancel cooking anytime, touch Cancel.

NOTE: Use the **Timer** or the **Cook Time** feature to help monitor your cooking time. Setting Cook Time shuts the oven off once the set time is complete. For best results, allow your oven to preheat before using Cook Time.

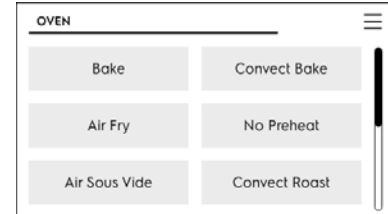
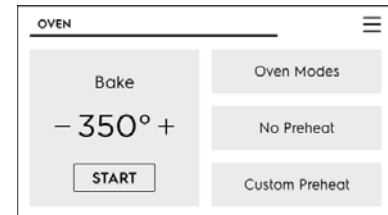

OVEN MODES



Touch Oven Modes and scroll to explore your cooking options.

BAKE surrounds food with gentle, rising heat to cook delicate foods.

CONVECT BAKE uses a fan to circulate heat for quick and even baking.

AIR FRY uses the Air Fry Tray to quickly and evenly circulate heated air to deliver crispy, golden results with little to no oil.

NO PREHEAT is for single rack baking with packaged and convenience foods.

AIR SOUS VIDE uses hot circulating air to preserve nutrients and flavors as your food cooks slowly at low temperatures.

CONVECT ROAST uses a convection fan to gently brown meats and seal in the juices.

BROIL is for broiling and grilling foods under direct, high heat.

MULTI-RACKS is for two rack baking.

STEAM BAKE is recommended for baking moist and flavorful breads and pastries for improved browning and flaky crusts.

STEAM ROAST is recommended for roasting meat or poultry that results in a crispy outside and juicy inside.

BREAD PROOF creates the perfect environment to activate yeast when baking homemade breads.

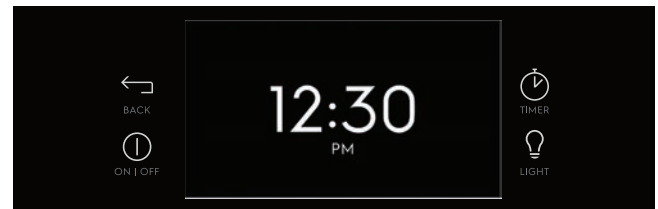

KEEP WARM is used to keep cooked foods at serving temperature (140°F to 200°F) in the oven.

DEHYDRATE uses the Air Fry Tray to circulate air around the food for faster preservation.

DELAY START allows a delayed starting time only for Bake, Convection Bake, No Preheat, Convection Roast, Steam Clean, and Self Clean.

FOOD PROBE monitors the internal temperature of large cuts of meat with a probe. An alert will sound once the desired set target temperature is reached.

COOK TIME counts down your set cooking time and shuts off oven when complete.

FAQs

Why does my range make noises when I'm cooking?

Temp changes during preheat and cool-down can make parts of the range expand and contract. The controls click as they work to create even cooking temps in the oven and on the cooktop zones. Different fans run to heat up the oven or cool down different parts of range, even when it's off. These sounds are normal.



Find more troubleshooting tips in the back of your Use & Care Guide and Frigidaire.com.

LET'S MAKE IT OFFICIAL!

Take the first step to becoming a part of the Frigidaire family by registering your new range. Look for the PhotoregisterSM icon on your registration card.



WE ARE
here
FOR YOU



Have a question?



Want help?



Need service?

owner support

Frigidaire.com 1 (800) 374-4432

Frigidaire.ca 1 (800) 265-8352



GETTING

started

WITH YOUR

FRIGIDAIRE GALLERY DISHWASHER



BEFORE YOU START



Set up your dishwasher

Make sure the top rack, bottom rack and silverware basket are in place prior to operating the dishwasher. See **OPERATING INSTRUCTIONS** in the Use & Care Manual.

Fill Rinse Aid dispenser

Rinse aid greatly improves drying and reduces water spots. Twist off the rinse aid dispenser cap and fill until the indicator reaches full, then replace the cap.

If installed with a garbage disposal

Ensure the knock-out plug is removed so the dishwasher can properly drain. See the Installation Instructions for further details.

YOU'RE IN CONTROL



Your dishwasher controls

To begin using your dishwasher, open the door and select one of the cycle options from the control panel. The Wash and Dry settings can be adjusted based on the cycle chosen. Indicator lights illuminate as each cycle or option is selected.

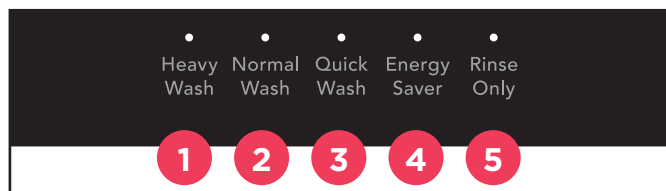

1. Select HEAVY WASH[†] for heavily soiled loads of pots, pans, casserole dishes and dinnerware.
2. Select NORMAL WASH[†] for light to heavily soiled loads.
3. Select QUICK WASH (34 minutes) for lightly soiled loads only.
4. ENERGY SAVER[†] uses less energy by washing lightly soiled loads with less water and the air dry setting.
5. Select RINSE ONLY for rinsing dishware that will be washed later.

[†] Cycle uses a soil sensing feature to determine the best wash performance. The soil sensing feature automatically engages when selecting the HEAVY, NORMAL, or ENERGY SAVER wash cycles.

REMEMBER

- Select cycles and options with the door open. Press START immediately before closing the door.
- To add an item, press START again immediately before closing the door to resume the cycle.
- Load rack so large items do not block the spray arm or detergent dispenser.



6. START/Cancel starts or cancels a cycle. To start the cycle, press START/Cancel button and immediately close the dishwasher door. To cancel the cycle, open the dishwasher door, then press and hold the START/Cancel button for 3 seconds until the cycle and option LEDs turn off.
7. The INDICATOR LIGHTS provide cycle status information showing washing (dishwasher is running), clean (non-sanitized) and sanitized (clean with sanitized option).

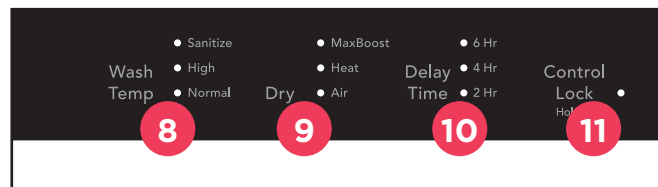

8. WASH TEMP provides the choice of Sanitize, High Temp or Normal water temperature.
9. DRY provides the choice of MaxBoost™ (extended dry time), Heat (normal dry time) or Air (air dry only).
10. DELAY TIME sets a delayed starting time to begin the wash cycle from 2, 4, or 6 hours.
11. CONTROL LOCK locks the dishwasher controls to prevent children from starting the dishwasher or accidentally changing the wash cycle. Press and hold until the lock LED comes on to lock. Press and hold until the lock LED goes off to unlock the controls.

QUICK CARE



A little love goes a long way

Your Dishwasher has a glass trap filter to catch excess food particles. Clean the trap monthly to keep your dishwasher working as expected. See **Emptying the glass trap** below.

Be gentle

Clean the interior with warm water and mild soap using a dishcloth or sponge. Use Frigidaire **ReadyClean™ Stainless Steel cleaner**, available on Frigidaire.com, and wipe with the grain to keep the exterior clean and shiny.

Part #:
5304508691



Emptying the glass trap.

1. Press down on the center of the wash arm and rotate the glass trap handle clockwise to disengage.
2. Lift the spray arm and glass trap out of the dishwasher.
3. Empty the glass trap.
4. Place the assembly back into position, press down on the arm at the center and rotate the glass trap handle counterclockwise back into place.
5. Avoid damage and verify that the glass trap and wash arm are snapped in place. See the Use & Care Manual for more information.

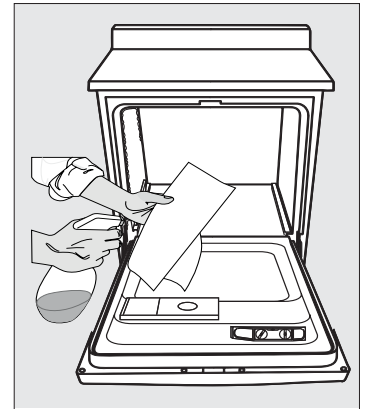

FAQs

Why won't my dishwasher start?

To start a new wash cycle or resume a cycle after adding a dish, press the START button immediately before closing the dishwasher door. If the door remains opened after pressing the button, the unit will not start. Open the door, press the START button again and immediately close the door.

What do I do if my dishes are not as dry as expected?

Try using a rinse aid if your dishes are not as dry as you like. These products help eliminate spots and residue and help with drying and cleaning performance. You can also select the MaxBoost™ Dry setting which extends drying cycle time while improving drying performance.

Why aren't my dishes clean?

Avoid nesting dishes and silverware or overcrowding the dishwasher. Proper loading of racks and silverware baskets improves cleaning and drying performance. See the Use & Care manual for proper loading procedures.



Find more troubleshooting tips in the back of the Use & Care manual, on our website under FAQs, or view our Frigidaire videos on www.youtube.com/Frigidaire.

LET'S MAKE IT OFFICIAL!

Take the first step to becoming a part of the Frigidaire family by registering your new dishwasher.

Look for the PhotoregisterSM icon on your registration card.

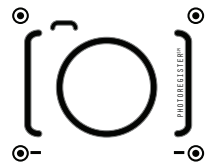

WE ARE
here
FOR YOU



Have a question? Want help? Need service?



owner support

frigidaire.com/1 (800) 374-4432

frigidaire.ca/1 (800) 265-8352

