

# FRANKE KITCHEN SYSTEMS

Villeroy & Boch  
Ceramic Repair Kit

## Instructions for Correct Application



The touch-up stick can be used to correct minor defects quickly and cheaply, and is easy to use. It is suitable for ceramic, enamel, acrylic, powder-coated and lacquered surfaces.

**Product Specification:** High-grade 1K acrylic paint, heat-resistant, non-fading, very good bonding properties, durable finish.



Villeroy & Boch  
1748

### Areas of application:

The touch-up stick is a filling compound and final coat all-in-one, making it ideal for repairing minor impact damage, scratches and surface flaws on bathroom fixtures, tiles, fittings, radiators, kitchen sinks, cookers, washing machines, fridges and furniture.

The often missing glaze on the edges of tiles can also be resolved with this touch-up stick.

### How to use:



1 The damaged area must be clean, dry and grease-free. Shake the touch-up stick thoroughly for 2 minutes prior to use.

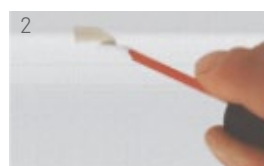

2 Keep the stick upright when opening. For best results apply several thin coats.

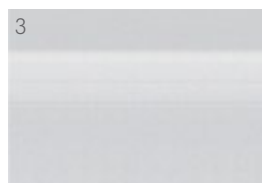

3 Leave the repair to dry for 24 hours – finished!



**To add glazed edges to your tiles:** Mask off non-glazed tile edges. Apply one generous coat and leave to dry for 24 hours.

Fireclay Repair Kits are available in white, biscuit, matte black, glossy black and graphite.

For product inquiries please contact Franke Kitchen Systems Customer Service department:

Franke Kitchen Systems  
Luxury Products Group  
3050 Campus Drive, Ste 500  
Hatfield, PA 19440  
Phone: 800-626-5771  
Fax: 888-685-0007  
[www.frankeksd.com](http://www.frankeksd.com)