



# Installation Instructions

## Model E21316-10PC

1. Turn breaker off for circuit on outlet where fixture is to be installed.
2. Remove mounting bracket from fixture and install to electrical box.
3. Wire fixture to wires in outlet box. Green wire is for Ground.
4. Carefully remove packaging from fixture.
5. Install fixture to bracket and tighten cap nuts so that fixture meets the wall.
6. Install inner crystal strings to metal loops on bottom of panper diagram below. It is recommended to use glove included and not touch crystal with bare fingers.
7. Install maximum 1 x 40W G9 Xenon bulbs into socket.

(Caution: Xenon bulbs get very hot and may burn you. Always make sure bulbs are off for a minimum 10 minutes before handling)

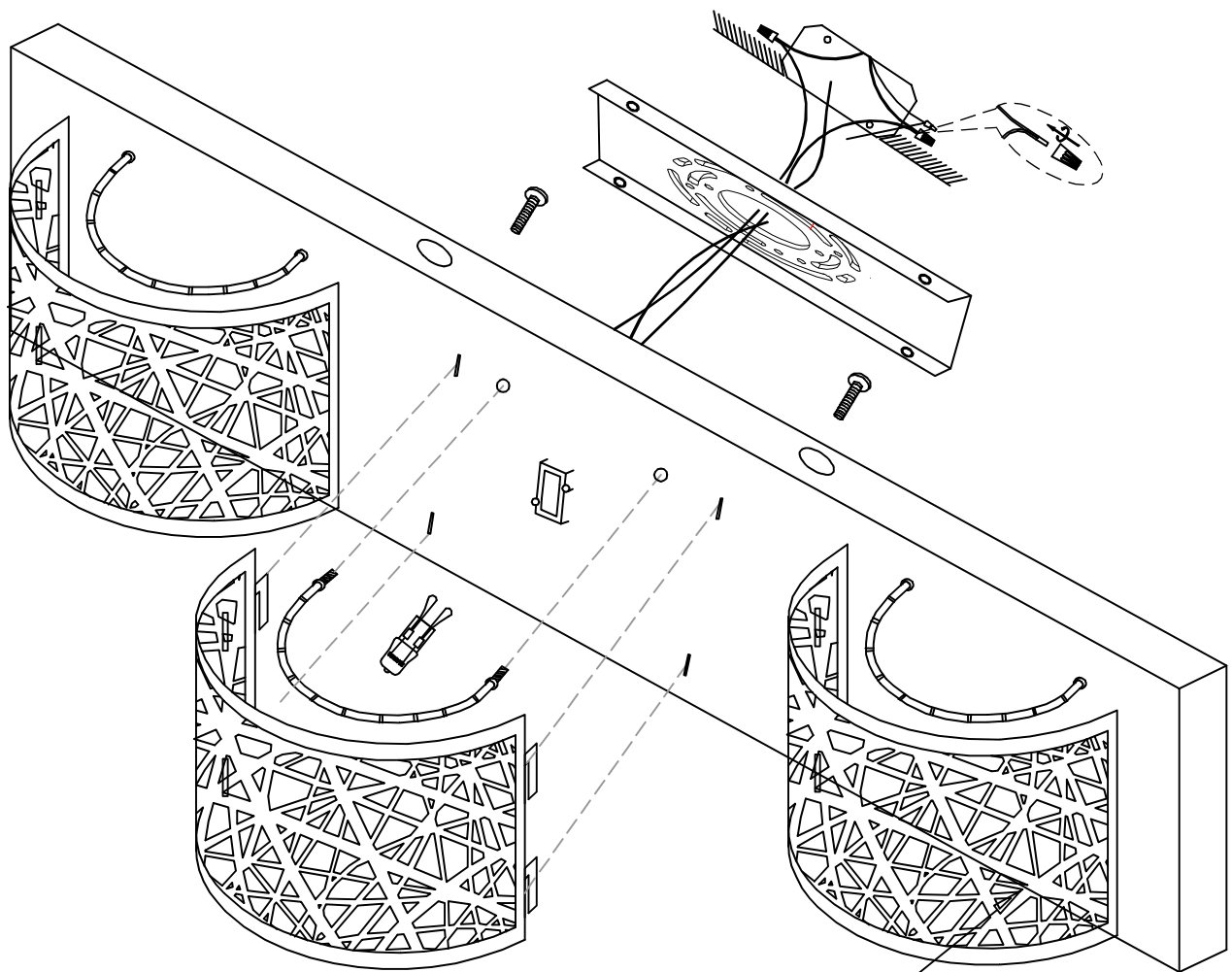

A-30 (L4.5")