

RN61530KDK

LED LOW PROFILE SURFACE DISK LIGHT

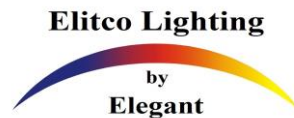

Flush mount LED disk light that can be mounted to 5" & 6" recessed housings and to standard square or round electrical junction boxes.

Performance

- Use with most 4" junction or 4",5",6" recessed cans
- Dimmable with most standard incandescent (triac) and low voltage electronic (ELV) dimmers for 5-100% light control
- Eliminate up to 14 lamps replacements - long HongLi LEDs last up to 50,000 hours, compared to incandescent lamps with a rated life of 2,500 hours
- ETL compliant, for use in wet locations
- Sold separately for Title 24 compliance

Construction

- Aluminum trim ring with durable powder coat finish
- Polycarbonate lens diffuses light

Installation

- Mount on standard 4" Junction box or recessed mount into 4" housing. Includes medium base socket adaptor for easy retrofitting in 4",5",6" recessed housings.

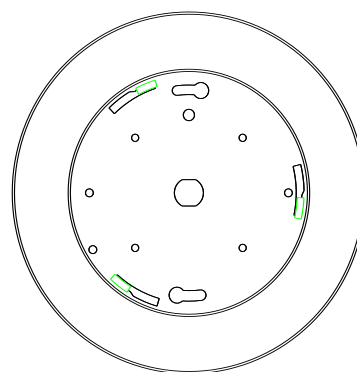
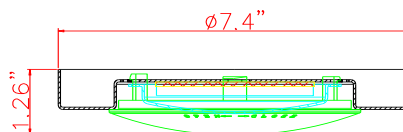

DISK LIGHT

RN61530KDK



Title 24 compliant

Photometric

RN61530KDK

Luminous flux	1000LM
Maximum intensity	310 cd
Input wattage	15W
Lumens per watt	66 LPW
Beam angle	96.8°

LUMINOUS INTENSITY DISTRIBUTION DIAGRAM

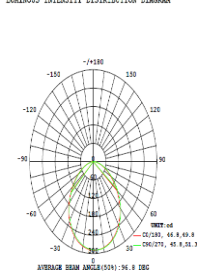

BEAM SPREAD DIAGRAM (MFT-1x)

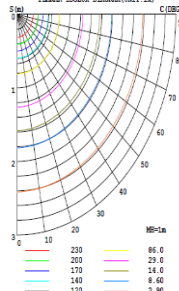

Flux out: 463.1 lm

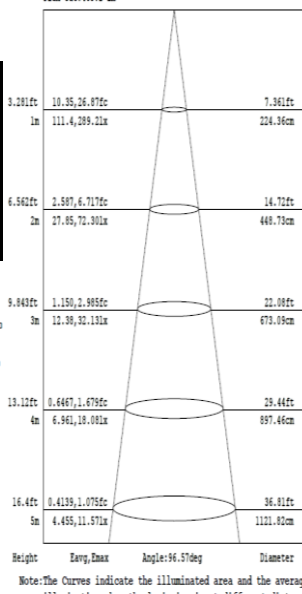

Specifications

Series	RN61530KDK
Input voltage	120V AC, 60Hz
Color temperature	3000K
CRI	90+
Current	135mA
Wattage	15W
Lumens	1000LM
Beam angle	96.57° to 96.8°
Dimming	Most triac and ELV dimmers
Housing	Aluminum
Lens	Frosted polycarbonate
Rating	c/ETL/ wet locations
Dimensions	7.4" Dia. x 1.26" H
Power Factor	98%
Mounting	Recessed/Surface mount
LED type	28 x HongLi LEDs
Rated life	50,000 hrs.
Warranty	5-year limited

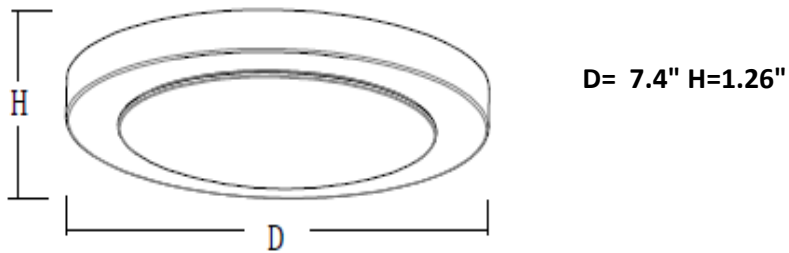

SURFACE MOUNT INSTALLATION

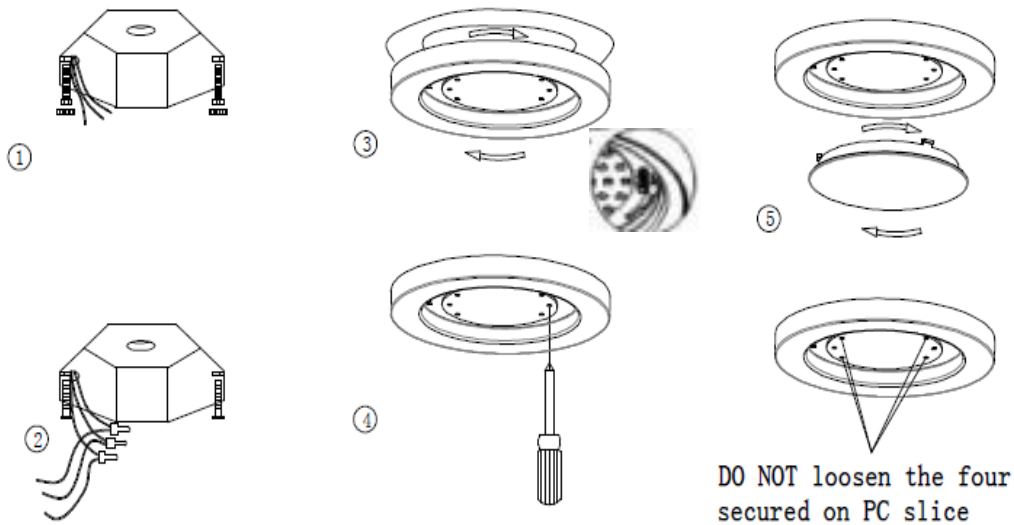

- Step 1) Prior to installation, please install two screws (furnished) into the junction box. Do Not drive screws completely to the end of the junction box.
- Step 2) Connect supply wires to wires in fixture wiring box with proper size wire nuts or push wires into "push-in" connector. Connect white to white, black to black, and green or bare copper wire to bare copper wire.
- Step 3) The ground wire at the service junction box may need to be secured to a ground screw.
- Step 4) Use the screw driver to lock the installed screws into the junction box, through the two round holes on the clear PC slice. (See figure 4)
- Step 5) Complete the installation by twisting the diffuser on the disk light metal enclosure and lock the diffuser in place.