

8" New Construction LED IC Housing



Features

- Frame with driver for IC New Construction to be used with 8" LED Insert.
- High efficiency driver mounted on J-Box.
- UL listed for damp location and for feed through.
- Meets restricted airflow requirements (Per ASTM E-283).
- CA Title 24 compliant.

Specifications

Wattage	19W
Voltage	120/277V
Dimmable	0-10V
Damp Location	Listed

Dimensions

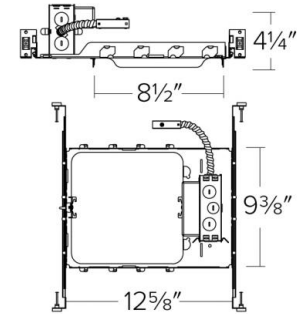

Technical Details

Construction:

- IC Rated for Direct Contact with Insulation.
- Stamped galvanized steel frame.

Installation:

- Designed for ceiling plenums where 2x6 joists or taller are used.
- Suitable for T-grid and drop ceiling applications.
- Driver mounted on junction box for cooler LED operation.

Junction Box: 16 gauge pre-wired galvanized steel Junction Box, 25 cubic-inch for a maximum of (8) #12 AWG wires. Positioned to accommodate straight conduit runs. Furnished with seven 1/2" trade size conduit pry-out knockouts, four 3/4" pry-out knockouts, one 1" pry-out knockout and (4) Romex pry-outs with strain relief. Strain clamps to install or remove covers for easy access and grounding.

Hanger Bars: Pre Installed high strength hanger bars with True Nail easy installation in regular lumber, engineered lumber, and Laminated Beams. Integral T-Bar slots for easy installation in T-Bars. Spans up 24" and can be repositioned 90°. Score lines allow for tool-free hanger bar size reduction. Integral leveling flange allows for single-person installation while easily aligning the housings with the joists.

Electrical:

- Driver is rated for 120/277V.
- High efficiency, high power factor > 0.9 driver.

Dimmability:

- Flicker-Free Dimming.
- For full list of dimmers refer to the Dimmer Compatibility List.

Listings: UL/cUL Listed for Damp Location. Listed for Direct Contact with Insulation and Combustible Material; Listed for Feed Through. Inserts meet restricted air flow requirements (Per ASTM E-283).

Warranty: ELCO Products are built to last. 5-year Limited warranty.

Product Number

Item	Watts	Voltage	Dimming
E8SQLFU15	19W	120/277V	0-10V

Product Custom Image

Compatible Products

For use with 8" Square New Construction IC Housing



8" Square LED Retrofit Insert

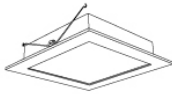

Square LED Insert

CAT NO.	SPECIFICATIONS
E822L1530W	19W, 1460 lm, 3000K