

# 3" Koto™ Architectural Shallow Maximum Adjustability IC Airtight Housing



Koto™ Architectural Housing: 120/277V (0-10V/Triac/ELV) or 120V (Triac/ELV) with optional Emergency Battery Backup. Must be used with Koto™ Architectural LED Light Engines (ELK19 or ELK21 Series). Lumen output based on module.

## Features

- IC Airtight for direct contact with insulation.
- Easy-to-Remove driver.
- Optional 90 minutes, 120/277 VAC, 60Hz, Emergency Backup.
- Flicker-Free Dimming.
- USA designed and assembled.
- Limited 5 year warranty.
- For use with ELCO Koto™ Architectural LED Light Engines (ELK19 or ELK21 Series).

## Specifications

|                      |                               |
|----------------------|-------------------------------|
| <b>Wattage</b>       | 14.7W                         |
| <b>Lumens</b>        | 850 (ELK19) - 1100 (ELK21) lm |
| <b>Voltage</b>       | 120/277V                      |
| <b>Dimmable</b>      | 0-10V/Triac/ELV               |
| <b>Lamp Type</b>     | LED                           |
| <b>Power Factor</b>  | ≥0.95                         |
| <b>Damp Location</b> | Listed                        |

## Technical Details

**Construction:** Single Wall IC Rated for direct contact with insulation. For use in IC and Non-IC conditions. Up to 1100 lumens. Housing adjusts in frame to accommodate up to 1 1/2" ceiling thickness. Airtight housing with gasket to restrict airflow in accordance with ASTM E-283 air-tight requirements.

**Installation:** Designed for ceiling plenums where 2x6 joists or taller are used. High strength hanger bars can easily be nailed to joists. Suitable for T-grid and drop ceiling applications. See installation sheet for detailed information. Emergency Battery Back-up Option requires access from above. For use with ELCO Koto™ Architectural LED Light Engines (ELK19 or ELK21 Series)

**Junction Box:** Positioned to accommodate straight conduit runs. Two 3/4" knockouts, Seven 1/2" trade size conduit knockouts, One 3/8" knockout. Four Pry-out knockout slots for easy romex installation.

**Hanger Bars:** Pre Installed hanger bars with True Nail easy installation in regular lumber, engineered lumber, and Laminated Beams. Integral T-bar slots for easy installation in T-Bars. Spans up 24" and can be repositioned 90°. Score lines allow for tool-free hanger bar size reduction. Integral leveling flange allows for single-person installation while easily aligning the housings with the joists.

**Electrical:** Driver is rated for 120V and 277V input (120/277V). High Efficiency driver with a power factor > 0.95.

**Emergency Battery Pack:** Optional 90 minute battery pack available with test indicator switch. Note that double wall housings require Access From Above Ceiling for Battery Maintenance.

**Dimmability:** 3-in-1 dimming: Triac, ELV and 0-10V dimming in one driver. 0-10V dimming down to 5% with a compatible dimmer. Can be specified with Lutron drivers for 0.1% and 1% dimming. For a full list of dimmers refer to the Dimmer Compatibility List.

**Listings:** UL Listed for Damp Location and for Wet Location with select trims. UL Listed for Direct Contact with Insulation and Combustible Material. UL Listed for Feed Through.

## E3LK76ICA Dimensions

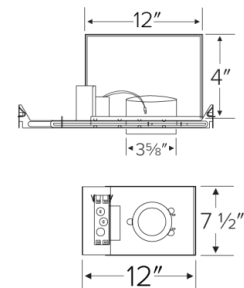

## E3LK77ICAD E3LK76ICA-S Dimensions

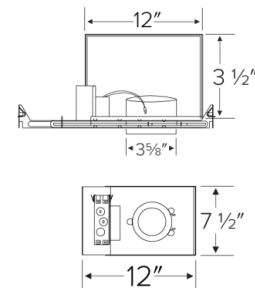

## Product Number

| Item       | Description                                  | Lamp type | Lumens                        | Watts | Voltage  | Dimming         |
|------------|----------------------------------------------|-----------|-------------------------------|-------|----------|-----------------|
| E3LK77ICAD | 3 1/2" Shallow Maximum Adjustability Housing | LED       | 850 (ELK19) - 1100 (ELK21) lm | 14.7W | 120/277V | 0-10V/Triac/ELV |

# Compatible Products

For use with Dedicated 3" Architectural ICA LED Housings



## Koto™ Architectural LED Light Engine

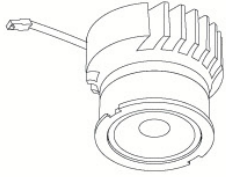

**Koto™ LED Light Engine**  
ELK21

| PRODUCT NUMBER BUILDER |                |                                                  |                                                                          |
|------------------------|----------------|--------------------------------------------------|--------------------------------------------------------------------------|
| Koto™ LED Light Engine | Lumens         | Color Temperature                                | Beam Angle                                                               |
| ELK                    | 21 1100-1500lm | 27D 2700K<br>30D 3000K<br>35D 3500K<br>40D 4000K | (blank) 38° lens (Standard)<br>-S 18° lens<br>-N 25° lens<br>-W 60° lens |

### ACCESSORIES



#### Lens

|        |          |
|--------|----------|
| EP731C | 18° Lens |
| EP732C | 25° Lens |
| EP733C | 38° Lens |
| EP734C | 60° Lens |

#### Reflectors

|        |     |
|--------|-----|
| EP735C | 15° |
| EP736C | 25° |
| EP737C | 38° |
| EP738C | 60° |

*\*EP732C, EP733C, EP734C Included*

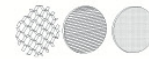

#### Secondary Optics

|     |               |
|-----|---------------|
| L45 | Hex Louver    |
| L46 | Linear Louver |
| L47 | Spread Louver |

## 3" Pex™ Twist-&-Lock Trims



**Deep Reflector**

ELK3618  
Finishes:  
(W, BB, BZ, B, C, H)



**Adjustable Gimbal**

ELK3629  
Finishes:  
(W, BB, BZ, B, C, H)



**Adjustable Pinhole**

ELK3627  
Finishes:  
(B, BB, BZ)



**Adjustable Baffle**

ELK3693  
Finishes:  
(W)



**Slot Aperture**

ELK3620  
Finishes:  
(W)



**Adj. Reflector Wall Wash**

ELK3622  
Finishes:  
(W)

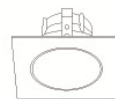

**Sq. Deep Reflector**

ELK3318  
Finishes:  
(W, BB, BZ, B, C, H)



**Sq. Adjustable Gimbal**

ELK3329  
Finishes:  
(W, BB, BZ, B, C, H)



**Sq. Adjustable Wall Wash**

ELK3322  
Finishes:  
(W)

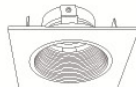

**Sq. Adjustable Baffle**

ELK3393  
Finishes:  
(W)



**Sq. Adjustable Pinhole**

ELK3327  
Finishes:  
(B, BB, BZ)

\*Finishes: **W** - All White, **BB** - All Black, **BZ** - All Bronze, **B** - Black Reflector w/White Ring, **C** - Chrome Reflector w/White Ring, **H** - Haze Reflector w/White Ring



Must be used with Maximum Adjustability Housing