

6" Super Sloped Ceiling LED Reflector Inserts

Sloped Ceiling LED inserts feature an integral gimbal for $\pm 25^\circ$ adjustability. Compatible with most incandescent and electronic low voltage dimmers.



Features

- Sloped Ceiling LED Inserts feature an integral gimbal for $\pm 25^\circ$ adjustability.
- Compatible with most incandescent and electronic low voltage dimmers.
- ENERGY STAR® Certified. California Title 24 (JA8-2016).
- Life Span: 50,000 hours L70.

Specifications

| | |
|----------------------|-----------------------------------|
| Wattage | 15W |
| Lumens | 1050 lm |
| Voltage | 120V |
| Color Temp. | 2700K, 3000K, 3500K, 4000K, 5000K |
| Dimmable | Triac/ELV |
| Lamp Type | LED |
| CRI | 90+ |
| Damp Location | Listed |

Options



White



Clear



Black

Technical Details

Optics: LED light engine has frosted polycarbonate lens with reflector to diffuse light evenly throughout while reducing glare.

Construction: Deep reflector trim with torsion springs to be held into the housing. High quality powder coat finish preventing rust and paint cracking on metal parts. Integral gimbal allows for 25° adjustability to match slope.

Installation: Designed to install into ELCO 6" Super Sloped ceiling housing with torsion springs brackets. For retrofitting other manufacturers sloped ceiling cans always test the product to ensure proper fit and function.

Electrical:

- Driver connects to 120VAC power supply.
- High efficiency, high power factor > 0.9 driver.

LED Technology:

- Accurate color rendering with 90+ CRI.
- Lumen Maintenance of 50,000 hours L70 Life based on LM80 standardized test results.
- Superior Thermal Management by utilizing aluminum diecast heat sink.

Housings: Compatible with EL971ICA, EL971RICA.

Dimmability:

- Dimmable with most standard TRIAC and ELV type dimmers.
- Dimming range of 100% down to 10%. Dimming range may vary depending on dimmer model.
- For full list of dimmers refer to the Dimmer Compatibility List.

Listings:

- UL Listed for Damp Location.
- ENERGY STAR® Certified.

Dimensions

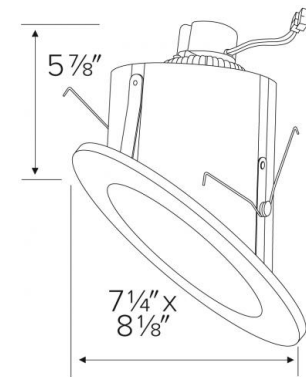

Product Number

| Item | Lamp type | Lumens | CCT | Watts | Voltage | Dimming | Finish |
|-----------|-----------|---------|-----------------------------------|-------|---------|-----------|--------|
| EL761CT5W | LED | 1050 lm | 2700K, 3000K, 3500K, 4000K, 5000K | 15W | 120V | Triac/ELV | White |

- California Title 24 (JA8-2016).

Warranty: ELCO Products are built to last. 5-year Limited warranty.

Product Number Builder Example: EL761CT5B

| ELCO 6" Reflector Insert | Wattage | Color Temp. | Finish |
|--------------------------|----------------|--------------------------|--|
| EL76 | 1 15W 2 18W | CT5 2700K - 5000K | W White C Clear B Black |

Compatible Products



For use with **6" LED Super Sloped Inserts**

6" Dedicated LED Super Sloped Ceiling IC Housings

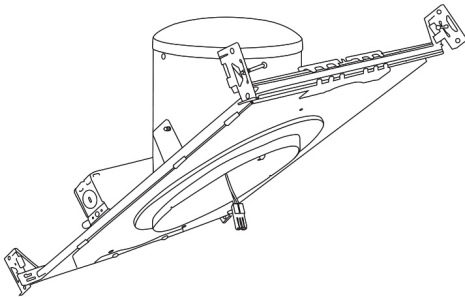

6" LED Sloped Housing
New Construction

| CAT NO. | SPECIFICATIONS |
|----------|----------------|
| EL971ICA | 24W Max. |

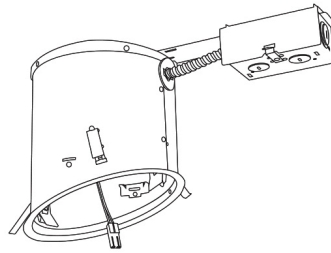

6" LED Sloped Housing
Remodel

| CAT NO. | SPECIFICATIONS |
|-----------|----------------|
| EL971RICA | 24W Max. |

6" E26 Base Super Sloped Ceiling Housings

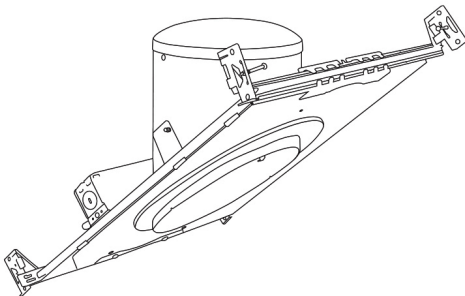

6" E26 Medium Base Sloped Housing
New Construction

| CAT NO. | SPECIFICATIONS |
|----------|----------------|
| EL901ICA | 75W Max. |

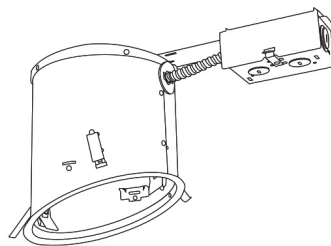

6" E26 Medium Base Sloped Housing
Remodel

| CAT NO. | SPECIFICATIONS |
|-----------|----------------|
| EL901RICA | 75W Max. |



PSA30
Medium base to Ideal terminal connector

Super Sloped Ceiling LED Reflector Insert

Multiplier: 2700K (x 0.96)

PHOTOMETRIC REPORT

Product #: EL76130
 Wattage/Lumens: 14.9W/ 1088 Lm
 Luminaire LPW: 73 Lm/W

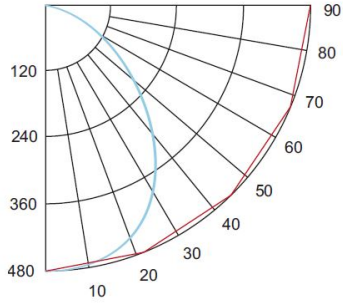

CANDLE POWER SUMMARY

| Degrees Vertical | 0° |
|------------------|------|
| 0 | 478 |
| 5 | 478 |
| 15 | 458 |
| 25 | 416 |
| 35 | 351 |
| 45 | 242 |
| 55 | 118 |
| 65 | 57 |
| 75 | 37 |
| 85 | 6.76 |
| 90 | 0.37 |

ILLUMINANCE AT A DISTANCE

| Distance to Target Plane | Footcandles Beam Center | Beam Diameter |
|--------------------------|-------------------------|---------------|
| 4' | 29.9 | 7.9' |
| 6' | 13.3 | 11.8' |
| 8' | 7.47 | 15.8' |
| 10' | 4.78 | 19.7' |

ZONAL LUMEN SUMMARY

| Zone | Lumens | % Luminaire |
|-------|---------|-------------|
| 0-30° | 363.84 | 33.50 |
| 0-40° | 584.11 | 53.70 |
| 0-60° | 947.75 | 87.10 |
| 0-90° | 1085.01 | 99.80 |

Super Sloped Ceiling LED Reflector Insert

Multiplier: 2700K (x 0.96)

PHOTOMETRIC REPORT

Product #: EL76230
 Wattage/Lumens: 17.1W/ 1191 Lm
 Luminaire LPW: 70 Lm/W

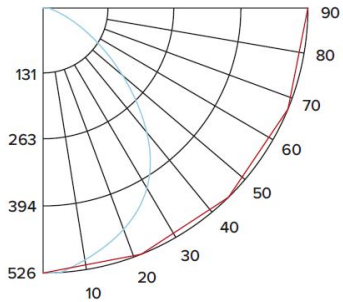

CANDLE POWER SUMMARY

| Degrees Vertical | 0° |
|------------------|-----|
| 0 | 524 |
| 5 | 523 |
| 15 | 501 |
| 25 | 456 |
| 35 | 384 |
| 45 | 265 |
| 55 | 129 |
| 65 | 63 |
| 75 | 41 |
| 85 | 7 |
| 90 | 0 |

ILLUMINANCE AT A DISTANCE

| Distance to Target Plane | Footcandles Beam Center | Beam Diameter |
|--------------------------|-------------------------|---------------|
| 4' | 32.7 | 7.9' |
| 6' | 14.5 | 11.8' |
| 8' | 8.18 | 15.8' |
| 10' | 5.24 | 19.7' |

ZONAL LUMEN SUMMARY

| Zone | Lumens | % Luminaire |
|-------|---------|-------------|
| 0-30° | 398.39 | 33.50 |
| 0-40° | 639.58 | 53.70 |
| 0-60° | 1037.74 | 87.10 |
| 0-90° | 1188.04 | 99.80 |