

5" Sloped Reflector Trim

ELCO Slant allows for installation in sloped ceilings ranging from 2/12 (10°) to 12/12 (45°). Can be used in insulated ceilings. Fits in 2" x 8" joist construction.



Features

- Sloped Reflector.
- Lamp: 75W MAX. PAR30 or LED.
- O.D.: 7 1/8" x 7 1/2".

Technical Details

Construction: Meticulously manufactured trim with a powder coated or anodized finish.

Installation: Clips securely mount trim into the housing and keeps ring flush with ceiling.

Compatible Housing: Compatible with EL518ICA & EL518RICA.

Lamp: Compatible with Medium base (E26) PAR type.

Options



All White



All Black



Clear w/White Ring

Product Number

Item	Finish
EL555B	All Black

Product Number Builder Example: EL555B

5" Sloped Reflector Trim	Finish
EL555	B

- B** All Black
- C** Clear w/White Ring
- W** All White

Product Custom Image

Compatible Products

For use with **5" Sloped Trims**

5" E26 Base Sloped Ceiling IC Housings

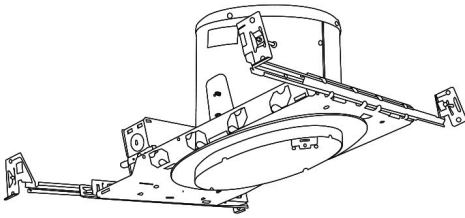

5" E26 Medium Base Sloped Housing
New Construction

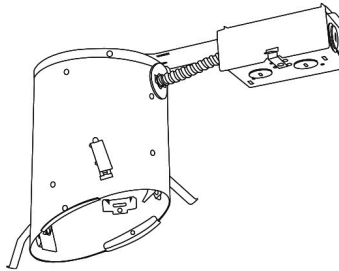

5" E26 Medium Base Sloped Housing
Remodel

CAT NO.	SPECIFICATIONS
EL518ICA	75W Max.

CAT NO.	SPECIFICATIONS
EL518RICA	75W Max.