

2" IC Airtight Housing

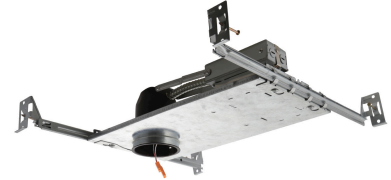

Features

- Single Wall IC.
- Height allows for use in 2x4 construction.
- Driver included on housing.
- CA Title 24 compliant (JA8-2016-E).
- LED Light Engine sold separately.
- U.S. Patent 10,281,131.

Specifications

Wattage	9W
Voltage	120V
Dimmable	Triac/ELV
Wet Location	Listed

Dimensions

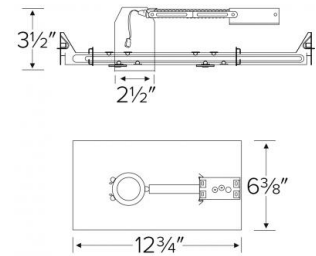

Technical Details

Construction:

- IC Rated for Direct Contact with Insulation, for use in IC and non-IC conditions.
- Housing adjusts in frame to accommodate up to 1 1/4" ceiling thickness.
- Aluminum housing for greater heat dissipation. Stamped galvanized steel frame.
- Driver mounted on junction box for cooler LED operation.

Installation: Designed for shallow ceiling plenums where 2x4 joists or taller are used. High strength hanger bars can easily be nailed to joists. Maximum hole cutout is 2 5/8". Suitable for T-grid and drop ceiling applications. See installation sheet for detailed information.

Junction Box: Positioned to accommodate straight conduit runs. Two 1/4" trade size knockouts with conduit fitting, Seven 1/2" trade size pry-out knockouts, Four 3/4" knockouts, One 1" knockout. Strain clamps to install or remove covers for easy access and grounding.

Hanger Bars: Pre-installed hanger bars with True Nail easy installation in regular lumber, engineered lumber, and Laminated Beams. Integral T-bar slots for easy installation in T-Bars. Spans up 24" and can be repositioned 90°. Score lines allow for tool-free hanger bar size reduction. Integral leveling flange allows for single-person installation while aligning the housings with the joists.

Electrical: Driver connects to 120V power supply. High Efficiency driver with a power factor > 0.9.

Dimmability: Works with 120V Triac and ELV type dimmers. Dims down to 10%. For full list of dimmers refer to the Dimmer Compatibility List.

Trims: Compatible with - E210C06, E213C06, E214C06, E215C06, E218C06, E219C06 series.

Listings: UL Listed for Wet Location. UL Listed for Direct Contact with Insulation and Combustible Material. UL Listed for Feed Through. Meets restricted airflow requirements (per ASTM E-283). ENERGY STAR® Certified. California Title 24 (JA8-2016-E).

Warranty: ELCO Products are built to last with a 5-year Limited warranty.

Product Numbers

Item	Description	Watts	Voltage	Dimming
E2LC175ICA		9W	120V	Triac/ELV
E2LC175ICA-EM1	90 minute Emergency Battery Backup			

Compatible Products

For use with Standard Alder™ Housings

2" Alder™ LED Light Engines

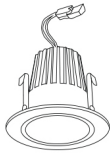

Round LED Light Engine Reflector Trim

CAT NO.	SPECIFICATIONS
E210C0627W	600 lm/2700K
E210C0630W	640 lm/3000K
E210C0727W	800 lm/2700K
E210C0730W	840 lm/3000K
E210C0740W	875 lm/4000K

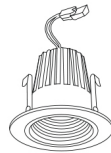

Round LED Light Engine Baffle Trim

CAT NO.	SPECIFICATIONS
E214C0627W	600 lm/2700K
E214C0630W	640 lm/3000K
E214C0727W	800 lm/2700K
E214C0730W	840 lm/3000K
E214C0740W	875 lm/4000K

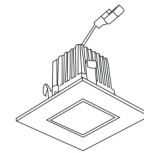

Square LED Light Engine Reflector Trim

CAT NO.	SPECIFICATIONS
E213C0627W	600 lm/2700K
E213C0630W	640 lm/3000K
E213C0727W	800 lm/2700K
E213C0730W	840 lm/3000K
E213C0740W	875 lm/4000K

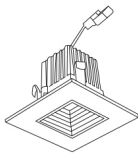

Square LED Light Engine Baffle Trim

CAT NO.	SPECIFICATIONS
E215C0627W	600 lm/2700K
E215C0630W	640 lm/3000K
E215C0727W	800 lm/2700K
E215C0730W	840 lm/3000K
E215C0740W	875 lm/4000K



Adjustable Round LED Light Engine

CAT NO.	SPECIFICATIONS
E218C0627W	650 lm/2700K
E218C0630W	680 lm/3000K
E218C0727W	850 lm/2700K
E218C0730W	880 lm/3000K
E218C0740W	915 lm/4000K

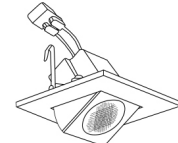

Adjustable Square LED Light Engine

CAT NO.	SPECIFICATIONS
E219C0627W	650 lm/2700K
E219C0630W	680 lm/3000K
E219C0727W	850 lm/2700K
E219C0730W	880 lm/3000K
E219C0740W	915 lm/4000K

Accessories

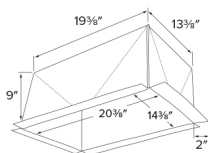

Fire Enclosure

CAT NO.	SPECIFICATIONS
FIREENCL	20 3/8" L x 14 3/8" W

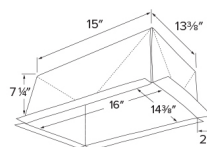

Shallow Fire Enclosure

CAT NO.	SPECIFICATIONS
FIREENCL-S	16" L x 14 3/8" W

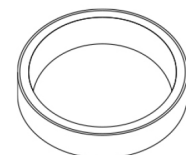

Mica Fire Tape

CAT NO.	SPECIFICATIONS
FIRETAPE	3/4" W x 16' L

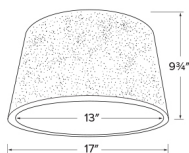

Fire Cover

CAT NO.	SPECIFICATIONS
FIRECVR	9 3/4" H x 17" O.D.

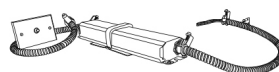

Emergency Battery Backup

CAT NO.	SPECIFICATIONS
KEM-LD3	8W, Up to 750 lm
KEM-LD4	12W, Up to 1100 lm