

Universal P-Trap # 005036..92 / 005036..92

| < 2 3/4 " > |

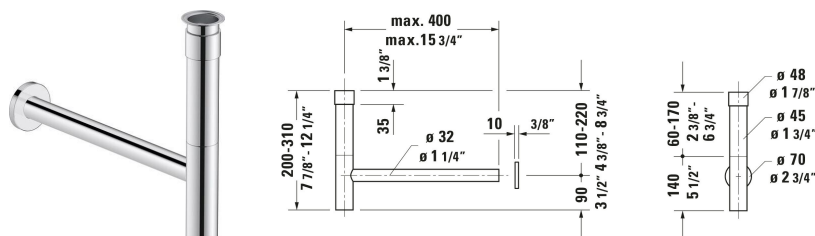

P-Trap	Dimension	Weight	Order number
Material: Brass, Outlet: horizontal, Suitable for Wall Mounted Sink			
Colors			
10 Chrome 46 Black Matte			
Variant			
Chrome Polished	3 "x24 "	3.307 lb	005036..92
Black Matte		3.307 lb	005036..92
Spare parts			
Console Number of storage surface: 1, Number of towel rails: 2, Pedestal color: Chrome High Gloss Aluminum, Adjustable height	38 3/4 x 17 3/4 "	26.455 lb	WT4547 B
Console Number of storage surface: 1, Number of towel rails: 2, Pedestal color: Chrome High Gloss Aluminum, Adjustable height	26 7/8 x 17 3/4 "	20.944 lb	WT4546 B
Console Number of storage surface: 1, Number of towel rails: 1, Pedestal color: Chrome High Gloss Aluminum, Adjustable height	38 3/4 x 17 3/4 "	26.455 lb	WT4544 L/R
Console Number of storage surface: 1, Number of towel rails: 1, Pedestal color: Chrome High Gloss Aluminum, Adjustable height	26 7/8 x 17 3/4 "	20.944 lb	WT4543 L/R
Vanity Cabinet Number of drawers: 3, Without handle	16 1/8 x 16 1/8 "	33.069 lb	WT4239
c-bonded Console Sink Handle: Black Matte, laminate, Number of drawers: 1, Without handle, Pressure inlet, Drawer organizer Optional, Pedestal material: Aluminum, Adjustable height, Includes sink, Overflow: Yes, Includes faucet deck: Yes, Includes ceramic drain cover, incl. push-open waste, Includes faucets: No	38 3/8 x 19 1/4 "	91.492 lb	HP4743 N/O
c-bonded Console Sink Handle: Black Matte, laminate, Number of drawers: 1, Without handle, Pressure inlet, Drawer organizer Optional, Pedestal material: Aluminum, Adjustable height, Includes sink, Overflow: Yes, Includes faucet deck: Yes, Includes ceramic drain cover, incl. push-open waste, Includes faucets: No	30 1/2 x 19 1/4 "	77.162 lb	HP4742 N/O
c-bonded Console Sink Handle: Black Matte, laminate, Pedestal material: Aluminum, Adjustable height, Includes sink, Overflow: Yes, Includes faucet deck: Yes, Includes ceramic drain cover, incl. push-open waste, Includes faucets: No	38 3/8 x 19 1/4 "	74.957 lb	HP4738 N/O

Universal P-Trap # 005036..92 / 005036..92

| < 2 3/4 " > |

c-bonded Console Sink Handle: Black Matte, laminate, Pedestal material: Aluminum, Adjustable height, Includes sink, Overflow: Yes, Includes faucet deck: Yes, Includes ceramic drain cover, incl. push-open waste, Includes faucets: No	30 1/2 x 19 1/4 "	61.729 lb	HP4737 N/O
c-bonded Console Sink Handle: Black Matte, laminate, Number of drawers: 1, Without handle, Pressure inlet, Drawer organizer Optional, Pedestal material: Aluminum, Adjustable height, Includes sink, Overflow: Yes, Includes faucet deck: Yes, Includes ceramic drain cover, incl. push-open waste, Includes faucets: No	22 5/8 x 19 1/4 "	64.816 lb	HP4740 N/O
c-bonded Console Sink Handle: Black Matte, laminate, Pedestal material: Aluminum, Adjustable height, Includes sink, Overflow: Yes, Includes faucet deck: Yes, Includes ceramic drain cover, incl. push-open waste, Includes faucets: No	22 5/8 x 19 1/4 "	48.502 lb	HP4735 N/O
Vessel Sink Includes faucet deck: Yes, Back side glazed: Yes, 19 5/8 "	19 5/8 x 18 1/2 "	33.951 lb	238550
Vessel Sink Includes faucet deck: Yes, Back side glazed: Yes, 23 5/8 "	23 5/8 x 18 1/2 "	36.376 lb	238560
Wall Mounted Sink White, Includes faucet deck: Yes, Underside glazed, Back side glazed: No, 47 1/2 "	47 1/2 x 18 7/8 "	59.525 lb	236712
Wall Mounted Sink Rectangular, Number of basins: 1 Middle, Includes faucet deck: Yes, Overflow: Yes, Underside glazed, 23 5/8 ", ADA: Yes	23 5/8 x 18 7/8 "	2.202 lb	236760
Wall Mounted Sink D-shaped, Includes faucet deck: Yes, Overflow: Yes, Underside glazed, 39 5/8 ", ADA: Yes	39 5/8 x 18 7/8 "	59.525 lb	236710
Wall Mounted Sink D-shaped, Includes faucet deck: Yes, Overflow: Yes, Underside glazed, Back side glazed: No, 25 5/8 "	25 5/8 x 17 3/8 "	43.211 lb	236665
Wall Mounted Sink D-shaped, Includes faucet deck: Yes, Overflow: Yes, Underside glazed, Back side glazed: No, 23 5/8 "	23 5/8 x 17 3/8 "	39.242 lb	236660
Wall Mounted Sink D-shaped, Includes faucet deck: Yes, Overflow: Yes, Underside glazed, Back side glazed: No, 21 5/8 "	21 5/8 x 17 3/8 "	34.833 lb	236655
Wall Mounted Sink D-shaped, Includes faucet deck: Yes, Overflow: Yes, Underside glazed, Back side glazed: No, 31 1/2 ", ADA: Yes	31 1/2 x 18 7/8 "	48.502 lb	237080
Wall Mounted Sink D-shaped, Includes faucet deck: Yes, Overflow: Yes, Underside glazed, Back side glazed: No, 31 1/2 ", ADA: Yes	31 1/2 x 18 7/8 "	48.502 lb	236980
Wall Mounted Sink D-shaped, Includes faucet deck: Yes, Overflow: Yes, Underside glazed, 31 1/2 ", ADA: Yes	31 1/2 x 18 7/8 "	48.502 lb	236780
Wall Mounted Sink Rectangular, Includes faucet deck: Yes, Overflow: Yes, Underside glazed, Back side glazed: No, 25 5/8 ", ADA: Yes	25 5/8 x 18 7/8 "	44.092 lb	236765
Vessel Sink DuraCeram®, Oval, Includes faucet deck: Yes, Overflow: No, Ground, Includes ceramic drain cover, Includes slotted waste, 27 1/2 ", ADA: Yes	27 1/2 x 15 3/4 "	26.896 lb	038070
Vessel Sink DuraCeram®, Oval, Includes faucet deck: Yes, Overflow: No, Ground, Includes ceramic drain cover, Includes slotted waste, 19 5/8 ", ADA: Yes	19 5/8 x 13 3/4 "	17.416 lb	038050
Vessel Sink DuraCeram®, Oval, Includes faucet deck: No, Overflow: No, Ground, Includes ceramic drain cover, Includes slotted waste, 27 1/2 "	27 1/2 x 15 3/4 "	24.912 lb	037970

Universal P-Trap # 005036..92 / 005036..92

| < 2 3/4 " > |

Vessel Sink DuraCeram®, Oval, Includes faucet deck: No, Overflow: No, Ground, Includes ceramic drain cover, Includes slotted waste, 19 5/8 "	19 5/8 x 13 3/4 "	15.653 lb	037950
Vessel Sink DuraCeram®, Oval, Includes faucet deck: Yes, Overflow: No, Ground, Includes ceramic drain cover, Includes slotted waste, 16 1/2 ", ADA: Yes	16 1/2 x 10 5/8 "	11.905 lb	038142
Vessel Sink DuraCeram®, Oval, Includes faucet deck: Yes, Overflow: No, Ground, Includes ceramic drain cover, Includes slotted waste, 23 5/8 ", ADA: Yes	23 5/8 x 15 3/4 "	23.149 lb	038060
Vessel Sink DuraCeram®, Oval, Includes faucet deck: Yes, Overflow: No, Ground, Includes ceramic drain cover, Includes slotted waste, 31 1/2 ", ADA: Yes	31 1/2 x 15 3/4 "	27.999 lb	038080
Vessel Sink DuraCeram®, Oval, Includes faucet deck: No, Overflow: No, Ground, Includes ceramic drain cover, Includes slotted waste, 31 1/2 "	31 1/2 x 15 3/4 "	27.558 lb	037980
Vessel Sink DuraCeram®, Oval, Includes faucet deck: No, Overflow: No, Ground, Includes ceramic drain cover, Includes slotted waste, 23 5/8 "	23 5/8 x 15 3/4 "	19.621 lb	037960

All drawings contain the necessary measurements which are subject to standard tolerances. They are stated in inch & mm and are non-binding. Exact measurements, in particular for customized installation scenarios, can only be taken from the finished ceramic piece.