

Vero Air Semi-Recessed Sink # 0382550000 / 0382550060 / 0382550087

| < 21 5/8 " > |

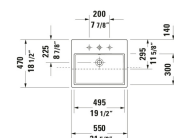
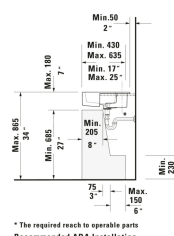
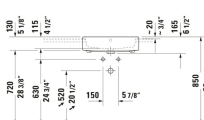
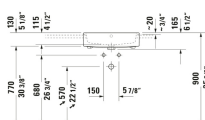

* The required reach to operable parts
Recommended ADA Installation

Semi-Recessed Sink	Dimension	Weight	Order number
Installation Type: Installation, 21 5/8 "x18 1/2 ", Includes faucet deck: Yes, Overflow: Yes, Installation Type: Drop-in installation, Includes hardware for installation in wooden consoles, Underside glazed, ADA: Yes			
Colors			
00 White			
Variant			
● White High Gloss, Number of faucet holes: 1, cUPC listed: No	21 5/8 "x6 1/2 "	35.715 lb	0382550000
⊗ White High Gloss, cUPC listed: No	21 5/8 "x6 1/2 "	35.715 lb	0382550060
White High Gloss, Number of faucet holes: 3	21 5/8 "x6 1/2 "	35.715 lb	0382550087
Spare parts			
Sink Drain Suitable for washbasin with overflow, Ø 2 1/2 "	Ø 2 1/2 "	0.75 lb	005052

All drawings contain the necessary measurements which are subject to standard tolerances. They are stated in inch & mm and are non-binding. Exact measurements, in particular for customized installation scenarios, can only be taken from the finished ceramic piece.