

D-Neo Wall Mounted Sink # 2367800000 / 2367800060 / 2367800087

| < 31 1/2 " > |

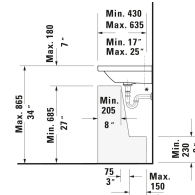
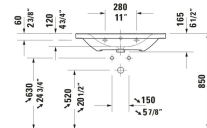
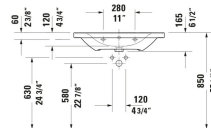
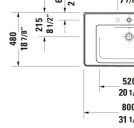
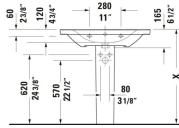
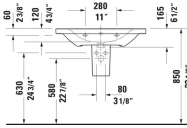

* The required reach to operable parts
Recommended ADA Installation

Wall Mounted Sink	Dimension	Weight	Order number
D-shaped, Includes faucet deck: Yes, Overflow: Yes, Underside glazed, 31 1/2 ", ADA: Yes			
Colors			
00 White			
Variant			
● White High Gloss, Rectangular, Number of basins: 1 Middle, Number of faucet holes: 1 Middle, Back side glazed: No	31 1/2 "x6 1/2 "	48.502 lb	2367800000
☒ White High Gloss, Rectangular, Number of basins: 1 Middle, Back side glazed: No	31 1/2 "x6 1/2 "	48.502 lb	2367800060
White High Gloss, Number of basins: 1 Middle, Number of faucet holes: 3, Back side glazed: No	31 1/2 "x6 1/4 "	48.502 lb	2367800087
Spare parts			
Sink Drain Suitable for washbasin with overflow, Ø 2 1/2 "	Ø 2 1/2 "	0.75 lb	005052
P-Trap	12 1/4 x 4 1/2 "	0.705 lb	005026
P-Trap Material: Brass, Outlet: horizontal, Suitable for Wall Mounted Sink	2 3/4 x 16 3/4 "	3.307 lb	005036
Suitable products			
Vanity Cabinet Number of drawers: 1, Number of drawers: 1, Handle, Siphon cut-out: Yes, Panel: Yes, Slow close, Lay-in compartment Optional, Required Items: Wall Mounted Sink D-Neo # 236780, 30 7/8 x 17 3/4 "	30 7/8 x 17 3/4 "		DE4355
Vanity Cabinet Number of drawers: 1, Handle Anthracite, Slow close, Lay-in compartment Optional, Required Items: Wall Mounted Sink D-Neo # 236780, 236980, 237080, 30 7/8 x 17 7/8 "	30 7/8 x 17 7/8 "		K25083

**D-Neo Wall Mounted Sink # 2367800000 / 2367800060 /
2367800087**

|< 31 1/2 " >|

Vanity Cabinet Number of drawers: 2, Handle Anthracite, Siphon
cut-out: Yes, Panel: Yes, Slow close, Lay-in compartment
Optional, Required Items: Wall Mounted Sink D-Neo # 236780, 30 7/8 x 17 7/8 "
30 7/8 x 17 7/8 "

K25283

All drawings contain the necessary measurements which are subject to standard tolerances. They are stated in inch & mm and are non-binding. Exact measurements, in particular for customized installation scenarios, can only be taken from the finished ceramic piece.