

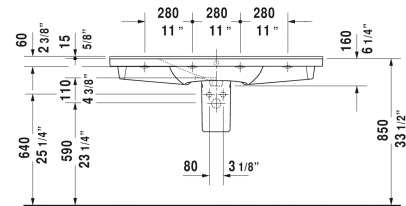

P3 Comforts Furniture washbasin ☒ # 2332120000 /
2332120030 / 2332120060

< 49 1/4" Inch >

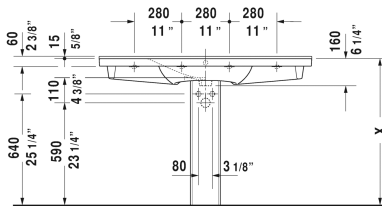
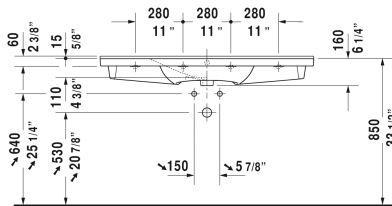
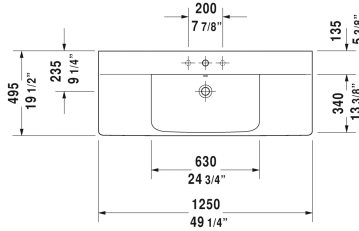

Furniture washbasin	Dimension	Weight	Order number
with overflow, with faucet deck, overflow clip Chrome included, hardware included, wall-mounted, 49 1/4" Inch			
Colors			
00 White			
Variant			
●	49 1/4" x 19 1/2" Inch	72.8 lb	2332120000
●●●	49 1/4" x 19 1/2" Inch	72.8 lb	2332120030
☒	49 1/4" x 19 1/2" Inch	72.8 lb	2332120060
Infobox			
Washbasin is not ADA compliant in combination with pedestal, siphon cover or metal console			
Sanitary ceramics with the special WonderGliss surface finish will remain clean and attractive-looking for a long time to come. When ordering WonderGliss please add a "1" as eleventh digit to the model number.			
Space-saving siphon	1 1/4" Inch	0.9 lb	005076
Suitable products			
Vanity unit wall-mounted 1 pull-out compartment, for P3 Comforts # 233212, 233312, 233412, 48" x 19" Inch	48" x 19" Inch		LC6153
Vanity unit wall-mounted 2 drawers, upper drawer including cut-out for siphon and siphon cover, for P3 Comforts # 233212, 48" x 19" Inch	48" x 19" Inch		LC6253

P3 Comforts Furniture washbasin  # 2332120000 /
2332120030 / 2332120060

|< 49 1/4" Inch >|

Vanity unit floorstanding 2 pull-out compartments, for P3 Comforts # 233212, 233312, 233412, 48" x 19" Inch	48" x 19" Inch	LC6603
Siphon cover for # 233155, 233160, 233165, 233265, 233285, 233210, 233212, 233385, 233310, 233312, 233485, 233410, 233412, 6 3/4" x 11 3/4" Inch	6 3/4" x 11 3/4" Inch	085837
Pedestal for # 233155, 233160, 233165, 233265, 233285, 233210, 233212, 233385, 233310, 233312, 233485, 233410, 233412, 6 7/8" x 8 1/4" Inch	6 7/8" x 8 1/4" Inch	085836

All drawings contain the necessary measurements which are subject to standard tolerances. They are stated in inch & mm and are non-binding. Exact measurements, in particular for customized installation scenarios, can only be taken from the finished ceramic piece.