

Final Assembly

1. Dress wires neatly to prevent pinching.

2. Align housing slots over back plate tabs.

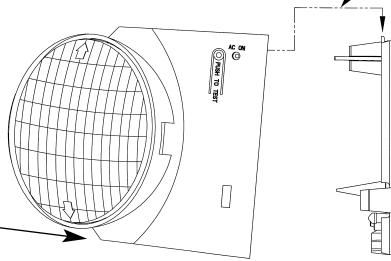

3. Pivot housing and snap closed.

4. Energize unit. Charge a minimum of 24 hours prior to testing.

5. Press test switch and hold. Aim lamp heads for proper light distribution.



CV and NV Series

Emergency Lighting Units Installation Instructions

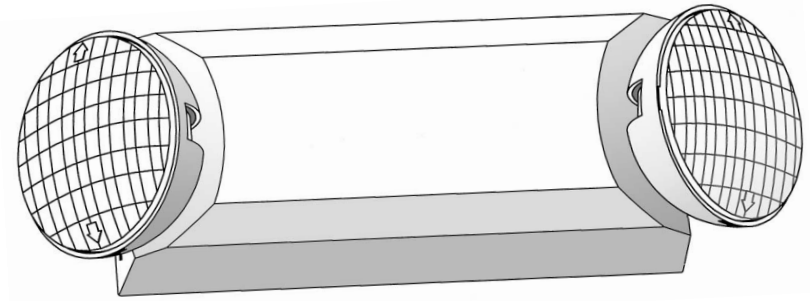

TROUBLE SHOOTING

AC-On Light does not illuminate

- Check AC wiring connections.

Emergency lamps do not work

- Battery is shipped disconnected. Connect red lead from PC board to positive (+) battery terminal and charge before testing.
- Make sure charger board is properly seated.
- Check wiring connections.

MAINTENANCE

Units should be tested and maintained in accordance with National Electrical Code and NFPA 101 Life Safety Code requirements. It is recommended that emergency lighting units be tested for 30 seconds once a month and for 90 minutes once a year.

RECYCLING INFORMATION

All thermoplastic parts are recyclable.
All cartons contain recycled materials. Please recycle.



NOTICE:

Units contain rechargeable lead-acid or nickel-cadmium batteries which must be recycled or disposed of properly.

1300865, 1300866
1300867, 1300868
1300869, 1300909

LAMP REPLACEMENT

CAUTION: Allow defective lamp to cool completely before attempting replacement.

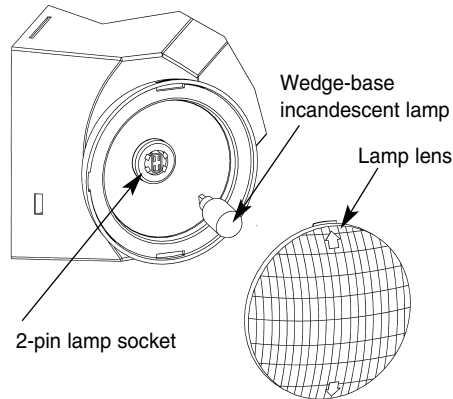

1. Remove plastic lamp lens by prying carefully with screwdriver at arrow locations.
2. Pull defective lamp from lighting head assembly and unplug lamp from socket.
3. Plug replacement lamp into socket and install lamp into lighting head assembly.
4. Re-install lamp lens.

IMPORTANT SAFEGUARDS

When using electrical equipment, basic safety precautions should always be followed including the following:

READ AND FOLLOW ALL SAFETY INSTRUCTIONS

1. Do not use outdoors.
2. Do not mount near heaters or hot surfaces.
3. Equipment should be mounted in locations and at heights where it will not readily be subjected to tampering by unauthorized personnel.
4. The use of accessory equipment not authorized by the manufacturer may cause an unsafe condition.
5. Do not use this equipment for other than its intended purpose.
6. Service of this equipment should be performed by qualified service personnel.

Emergency Lighting And Power Equipment For Use In Damp Locations

Damp location listed units are suitable for installation in:

1. Interior locations subject to moderate degrees of moisture, such as some basements, some barns, some cold-storage warehouses, and the like.
2. Partially protected locations under canopies, marquees, roofed open porches and the like.

SAVE THESE INSTRUCTIONS



Hubbell Lighting, Inc.

INSTALLATION INSTRUCTIONS

Battery Installation

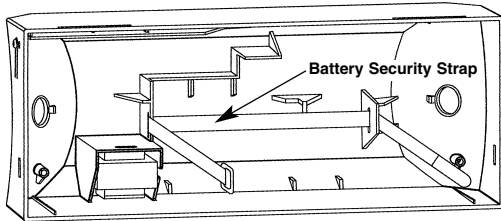

On models shipped with battery uninstalled, check that battery security strap is positioned as shown above.

Battery Connections:

Connect yellow circuit board lead to battery negative (-) terminal.

Note: On factory installed batteries, yellow battery lead is shipped connected.

Connect red circuit board lead to battery positive (+) terminal.

Lead-Calcium Battery Models

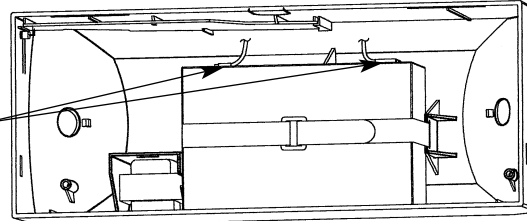

- 1) Place battery in housing as shown above in front of security strap.
- 2) Fasten by tightening security strap.

Nickel-Cadmium Battery Models

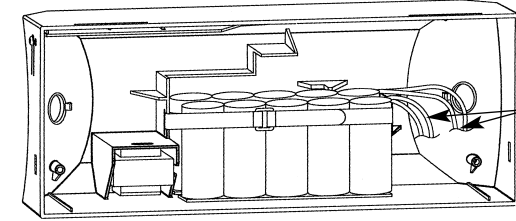

Battery Connections:

Connect battery harness leads from circuit board to corresponding leads from battery assembly.

- 1) Remove double-sided tape protective layer on bottom of battery assembly.
- 2) Position battery in housing in front of security strap as shown above and press battery firmly in place.
- 3) Fasten by tightening security strap.

Wall Mount – Back Power Feed

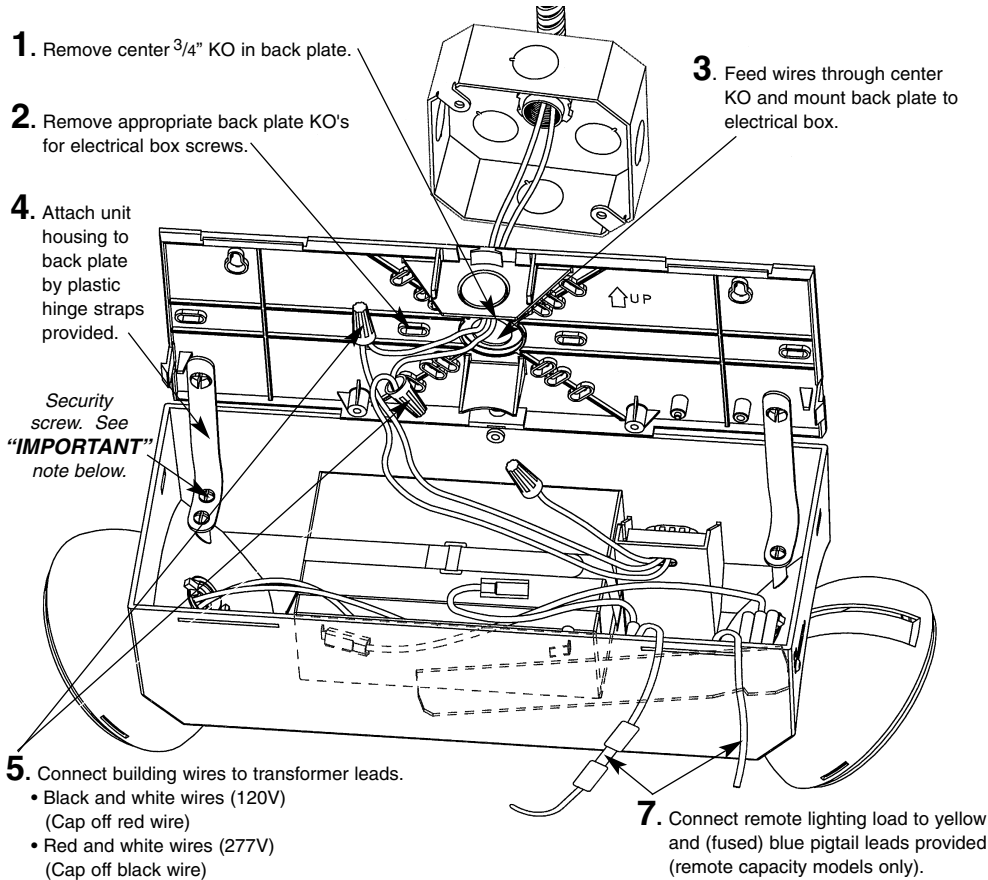

1. Remove center $\frac{3}{4}$ " KO in back plate.
2. Remove appropriate back plate KO's for electrical box screws.
3. Feed wires through center KO and mount back plate to electrical box.
4. Attach unit housing to back plate by plastic hinge straps provided.
5. Connect building wires to transformer leads.
 - Black and white wires (120V) (Cap off red wire)
 - Red and white wires (277V) (Cap off black wire)
7. Connect remote lighting load to yellow and (fused) blue pigtail leads provided (remote capacity models only).

Wall Mount – Surface Wiring (Top Power Feed Only)

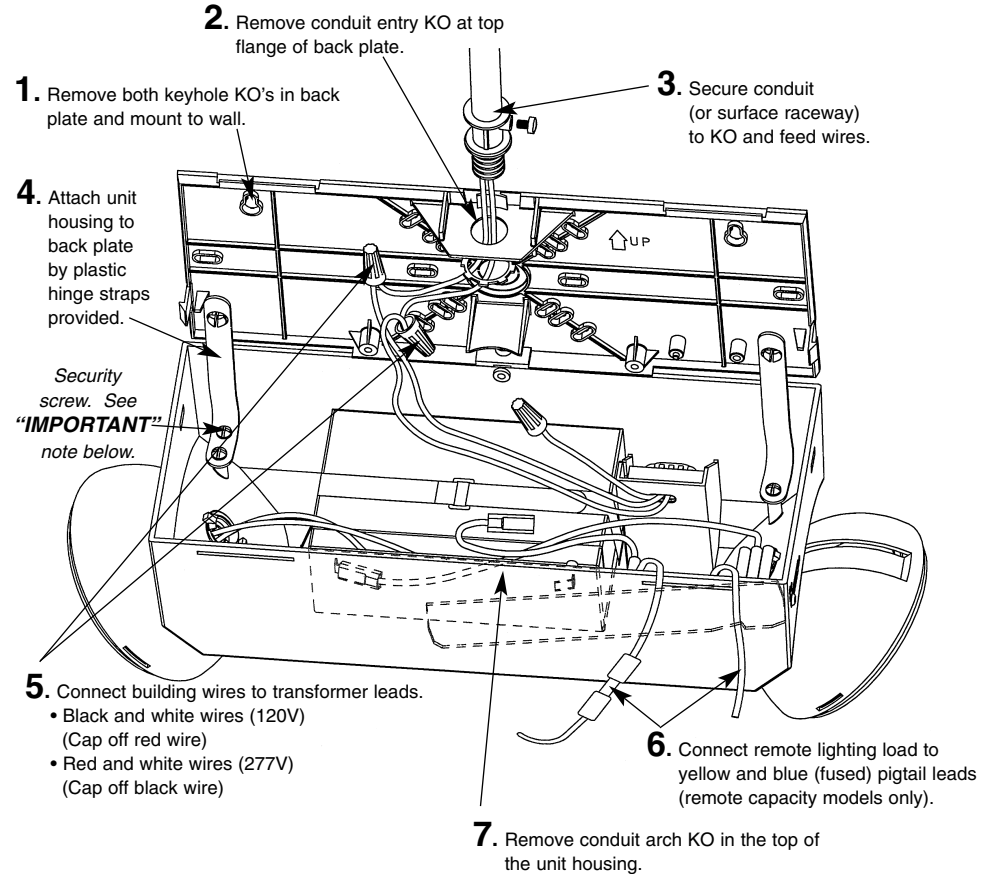

1. Remove both keyhole KO's in back plate and mount to wall.
2. Remove conduit entry KO at top flange of back plate.
3. Secure conduit (or surface raceway) to KO and feed wires.
4. Attach unit housing to back plate by plastic hinge straps provided.
5. Connect building wires to transformer leads.
 - Black and white wires (120V) (Cap off red wire)
 - Red and white wires (277V) (Cap off black wire)
6. Connect remote lighting load to yellow and blue (fused) pigtail leads (remote capacity models only).
7. Remove conduit arch KO in the top of the unit housing.

IMPORTANT: Install security screw if additional protection against tampering is desired. Use pointed tool to remove KO at bottom center of unit chassis. After closing unit, install security screw through bottom KO and tighten. To complete installation, see Final Assembly instructions on back page.