

Cask Cabinet Pull



Specifications

| | |
|-----------------------|---------------------------|
| Metal Material | 100% Zinc alloy |
| Packaging | Poly bag |
| Mounting: | 64 MM C-C |
| Hardware: | two 8-32 screws; included |



Dimensions

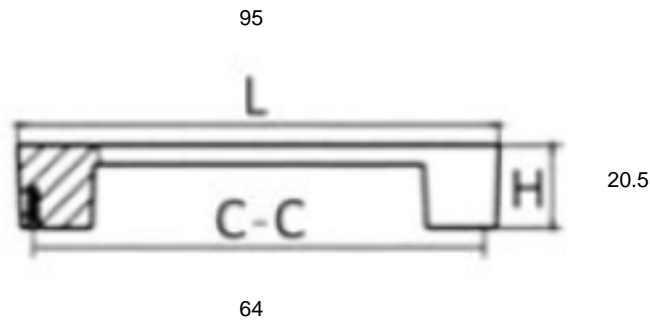

Warranty & Compliances

| | |
|------------------|-------------------------|
| Warranty | Limited 1 year warranty |
| ANSI/BHMA | N/A |



Order Codes

| | |
|-----------------------|--------|
| Antique Brass | 205583 |
| Antique Pewter | 205591 |

| |
|--------------------|
| Type: |
| Job: |
| Order Code: |
| Approvals: |

Design House reserves the right to make changes in materials, specifications & models at any time. Design House also reserves the right to discontinue product without notice or obligation.