

All Models

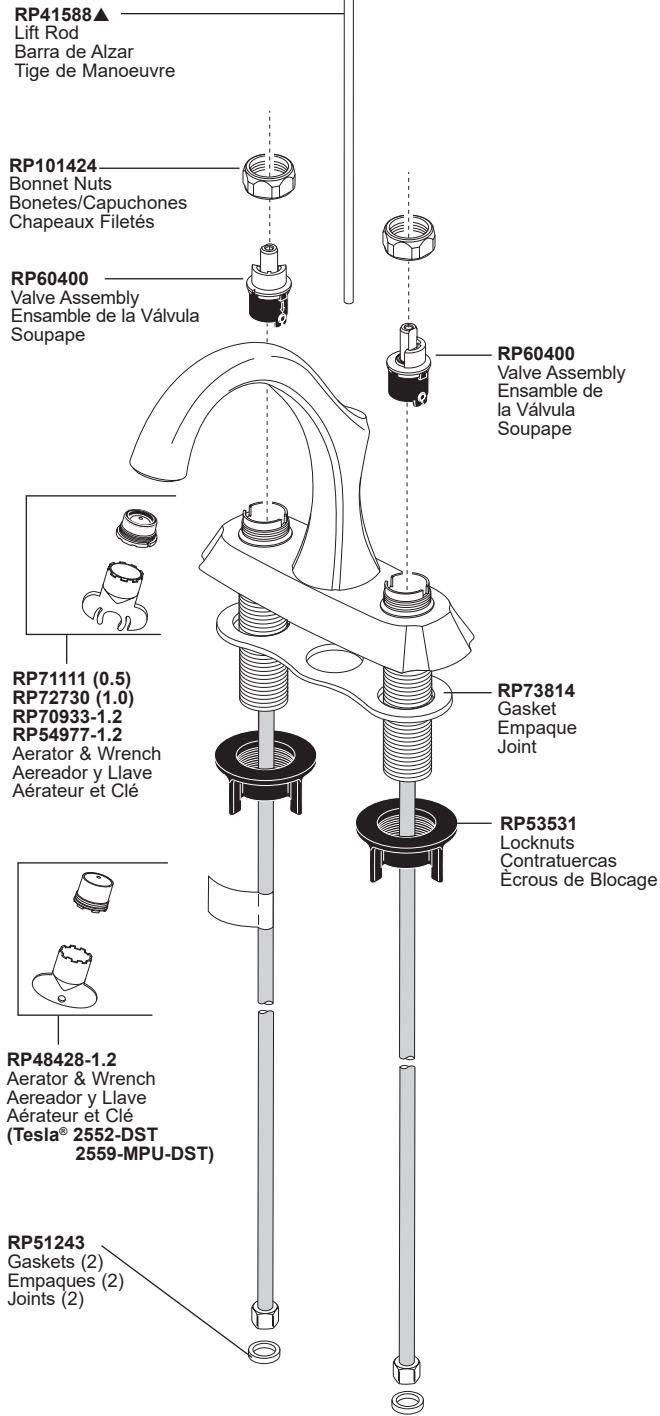

2538-DST

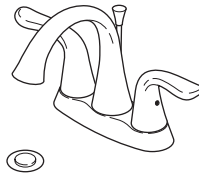

H238▲

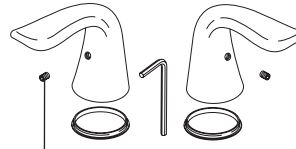

RP25620
Set Screw (2)
Tornillo de Ajuste (2)
Vis de Calage (2)

RP54971▲
Lift Rod & Finial
Barra de Alzar y Pomo
Tige de Manoeuvre et
Grain de la Tirette



2551-DST

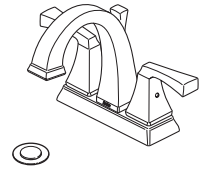

H251▲

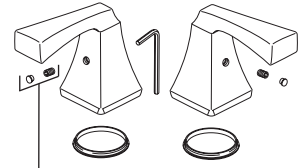

RP52658▲
Set Screw and Button (2)
Tornillo de Ajuste y Botón (2)
Vis de Calage et Bouton (2)

RP54095▲
Lift Rod & Finial
Barra de Alzar y Pomo
Tige de Manoeuvre et
Grain de la Tirette



2552-DST

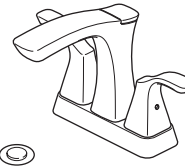

H252▲

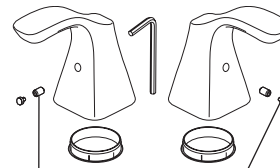

RP25620
Set Screw (2)
Tornillo de Ajuste (2)
Vis de Calage (2)

RP78524▲
Button Covers
Cubre botón
Couvre-boutons



2555-DST



RP64476▲

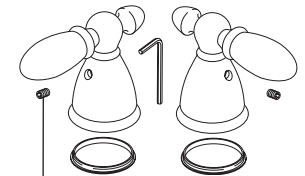

RP25620
Set Screw (2)
Tornillo de Ajuste (2)
Vis de Calage (2)

RP91401▲
Lift Rod & Finial
Barra de Alzar y Pomo
Tige de Manoeuvre et Grain
de la Tirette



▲Specify Finish / Especificque el Acabado / Précisez le Fini

2564-DST

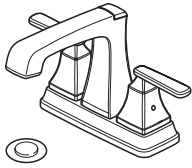

H264▲

RP25620
Set Screw (2)
Tornillo de Ajuste (2)
Vis de Calage (2)

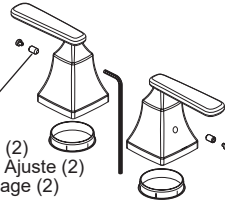

RP83791

Set Screw Covers
(1 Red / 1 Blue / 2 Gray
/ 2 Black)
Tornillo Cubre
(1 Rojo y 1 Azul / 2
Gris / 2 Negro)
vis couvre
(1 Red / 1 Blue / 2
Gray / 2 Noir)

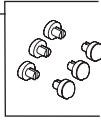

RP90913▲
Lift Rod & Finial
Barra de Alzar y Pomo
Tige de Manoeuvre et
Grain de la Tirette



2592-DST

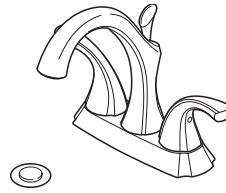

H292▲

RP25620
Set Screw (2)
Tornillo de Ajuste (2)
Vis de Calage (2)

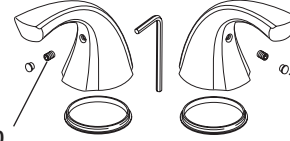

RP78524▲
Button Covers
Cubre botón
Couvre-boutons



2593-DST



H293▲

RP25620
Set Screw (2)
Tornillo de Ajuste (2)
Vis de Calage (2)

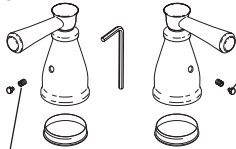

RP84705

Set Screw & Button (2)
(1 Set Screw / 1 Gray /
1 Black)
Botón y Tornillo de
Ajuste (2) (1 Tornillo de
Ajuste / 1 Gris /
1 Negro)
Bouton et Vis de
Calage (2) (1 Vis de
Calage / 1 Gris /
1 Noirs)

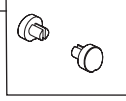

2594-DST



H294▲

RP52658▲
Set Screw & Button (2)
Botón y Tornillo de Ajuste (2)
Bouton et Vis de Calage (2)

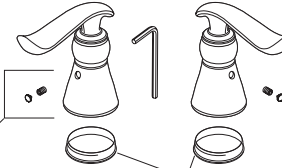

RP41896
Glide Ring
Aro para Deslizar
L'anneau de Glissement

2559-MPU-DST

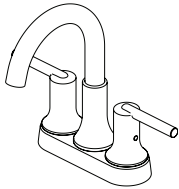

RP101871▲

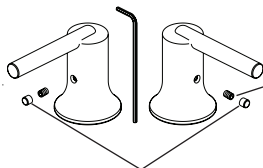

RP25620
Set Screw (2)
Tornillo de Ajuste (2)
Vis de Calage (2)

RP73165
Red & Blue Buttons
Botón rojo y azul
Bouton rouge et bleu

RP50952
Plastic Sleeves
Mangas Plásticas
Manchons en plastique



RP63263
Adapters
3/8"-24 UNEF to 1/2"-20 UN &
3/8"-24 UNEF to 1/2"-14 NPSM

Adaptadors
3/8"-24 UNEF to 1/2"-20 UN &
3/8"-24 UNEF to 1/2"-14 NPSM

Adapteurs
3/8 po-24 UNEF to 1/2 po-20 UN et
3/8 po-24 UNEF to 1/2 po-14 NPSM

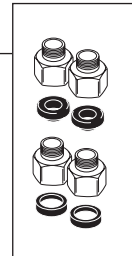

25776-MPU-DST



RP100362▲

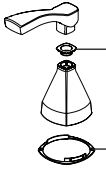

RP100366 - Red/Blue
 RP100367BK - Black
 RP100367GR - Gray
 Glide Rings (2)
 Anillos de deslizamiento (2)
 Anneaux glissants (2)

RP100368BK - Black
 RP100368GR - Gray
 Glide Rings (2)
 Anillos de deslizamiento (2)
 Anneaux glissants (2)

RP100363▲

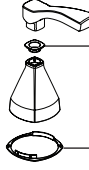

RP100366 - Red/Blue
 RP100367BK - Black
 RP100367GR - Gray
 Glide Rings (2)
 Anillos de deslizamiento (2)
 Anneaux glissants (2)

RP100368BK - Black
 RP100368GR - Gray
 Glide Rings (2)
 Anillos de deslizamiento (2)
 Anneaux glissants (2)

RP100361▲
 Lift Rod & Finial
 Barra de Alzar y Pomo
 Tige de Manoeuvre et
 Grain de la Tirette



257766-MPU-DST

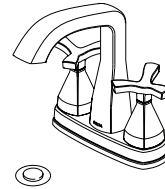

RP100364▲

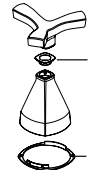

RP100366 - Red/Blue
 RP100367BK - Black
 RP100367GR - Gray
 Glide Rings (2)
 Anillos de deslizamiento (2)
 Anneaux glissants (2)

RP100368BK - Black
 RP100368GR - Gray
 Glide Rings (2)
 Anillos de deslizamiento (2)
 Anneaux glissants (2)

RP100365▲

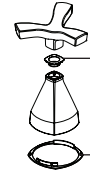

RP100366 - Red/Blue
 RP100367BK - Black
 RP100367GR - Gray
 Glide Rings (2)
 Anillos de deslizamiento (2)
 Anneaux glissants (2)

RP100368BK - Black
 RP100368GR - Gray
 Glide Rings (2)
 Anillos de deslizamiento (2)
 Anneaux glissants (2)

RP100361▲
 Lift Rod & Finial
 Barra de Alzar y Pomo
 Tige de Manoeuvre et
 Grain de la Tirette



25775-MPU-DST



RP100362▲

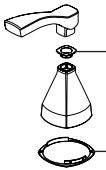

RP100366 - Red/Blue
 RP100367BK - Black
 RP100367GR - Gray
 Glide Rings (2)
 Anillos de deslizamiento (2)
 Anneaux glissants (2)

RP100368BK - Black
 RP100368GR - Gray
 Glide Rings (2)
 Anillos de deslizamiento (2)
 Anneaux glissants (2)

RP100363▲

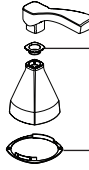

RP100366 - Red/Blue
 RP100367BK - Black
 RP100367GR - Gray
 Glide Rings (2)
 Anillos de deslizamiento (2)
 Anneaux glissants (2)

RP100368BK - Black
 RP100368GR - Gray
 Glide Rings (2)
 Anillos de deslizamiento (2)
 Anneaux glissants (2)

RP100361▲
 Lift Rod & Finial
 Barra de Alzar y Pomo
 Tige de Manoeuvre et
 Grain de la Tirette



257756-MPU-DST

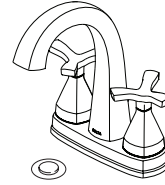

RP100364▲

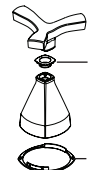

RP100366 - Red/Blue
 RP100367BK - Black
 RP100367GR - Gray
 Glide Rings (2)
 Anillos de deslizamiento (2)
 Anneaux glissants (2)

RP100368BK - Black
 RP100368GR - Gray
 Glide Rings (2)
 Anillos de deslizamiento (2)
 Anneaux glissants (2)

RP100365▲

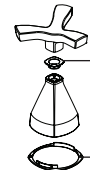

RP100366 - Red/Blue
 RP100367BK - Black
 RP100367GR - Gray
 Glide Rings (2)
 Anillos de deslizamiento (2)
 Anneaux glissants (2)

RP100368BK - Black
 RP100368GR - Gray
 Glide Rings (2)
 Anillos de deslizamiento (2)
 Anneaux glissants (2)

RP100361▲
 Lift Rod & Finial
 Barra de Alzar y Pomo
 Tige de Manoeuvre et
 Grain de la Tirette



RP38958▲

Pop-Up with Metal Flange and Plastic Tail Piece Less Lift Rod

*For Use With Track-Pack Models

Drenaje automático con brida de metal y la pieza de cola plástica menos la barra de alzar

*Para uso con los modelos Track-Pack

Renvoi mécanique avec collerette en métal et raccord droit de vidange en plastique sans la tige de manoeuvre

*Pour utilisation avec les modèles Track-Pack

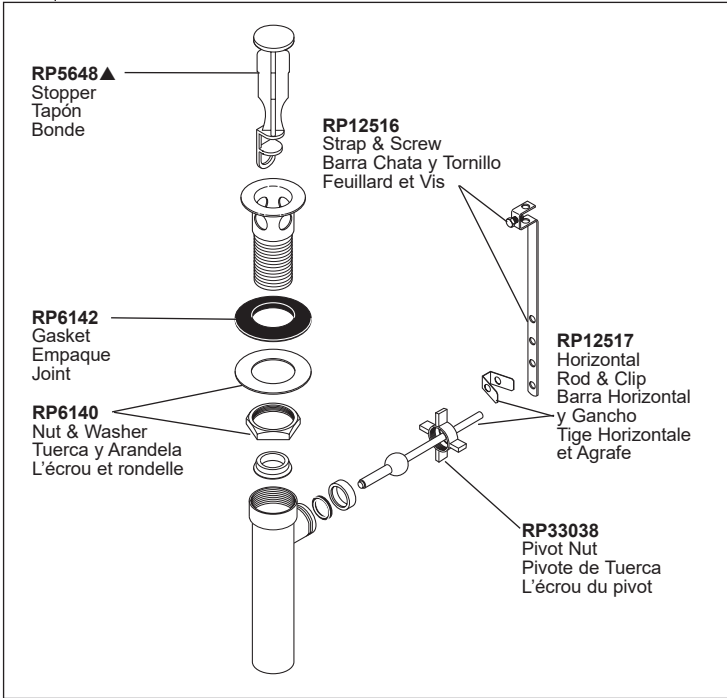

RP26533▲

Metal Pop-Up Assembly Less Lift Rod

Ensamble de Metal del Desagüe Automático Sin la Barra de Alzar

Renvoi Mécanique en Métal Sans la Tige de Manoeuvre

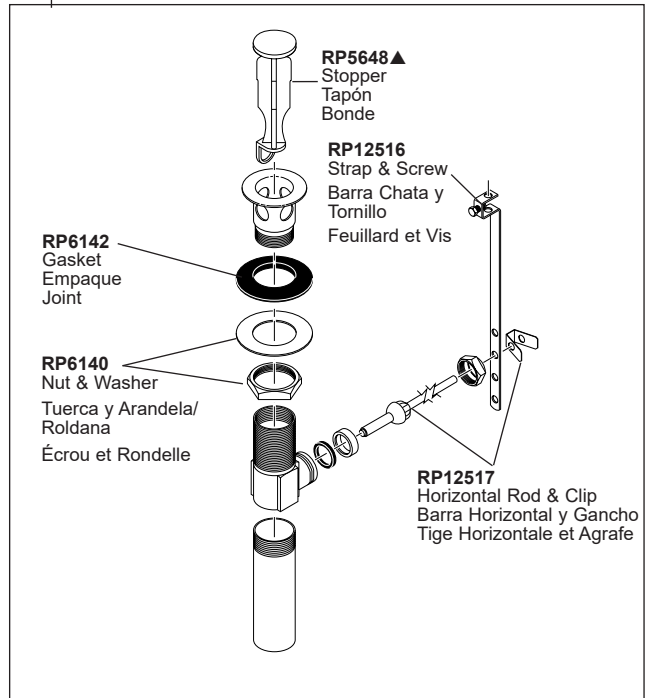

RP101631▲

Push-Up with Plastic Tail Piece

Flexiones con cola de plástico

Push-Up avec queue en plastique

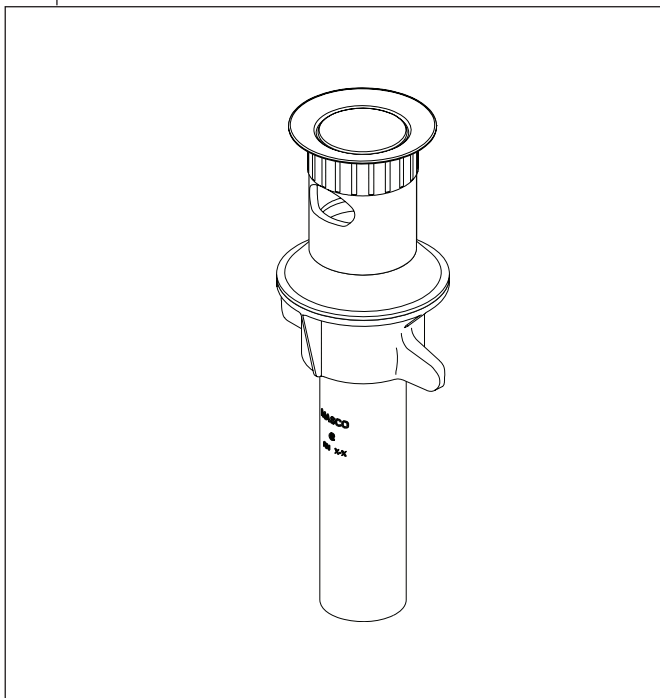

RP101630▲

Push-Up with Metal Tail Piece

Flexiones con cola el metal

Push-Up avec queue le métal

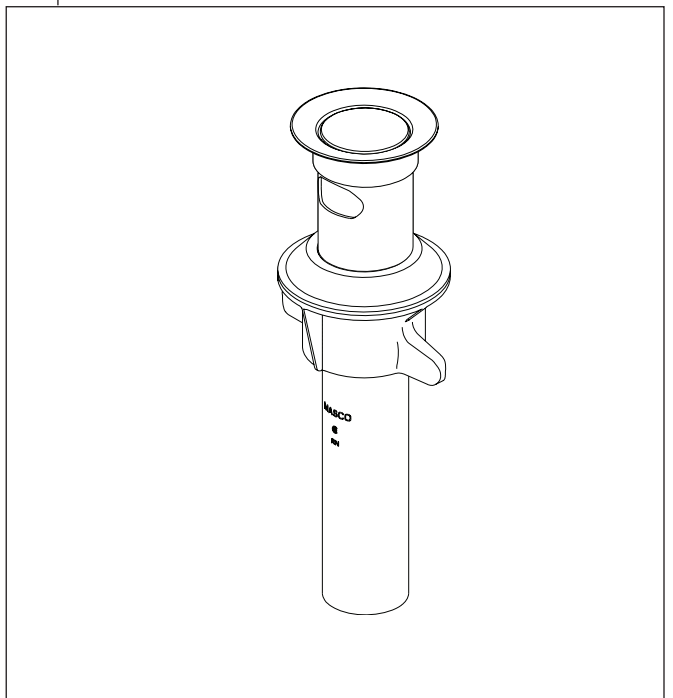

▲Specify Finish / Especificque el Acabado / Précisez le Fini