

Models/Modelos/Modèles
9690-DST & 9690T-DST
 Series/Series/Seria
BRODERICK®

RP100845▲

Escutcheon, Mounting Screws (2), Gasket, Nuts (2) & Washers (2) (not included)
 Chapa, tornillos de montaje (2), empaque, tuercas (2) y arandelas (2) (no se incluyen)
 Plaque de finition, vis de montage (2), joint, écrous (2) et rondelles (2) (non inclus)

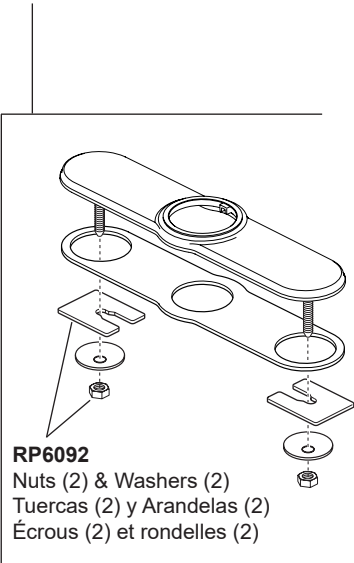

RP6092

Nuts (2) & Washers (2)
 Tuercas (2) y Arandelas (2)
 Écrous (2) et rondelles (2)

RP80523

Hose Weight Assembly
 Ensemble de la Pesa de Acero
 Masselotte en acier

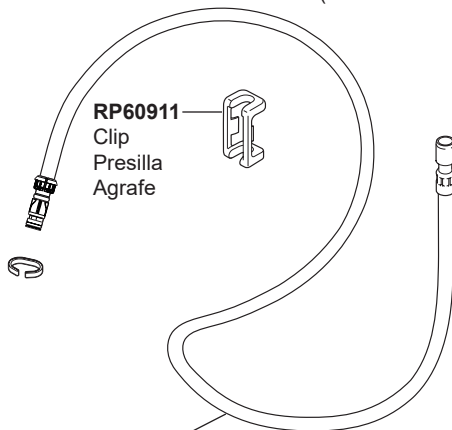

RP90843

Hose Assembly
 Ensemble de la manguera
 Tuyau souple

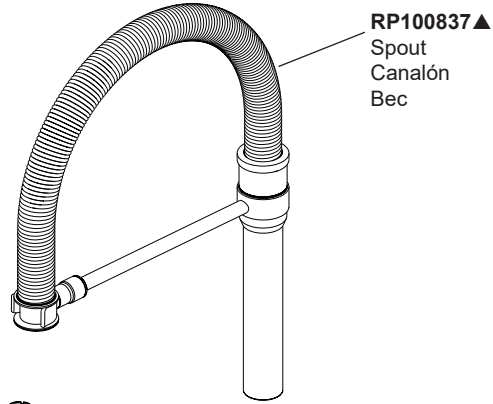

RP100837▲
 Spout
 Canalón
 Bec



RP90234
 Retainer & O-Ring
 Funda y Anillo
 "O"
 Douille et Joint torique

RP100833▲
 Sprayer Assembly
 Ensemble de Rociador
 Pulvérisateur

RP100832
 Gasket
 Empaque
 Joint

RP64075

Indicator Base Assembly
 (9690T-DST only)
 Ensemble de la base con indicador
 (9690T-DST Solamente)
 Base à voyant indicateur
 (9690T-DST Seulement)

RP91902
 Cartridge Assembly
 Ensemble del la Válvula
 Soupape

RP74776
 Bonnet Nut
 Tuerca
 Écrou

RP100836▲
 Cap & O-Ring
 Bonete y Anillo O
 Chapeau et Joint toriques

RP78741
 Contact Spring
 (9690T-DST only)
 Resorte de Contacto
 (9690T-DST Solamente)
 Ressort de contact
 (9690T-DST Seulement)

RP100835▲
 Set Screw & Button
 Tornillo de Ajuste y botón
 Vis de calage et bouton

RP13938
 O-Rings (2)
 Anillos "O" (2)
 Joints torique (2)

RP100834▲
 Handle, Set Screw & Button

Manija, tornillo de presión y Botón
 Poignée, vis de calage et bouton

RP51243

Inlet Gaskets
 Empaques para el tubo de entrada
 Joints côté alimentation

RP92714

Mounting Bracket Assembly, Spacer, Nut & Wrench
 Ensemble del soporte de montaje, Espaciador, la tuerca y la llave de tuercas
 Fixation de montage, spacer, écrou et clé

Models/Modelos/Modèles
9690-DST & 9690T-DST
 Series/Series/Seria
BRODERICK®

EP92546
 Solenoid Assembly
 Ensemble de Solenoïde
 Electrovanne

For PC, SS, CZ, AR & KS finishes, order **EP92546**
 For PL, MW, RB, BL & SP finishes, order **EP92546XX**

Para acabados PC, SS, CZ, AR y KS, ordene **EP92546**
 Para acabados PL, MW, RB, BL y SP, ordene **EP92546XX**

Pour les finis PC, SS, CZ, AR et KS, commandez **EP92546**
 Pour les finis PL, MW, RB, BL, et SP, commandez **EP92546XX**

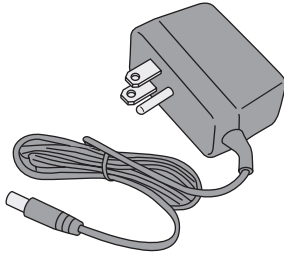

EP102157
 9 Volt Power Supply
 (Accessory Order Only)
 Fuente de alimentación de 9
 voltios
 (Orden de accesorios
 solamente)
 Alimentation électrique 9 volts
 (L'accessoire seulement)

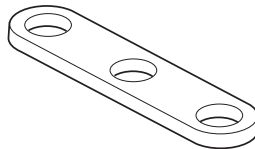

RP37490
 Thin Deck Aid (Not Included)
 Soporte para encimera
 delgada
 (No incluido)
 Plaque de renfort (non incluse)

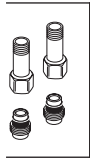
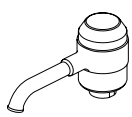

RP53468
 Check Valves
 Válvulas
 Checadoras
 Clapets de non-
 retour



RP50952
 Cut -To - Fit Plastic Sleeves
 Casquillos cortados a la medida
 Bagues d'extrémité pour
 tubes coupés

RP83779
 Pump
 Bomba
 Pompe

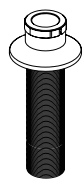

RP100632▲
 Dispenser Assembly
 (Not included)
 Ensemble del Dispensador
 (no se incluyen)
 Distributeur (non inclus)

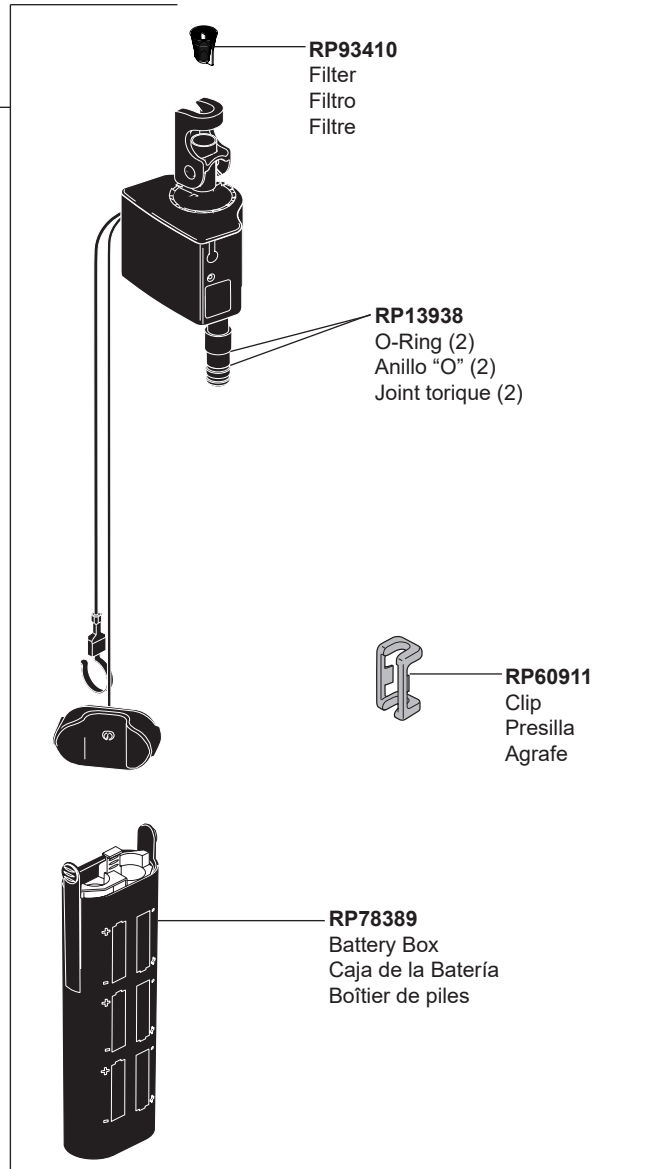
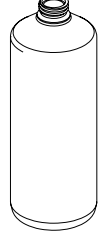

RP93410
 Filter
 Filtro
 Filtre

RP13938
 O-Ring (2)
 Anillo "O" (2)
 Joint torique (2)

RP60911
 Clip
 Presilla
 Agrafe

RP78389
 Battery Box
 Caja de la Batería
 Boîtier de piles

Other useful accessories that may be purchased separately.
 Otros accesorios útiles que se pueden comprar por separado.
 Autres accessoires utiles pouvant être achetés séparément.

RP63263
 Adapters
 3/8"-24 UNEF to 1/2"-20 UN &
 3/8"-24 UNEF to 1/2"-14 NPSM
 Adaptadors
 3/8"-24 UNEF a 1/2"-20 UN &
 3/8"-24 UNEF a 1/2"-14 NPSM
 Adapteurs
 3/8 po-24 UNEF à 1/2 po-20 UN et
 3/8 po-24 UNEF à 1/2 po-14 NPSM

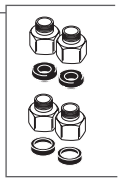

RP63264
 Adapters (10) 3/8"-24 UNEF to 1/2"-20 UN
 Adaptadors (10) 3/8"-24 UNEF a 1/2"-20 UN
 Adapteurs (10) 3/8 po-24 UNEF à 1/2 po-20 UN

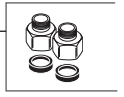

RP63265
 Adapters (10) 3/8"-24 UNEF to 1/2"-14 NPSM
 Adaptadors (10) 3/8"-24 UNEF a 1/2"-14 NPSM
 Adapteurs (10) 3/8 po-24 UNEF à 1/2 po-14 NPSM



▲Specify Finish/Especifique el Acabado/Précisez le Fini