



TRUE BLUE® BATH WASTE FULL KIT WITH FINISHED DRAIN SPUD

Job Name _____	Item # _____
Location _____	
Engineer _____	Contractor _____
PO # _____	Tag _____
Representative _____	

SPECIFICATIONS

The Dearborn True Blue Bath Waste shall be used in commercial and residential applications requiring a bath waste and overflow drain with integrated test features. Overflow and drain elbow components shall come factory preassembled for added convenience. Overflow gasket shall be made of a high memory foamed rubber. Drain gasket shall be notched and undercut in order to wrap around drain elbow and lock into place. This will prevent gasket from being knocked off during installation and remain secured to drain elbow regardless of orientation. Test plugs shall be quarter turn installation and must be removable and reusable. Faceplate installation shall not require additional tools or screws, symmetrical design will eliminate the need for precise alignment.

APPROVALS AND LISTINGS

ASME A112.18.2-2015/CSA B125.2-15



Uniform Plumbing Code (UPC®)



National Plumbing Code of Canada



International Plumbing Code (IPC®)



ASME A112.18.2-2015/CSA B125.2-15

Listed with Massachusetts Board of Plumbing

FEATURES AND MATERIALS

Finish Trim	Tool-Free, Screw-Free Installation
Test Plugs	Reusable, Quarter Turn Tool-Free Installation
Drain Gasket	Locking Rubber Gasket
Overflow Gasket	High Memory Foamed Rubber
Spud	Plated Brass

PERFORMANCE SPECIFICATIONS*

Test Plug Rating	40 FT Head, 17 PSI
Drain Flow Rate	Min. 7 GPM Max. 15.8 GPM depending on finish
Overflow Flow Rate	4.40 GPM

*Contact Technical@Oatey.com for specific flow rates.

DIMENSIONS

[A]:	Drain / Spud Thread	1-1/2"–11-1/2 NPSM
[B]:	Inner Diameter	1-1/2"
[C]:	Overflow Depth	1.236"
[D]:	Overflow Height	14-1/4"

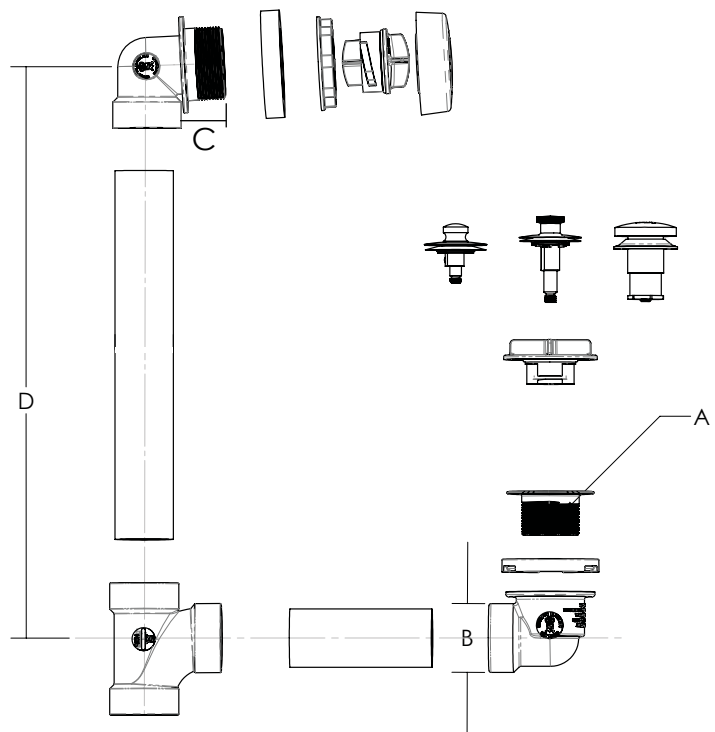

Access BIM/Revit content through www.oatey.com



TRUE BLUE® BATH WASTE FULL KIT WITH FINISHED DRAIN SPUD

PRODUCT SELECTOR

TRUE BLUE® BATH WASTE FULL KIT WITH FINISHED DRAIN SPUD						
✓	Product Number	Material	Stopper Style	Finish	Drain Spud Material	Test Plugs Included
	A9840CP	ABS	PUSH N' PULL	CHROME	BRASS	YES
	A9840BNPS	ABS	PUSH N' PULL	BRUSHED NICKEL	BRASS	YES
	A9840RBPS	ABS	PUSH N' PULL	OIL RUBBED BRONZE	BRASS	YES
	A9850CP	ABS	TOUCH TOE	CHROME	BRASS	YES
	A9850BNPS	ABS	TOUCH TOE	BRUSHED NICKEL	BRASS	YES
	A9850RBPS	ABS	TOUCH TOE	OIL RUBBED BRONZE	BRASS	YES
	A9860CP	ABS	UNI-LIFT	CHROME	BRASS	YES
	A9860BNPS	ABS	UNI-LIFT	BRUSHED NICKEL	BRASS	YES
	A9860RBPS	ABS	UNI-LIFT	OIL RUBBED BRONZE	BRASS	YES
	P9840CP	PVC	PUSH N' PULL	CHROME	BRASS	YES
	P9840BNPS	PVC	PUSH N' PULL	BRUSHED NICKEL	BRASS	YES
	P9840RBPS	PVC	PUSH N' PULL	OIL RUBBED BRONZE	BRASS	YES
	P9850CP	PVC	TOUCH TOE	CHROME	BRASS	YES
	P9850BNPS	PVC	TOUCH TOE	BRUSHED NICKEL	BRASS	YES
	P9850RBPS	PVC	TOUCH TOE	OIL RUBBED BRONZE	BRASS	YES
	P9860CP	PVC	UNI-LIFT	CHROME	BRASS	YES
	P9860BNPS	PVC	UNI-LIFT	BRUSHED NICKEL	BRASS	YES
	P9860RBPS	PVC	UNI-LIFT	OIL RUBBED BRONZE	BRASS	YES

TRUE BLUE® BATH WASTE TRIM KIT WITH FINISHED DRAIN SPUD						
✓	Product Number	Material	Stopper Style	Finish	Drain Spud Material	Test Plugs Included
	K97BNPS	N/A	TOUCH TOE	BRUSHED NICKEL	BRASS	NO
	K97RBPS	N/A	TOUCH TOE	OIL RUBBED BRONZE	BRASS	NO
	K97WHPS	N/A	TOUCH TOE	WHITE	BRASS	NO
	K97MBPS	N/A	TOUCH TOE	MATTE BLACK	BRASS	NO
	K98BNPS	N/A	UNI-LIFT	BRUSHED NICKEL	BRASS	NO
	K98RBPS	N/A	UNI-LIFT	OIL RUBBED BRONZE	BRASS	NO
	K98WHPS	N/A	UNI-LIFT	WHITE	BRASS	NO
	K98MBPS	N/A	UNI-LIFT	MATTE BLACK	BRASS	NO
	K99BNPS	N/A	PUSH N' PULL	BRUSHED NICKEL	BRASS	NO
	K99RBPS	N/A	PUSH N' PULL	OIL RUBBED BRONZE	BRASS	NO
	K99WHPS	N/A	PUSH N' PULL	WHITE	BRASS	NO
	K99MBPS	N/A	PUSH N' PULL	MATTE BLACK	BRASS	NO